

SIMONIZ [®] MD

S1700 P R E S S U R E W A S H E R

Instruction Manual



39-8673-0

If you have any questions or comments,
please call our toll free hotline

1-866-4SIMONIZ (1-866-474-6664)

PLEASE KEEP THE ORIGINAL BOX, PACKAGING AND RECEIPT.

BEFORE OPERATING THIS UNIT, PLEASE READ THIS MANUAL THOROUGHLY AND
RETAIN IT FOR FUTURE REFERENCE.

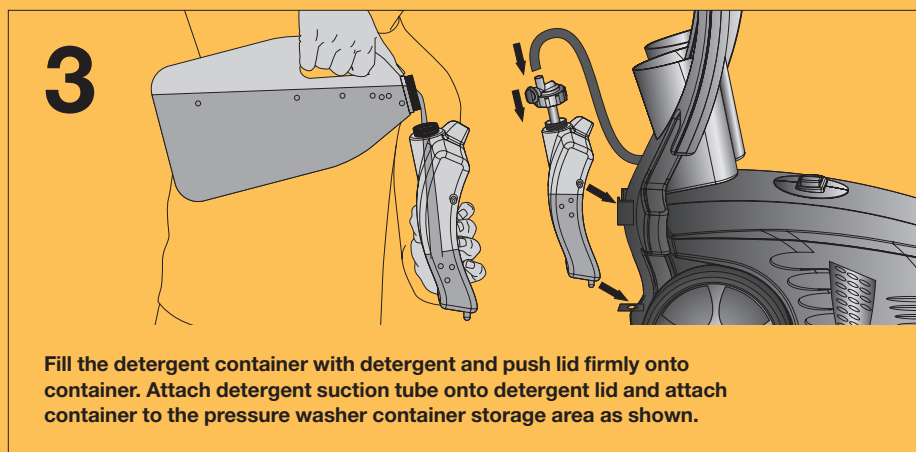
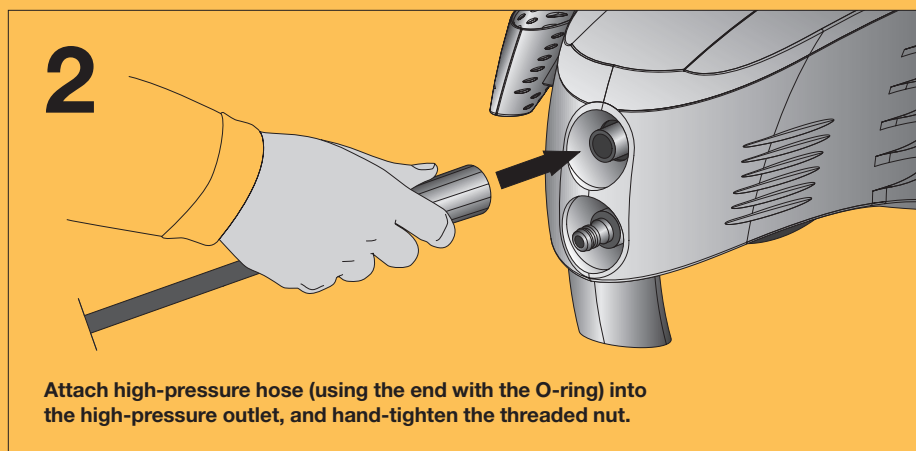
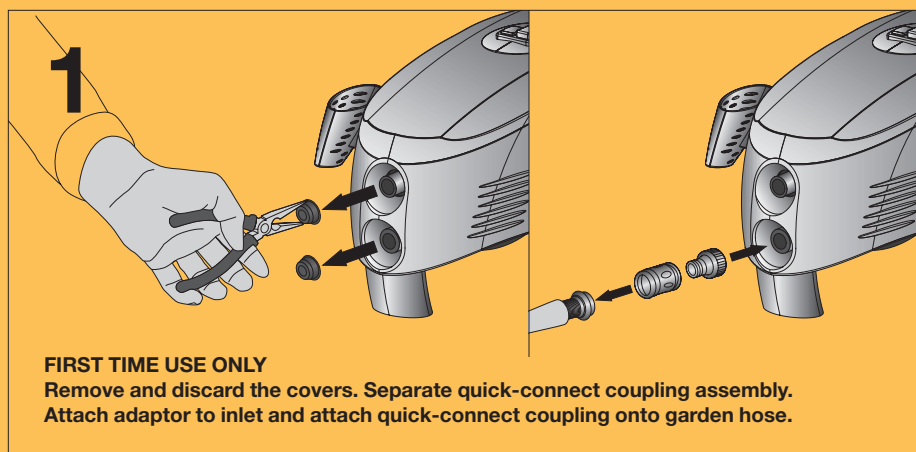

4

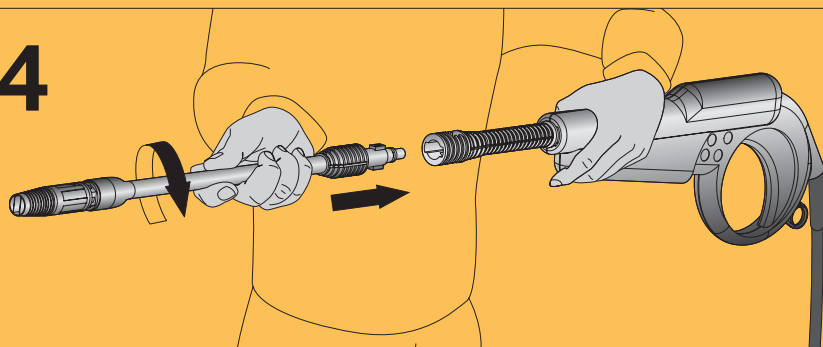

Insert the desired wand with nozzle into spray gun, and twist 1/4 turn until rectangular tab appears.

5

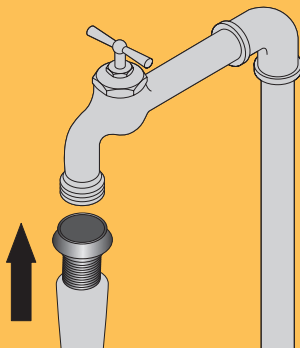

Attach garden hose to water supply and turn water on.

6

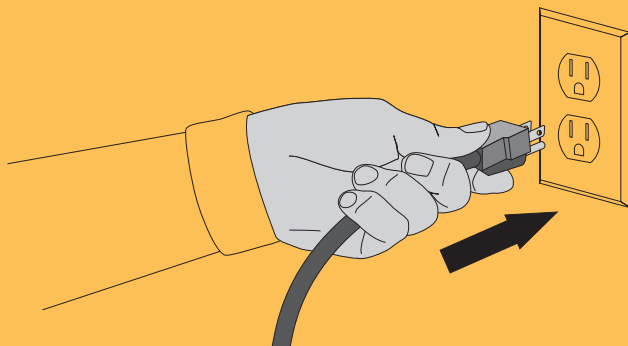

Plug the unit into a properly grounded outlet.

7

Release safety trigger, if locked.

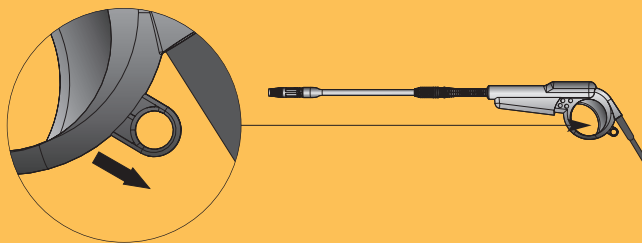

8

Purge air by squeezing trigger on the gun until there is a steady stream of water.

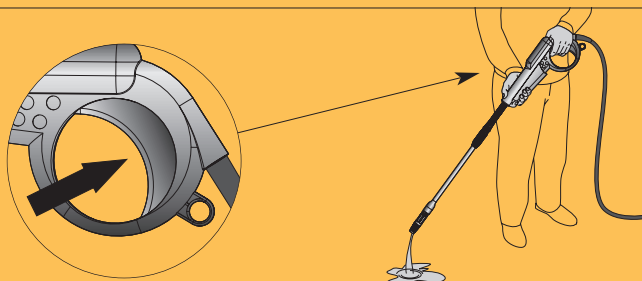

9

OFF (O)

ON (I)

Squeeze trigger and press ON (I) Button.

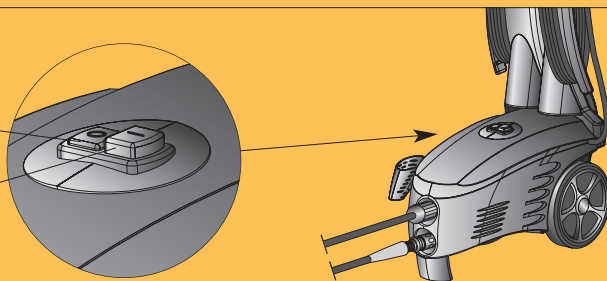

NEVER!

- Never** point nozzle at people or animals.
- Never** drink alcohol or use drugs while operating this equipment.
- Never** operate while standing in water.
- Never** touch plug with wet hands.
- Never** let electrical connections rest in water.
- Never** operate pressure washer without the water turned on.
- Never** use hot water.

SEE PAGE 16 FOR WINTERIZING PROCEDURE.

CAREFULLY READ THIS INSTRUCTION MANUAL BEFORE STARTING UP
THE WASHER FOR THE FIRST TIME. QUESTIONS? CALL 1-866-4SIMONIZ (1-866-474-6664)

TABLE OF CONTENTS

Easy Assembly	1
Warranty	4
Precautions	5
Safety Features and Electrical Power Information	6
Parts Diagram and List	7
Assembly and Operating Instructions	8
Using the Accessories	11
Working with Detergents	13
Shut Down and Clean-up	15
Taking a Break	15
Winterizing and Long-term Storage	16
Maintaining Your Pressure Washer	17
Tips On Cleaning with your Pressure Washer	18
Technical Data	20
Troubleshooting	21

WARRANTY

Product Warranty

Always keep your receipt as proof of purchase. We're here to help! If you have any questions or comments, call our toll free hotline 1-866-4SIMONIZ (1-866-474-6664). Have your serial number ready. The serial number can be found on the back plate, located on the rear of the unit.

This pressure washer has a Parts Replacement, Product Exchange and/or Repair Warranty only. NO REFUNDS will be provided.

14-day Exchange Policy

If a defect should appear within 14-days of purchase, you may return the unit with your receipt as proof of purchase to the place of purchase for an exchange of either a new, or refurbished unit (at Trileaf Distribution's discretion). This product warranty is for Parts Replacement, Product Exchange, and/or Repair only. **There will be no refunds provided.** Please note that after 14-days, no exchanges will be accepted without prior authorization from our customer service department.

2-year Warranty – Motor

This product is warranted to be free from defects in material and workmanship for **two years** from the date of its original purchase. If such a defect appears during the warranty period, upon presentation of proof of purchase, Trileaf Distribution will repair or replace (at its option). Shipping charges may apply.

3-month Warranty – Accessories

Trigger gun, hose, spray wands and other accessories are warranted for **3 months** from date of purchase. You may purchase accessories directly through place of purchase, or by calling.

This warranty does **not** cover accidental damage, unreasonable use, normal wear and tear, use of improper detergents, freezing, neglect, or non-compliance with Operation Instructions. Warranty does not cover loss of use, or other consequential damages arising from any of the above, nor does it cover repairs made or attempted by unauthorized persons.

Warranty is void if the equipment is used for commercial, rental or industrial purposes.

For more questions, please call 1-866-4SIMONIZ (1-866-474-6664).

⚠ Safety Warnings ⚠

When using this product, basic precautions should always be followed:

- **Read all the instructions before using the product.**
- High-pressure jets can be dangerous if subject to misuse. The jet must not be directed at persons or animals.
- Water spray must never be directed towards any electric wiring, devices or directly towards the pressure washer machine itself or fatal electric shock may occur.
- To reduce the risk of injury, **do not** operate the machine near children.
- Learn how to stop the machine and release pressure quickly. Be thoroughly familiar with the controls.
- Stay alert—watch what you are doing.
- Wear safety goggles.
- For use with cold water supply only. **Do not** draw other liquids.
- **Do not** use acids, solvents, or any other flammable material in this product. These products can cause physical injuries to the operator and irreversible damage to the machine.
- To reduce the risk of electrocution, keep all connections dry and off the ground. **Do not** touch plug with wet hands.
- The pressure washer should not be used in areas where gas vapours may be present. An electric spark could cause an explosion or fire.
- To minimize the amount of water getting into the pressure washer, the unit should be placed as far as possible from the cleaning site during operation.
- Avoid accidental starts. Shut power “OFF” before connecting or disconnecting cord to electrical outlets.
- **Do not** operate the product when fatigued or under the influence of alcohol or drugs.
- **Do not** stand on unstable surfaces. Stand with both feet balanced at all times.
- Prior to starting the pressure washer in cold weather, be sure ice has not formed in any part of the equipment.
- Never carry your pressure washer by the cord. **Do not** pull on the cord to disconnect from the outlet.
- To allow free air circulation, the pressure washer should **not** be covered during operation.
- The Trigger Gun Safety Lock **prevents** the trigger from accidentally being engaged. This safety feature **does not** lock trigger in the “ON” position.

⚠ Warning ⚠

- **Do not use with flammable liquids and toxic chemicals.**
- **Injection Hazard:** Equipment can cause serious injury if the spray penetrates the skin. **Do not point the gun at anyone or any part of the body. In case of penetration seek medical aid immediately.**
- **This system is capable of producing 1700 PSI. To avoid rupture and injury, do not operate this pump with components rated less than 1700 PSI working pressure (including but not limited to spray guns, hose and hose connections).**
- **Before servicing, cleaning or removal of any parts, shut “OFF” power and relieve pressure.**
- **Do not spray electrical apparatus and wiring.**
- **If connection is made to a portable water system, the system shall be protected against backflow.**

The pressure washer is equipped with a stop device that will sense when the trigger on the gun is released. It will open the power circuit to the motor and cause the pressure washer motor to stop. Motor will resume again when trigger is pulled.

⚠ Warning ⚠

The pressure washer is also equipped with a main power “ON/OFF” switch located on the unit. It should always be moved to the “OFF” position when the pressure washer is not being used to prevent possible injury or damage.

Motor Overload

The electric motor in this pressure washer is equipped with an overload protection device which will automatically shut “OFF” the motor in the event the motor draws excessive current or overheats. The device will automatically reset itself and resume normal operation after a short period of time.

Grounding Instructions

This product must be grounded. If it should malfunction or breakdown, grounding provides a path of least resistance for electric current to reduce the risk of electric shock. This product is equipped with a cord having an equipment grounding conductor and a grounding plug. The plug must be plugged into an appropriate outlet that is properly installed and grounded in accordance with all local codes and ordinances.

⚠ Danger ⚠

Improper connection of the equipment-grounding conductor can result in a risk of electrocution. Check with a qualified electrician or service personnel if you are in doubt as to whether the outlet is properly grounded. **Do not** modify the plug provided with the product—If it will not fit the outlet, have a proper outlet installed by a qualified electrician. **Do not** use any type of adaptor with this product.

Extension Cords

If possible, do not use extension cords with this product. However, if you must use one, observe all the warnings and instructions listed below:

⚠ Warning ⚠

Extension cords are not recommended unless they are plugged into a ground-fault circuit-interrupter found in circuit boxes or protected receptacles.

Use a sufficient gauge:

Maximum cable length: 50' = 14 AWG

- Use only 3-wire extension cords that have 3-prong grounding-type plugs and 3-pole cord connectors that accept the plug from the product.
- Use only extension cords that are intended for outdoor use. These extension cords are identified by a marking “Acceptable for use with outdoor appliances; store indoors while not in use.”
- Use only extension cords having an electrical rating not less than the rating of the product.
- **Do not** use damaged extension cords. Examine extension cord before using and replace if damaged. **Do not** abuse extension cord and **do not** yank on any cord to disconnect.
- Keep cord away from heat and sharp edges.
- Always disconnect the extension cord from the receptacle before disconnecting the product from the extension cord.
- To reduce the risk of electrocution, keep all connections dry and off the ground. **Do not** touch plug with wet hands.

⚠ Caution ⚠

- **Follow the maintenance instructions specified in the manual.**
- **This machine has been designed for use with cleaning detergent supplied or recommended by the Manufacturer. The use of other cleaning detergents may affect the operation of the machine and void the warranty.**

PARTS DIAGRAM AND LIST



Parts List

Item no.	Quantity	Part Name	Parts No.
1	1	Up-handle assembly	MH02-002-0000
2	1	Gun holder	MH02-000-0004
3	3	Screw	MH02-000-0006
4	1	Detergent suction tube	MH02-022-0014
5	1	Detergent lid	MH02-051-0000
6	1	Inner detergent tube	MH02-050-0001
7	1	Detergent bottle	MH02-050-0003
8	1	Gun holster	MH02-000-0019
9	1	Quick-connect coupling	MH02-020-0027

Item no.	Quantity	Part Name	Parts No.
10	1	Inlet adaptor	MH02-020-0026
11	1	Inlet cover (discarded)	
12	1	Water filter	MH02-020-0009
13	1	Outlet cover (discarded)	
14	3	Nuts	MH02-000-0009
15	1	Turbo wand	MH02-000-0008
16	1	Adjustable wand	MH02-000-0007
17	1	Pressure hose	MH02-000-0003
18	1	Gun assembly	MH02-061-0000

⚠ Caution ⚠

- Never use the pressure washer to draw in water contaminated with solvents (e.g. paint thinners, gasoline, oil, etc.).
- Dirt in the feed water will damage the unit. To avoid this risk, we recommend checking the water filter (located inside the water inlet; to clean it out see Maintenance section).
- Always prevent debris from being drawn into the unit by using a clean water source and an accessory water filter if required.

Water Supply (Cold Water Only)

- Do not draw non-water liquids through the unit. For use with cold water supply **only**.
- Water hose must be at least a 1/2" in diameter.
- Flow rate of water supply must not fall below 2 GPM (gallons per minute).
- Flow rate can be determined by running the water for one minute into an empty 5-gallon container.
- The water supply temperature must not exceed 40°C (104°F).

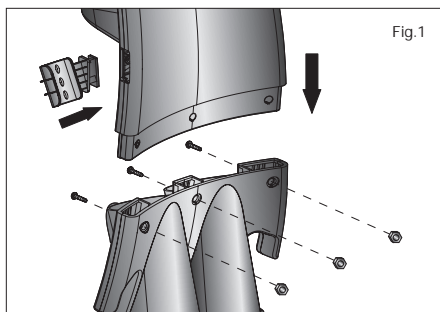

Step 1

Insert handle frame into pressure washer and align holes. Insert three nuts into the front, and screws from behind as shown in Fig.1. Tighten screws.

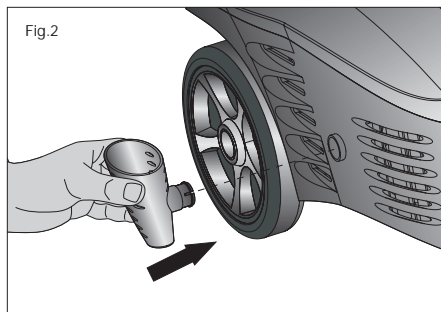

Step 2

Assemble the gun supporter.

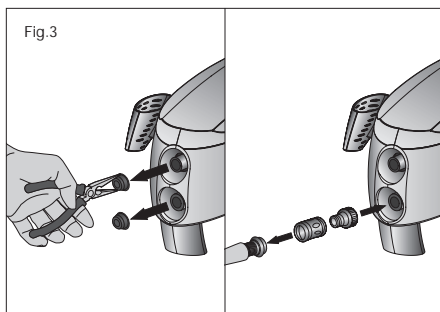

Step 3 (First time use only)

Remove and discard the covers. Separate quick-connect coupler assembly. Attach quick-connect to inlet and attach coupler onto garden hose.

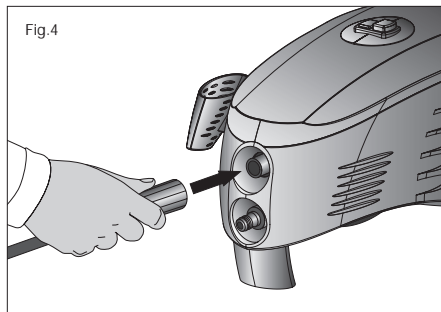

Step 4

Attach high-pressure hose (using the end with the O-ring) into the high-pressure outlet, and hand-tighten the threaded nut.

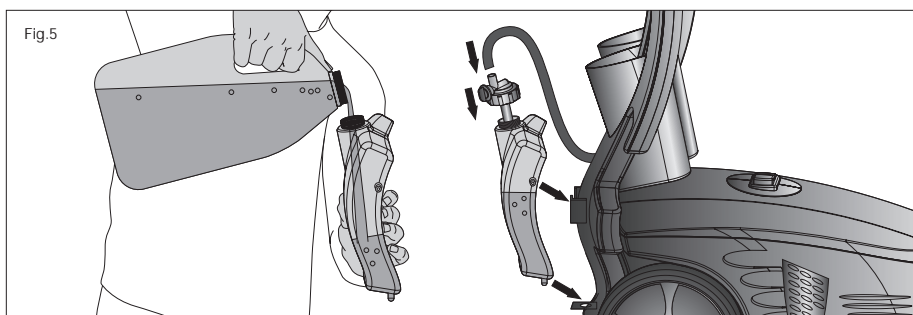

Step 5 (When using detergent)

Fill the detergent container with detergent and push lid firmly onto container. Attach detergent suction tube onto detergent lid and attach container to the pressure washer container storage area as shown.

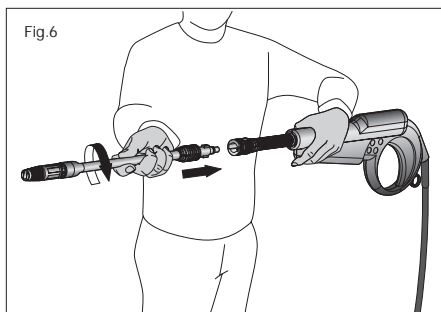

Step 6

Insert the desired wand with nozzle into spray gun, and twist 1/4 turn until rectangular tab appears.

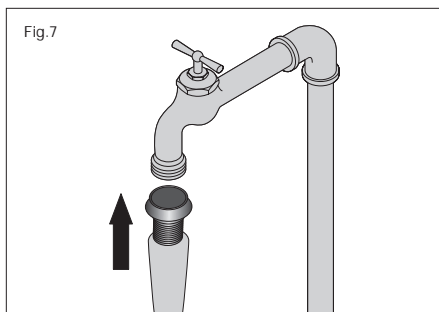

Step 7

Attach garden hose to water supply and turn water on.

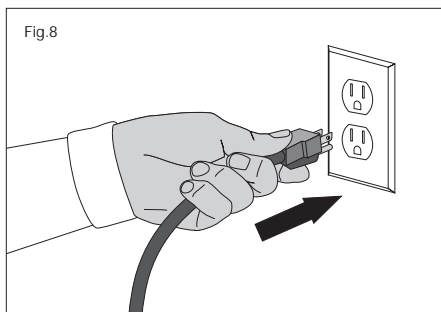

Step 8

Make sure the main switch is in "OFF" position. Plug the unit into a properly grounded outlet.

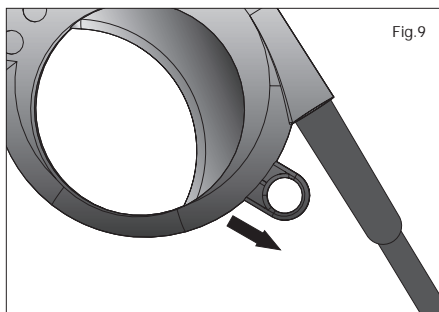

Step 9

Release safety trigger, if locked.

Fig.10

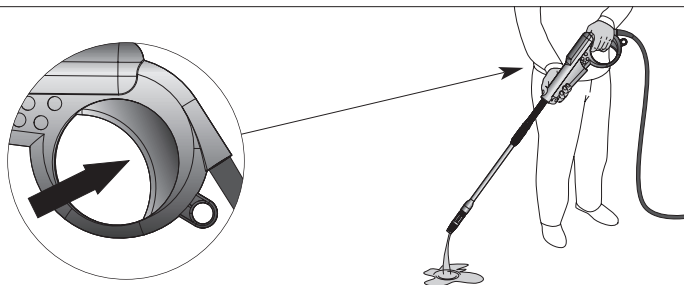

Step 10

Purge air by squeezing trigger on the gun until there is a steady stream of water.

Fig.11

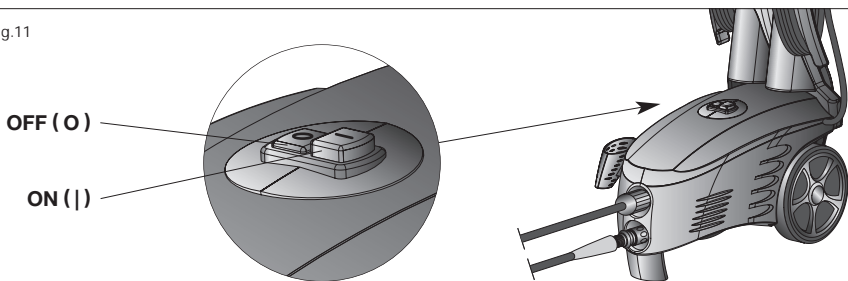

Step 11

Press ON (I) Button.

Surface Preparation

Before starting any cleaning task it is important to inspect the area for objects which could create a hazard. Remove objects from the work area which could be tripped over, such as toys or outdoor furniture. Ensure that all doors and windows are closed tight.

Adjustable Wand

The adjustable wand controls high-pressure/low-pressure and adjusts the spray.

⚠ Caution ⚠

Do not adjust the nozzle while the trigger is squeezed.

Fig.12

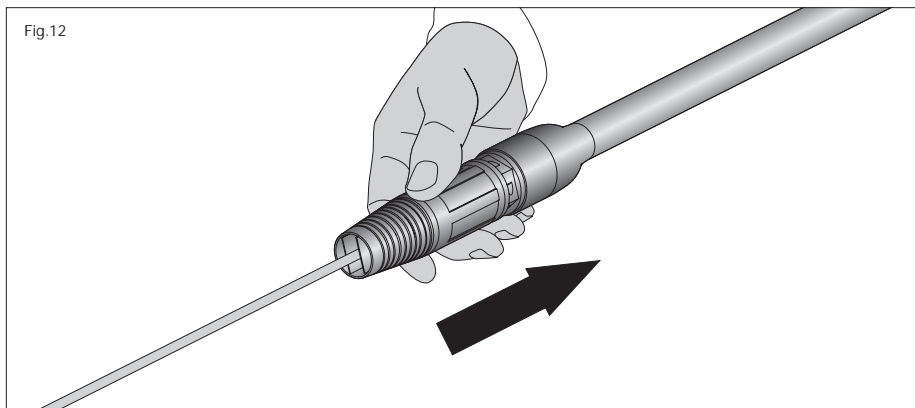
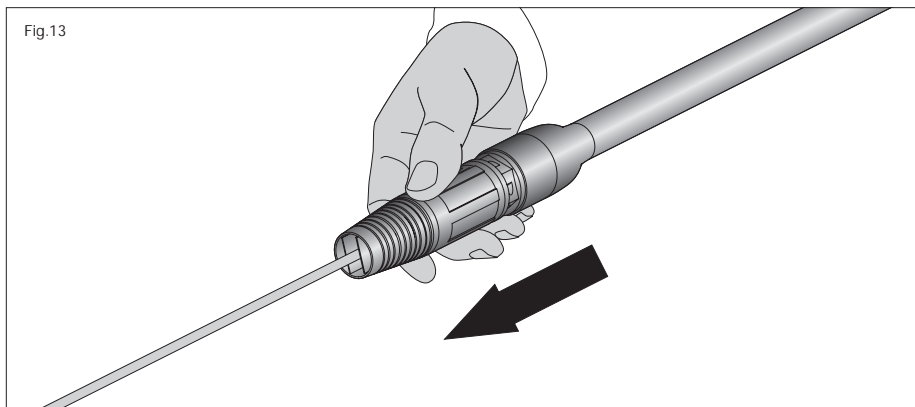

Fig.13



High-pressure/Low-pressure

The **high-pressure** nozzle position is intended for cleaning. To get the high-pressure setting, grasp collar and slide the collar nozzle towards the gun as shown in Fig.12. Make sure the collar is pulled completely back to lock the nozzle into the high-pressure position.

For **low-pressure**, grasp the collar and slide it away from the gun as shown in Fig.13. To apply detergent, the adjustable nozzle must be on the low-pressure setting.

Fig.14

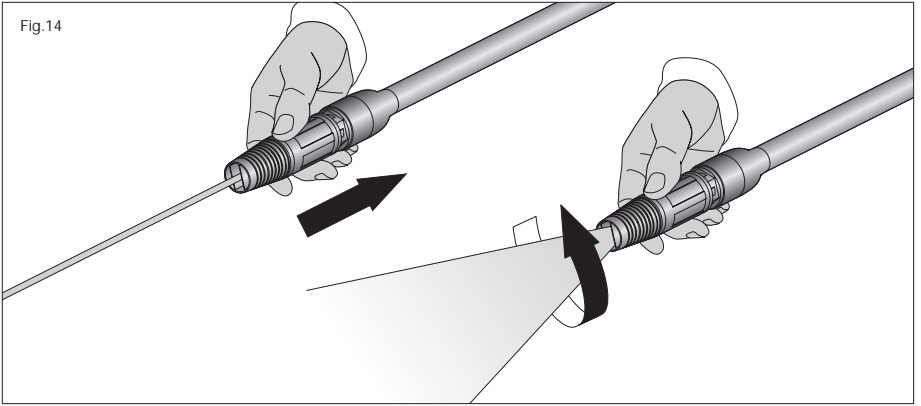

Adjusting The Spray

The adjustable spray nozzle can adjust from fan to jet in the high-pressure position only. The spray is adjusted from jet spray to fan spray by turning the nozzle as shown in Fig.14.

Note: The pressure of the spray on the surface you are cleaning increases as you move the wand closer to the surface.

⚠ Caution ⚠

Jet spray adjustment is very aggressive. Do not adjust while spraying. We recommend that for most cleaning applications a 20° spray angle should be used to avoid damage to the surface being sprayed.

Fig.15

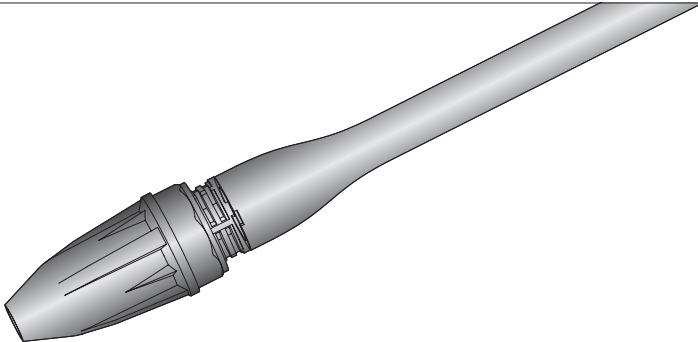

Turbo Power Wand

The high-pressure turbo nozzle (Fig.15) is intended for maximum cleaning effect. Keep the spray wand 6–8" away from the cleaning surface at all times.

⚠ Caution ⚠

Do not try to adjust the turbo nozzle.

WORKING WITH DETERGENTS

Working with detergent ensures a quick soaking of the dirt, and allows the high-pressure water to penetrate and remove the dirt more effectively. Always spray detergent on a dry surface, **do not** pre-soak area. Wetting the surface first dilutes the detergent and reduces its cleaning ability.

To apply detergents you must be operating at low-pressure. This provides a gentle application of detergent, with the pressure equivalent to a low-set garden hose. The high-pressure setting is used for cleaning; you cannot apply detergents when working at high-pressure. Always test detergent in an inconspicuous area before use.

⚠ Caution ⚠

Only use cleaning detergents recommended for this pressure washer.

Fig.16

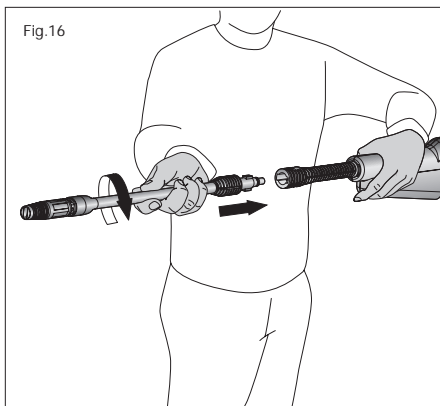

Step 1

Install the adjustable wand. Set the adjustable nozzle to the low-pressure setting by sliding the nozzle collar out. The nozzle must be set in the low-pressure position to apply detergents.

Fig.17

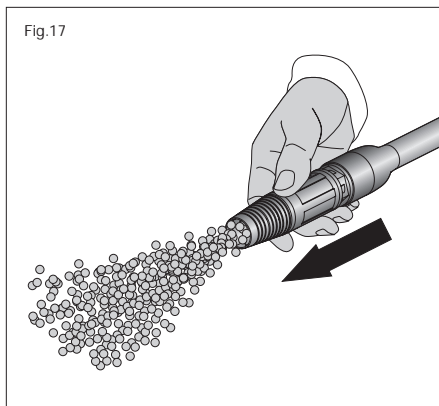

Step 2

Attach **detergent suction tube** onto **detergent lid**. Fill the detergent bottle with detergent. Screw the lid onto the detergent bottle and attach bottle to the pressure washer (Fig.17). **Note:** You can adjust amount of detergent by moving the detergent lid tab between – and +.

Step 3

Turn on the pressure washer. Pull trigger to operate unit. The liquid detergent will automatically mix with water and be discharged through nozzle. Apply detergent to a DRY work surface, from bottom to top.

Step 5

Rinse with clean water under high-pressure. On a vertical surface, rinse from the bottom up, then rinse from the top down to avoid streaking. Hold nozzle 6–8" from the work surface at a 45° angle.

Step 4

Allow detergent to remain on the surface for a short time before rinsing. **Do not** allow detergent to dry on surface.

⚠ Caution ⚠

Damage may occur to painted surface if chemical is allowed to dry on surface. Wash and rinse a small section at a time. Avoid working on hot surfaces or in direct sunlight.

Step 6 (End of detergent application)

When you have finished using the detergent injection system, remove detergent suction tube from bottle and insert into 1 gallon (5 L) of fresh water. Siphon water at low-pressure for one minute so that all detergent is flushed through system. Remove detergent bottle and rinse it until it is thoroughly cleaned.

⚠ Caution ⚠

Failure to clean properly will cause the injection system to become clogged and inoperable.

⚠ Caution ⚠**Never use:**

- Bleach, chlorine products and other corrosive chemicals
- Liquids containing solvents (i.e., paint thinners, gasoline, oils)
- Tri-sodium phosphate products
- Ammonia products
- Acid-based products

These chemicals will harm the unit and will damage the surface being cleaned.

SHUTTING DOWN AND CLEANING UP

Step 1

End of detergent application. (If you are not using detergent, go directly to Step 2.)

When you have finished using the detergent injection system, remove detergent suction tube from bottle and insert into 1 gallon (5 L) of fresh water. Siphon water at low-pressure for one minute so that all detergent is flushed through system. Remove detergent bottle and rinse it until it is thoroughly cleaned.

Step 2

Turn the switch to "OFF" (O) position and unplug cord from outlet.

Step 3

Unplug the power cord from the outlet.

Step 4

Press trigger to release water pressure.

Warning

Turn off water supply and squeeze trigger to depressurize the unit. Failure to do so could result in personal injury due to discharge of high-pressure water.

Step 5

Disconnect the garden hose from the water inlet on the unit.

Step 6

Disconnect the high-pressure hose from the high-pressure outlet and engage the gun safety lock.

Step 7

Wind high-pressure hose and electrical cord around the handle as shown.

TAKING A BREAK

If taking a break of five minutes or more:

Step 1

Engage gun safety lock.

Step 2

Turn pressure washer to "OFF" (O) position.

Step 3

Unplug the power cord from the outlet.

Optimum Winterizing Procedure

Winterizing your pressure washer will help protect and prolong its life. We strongly recommend you follow the below steps using antifreeze. Prepare the pressure washer for storage by running a 50/50 mix of water and antifreeze into the unit. This will keep the internal parts lubricated, protected from rust, and prevents the pump from freezing.

1. Connect the antifreeze hose onto the adaptor and quick-connect coupling.
2. Depress button on top of antifreeze container.
3. Continue until fluid exits the pump outlet.
4. Remove the hose from pump inlet.

Use Simoniz® Pressure Washer Antifreeze (39-8602-0).

Quick Winterizing Procedure

If you cannot do the Optimum Winterizing procedure, you can still protect your pressure washer from winter-damage by doing below:

1. Disconnect all water connections.
2. Turn on the machine for a few seconds, until the remaining water in the pump exits. Turn off immediately.
3. **Do not** allow high-pressure hose to become kinked.
4. Store the machine and accessories in a room that does not reach freezing temperatures.
Do not store near furnace or other sources of heat as it may dry out the pump seals.

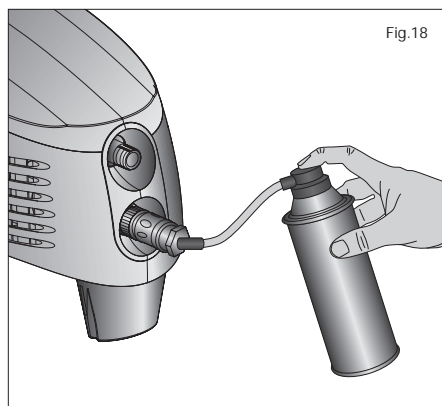

Connections

Connections on pressure washer hoses; gun and spray wand should be cleaned regularly and lubricated with non-water soluble grease.

Fig.19

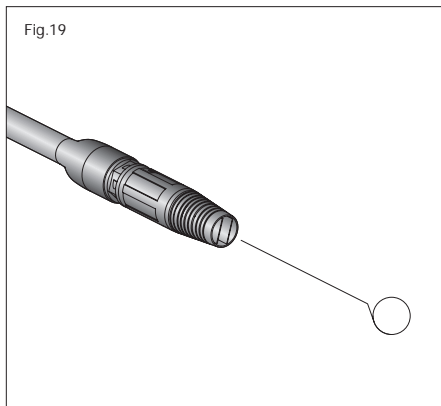

Adjustable Nozzle Only

Clogging of the nozzle causes the pump pressure to be too high and cleaning is immediately required. You can clean the nozzle by carefully inserting a thin, sharp instrument (i.e. paperclip) into the tip to rid it of deposits (see Fig.19).

For the adjustable nozzle, you can also lubricate the nozzle collar (high-pressure/low-pressure) by using non-water soluble grease regularly.

Lubrication

The pressure washer is designed with a permanent lubrication system. Oil checks and oil changes are not necessary. A small amount of oil leakage is normal.

Note: In case of oil leakage, contact the Simoniz® Customer Service Department at 1-866-4SIMONIZ (1-866-474-6664).

Fig.20

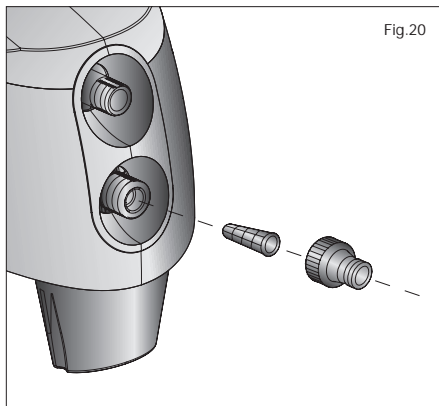

Water Filter Screen

The pressure washer is equipped with a water inlet screen to protect the pump. **If the screen is not kept clean, the flow of water to the pressure washer will be restricted and the pump may be damaged.**

1. To clean inner water screen, remove quick-connector and remove the filter screen from the pump inlet (Fig.20).
2. Rinse screen until it is free of debris and blockage.
3. Replace screen and quick-connector immediately to prevent any foreign matter from entering the pump.

Air Vents

The air vents located on the sides of the pressure washer must be kept clean and free of any obstructions to ensure proper air-cooling of the motor during operation.

Recommendations

- Before cleaning any surface, an inconspicuous area should be cleaned to test spray pattern and distance for maximum cleaning results.
- Take care when using high-pressure setting as it can potentially damage the finish or paint.
- If painted surfaces are peeling or chipping, use extreme caution as pressure washer may remove the loose paint from the surface.
- The best angle for spraying high-pressure water against a cleaning surface is 45°. Spraying directly head-on tends to cause dirt particles to embed in the surface.

Deck Cleaning

With Detergent: Fill detergent bottle with Deck/Fence Cleaner (39-4577-4). Place detergent suction tube directly into cleaning solution and apply to surface at low-pressure. For best results, limit your work area to smaller sections of approximately 25 sq.ft. Allow Deck Wash to remain on surface 1 to 3 minutes. **Do not** allow detergent to dry on surface. Rinse at high-pressure in a long sweeping motion keeping the spray nozzle approximately 6" from the cleaning surface. Always clean from top to bottom and from left to right. When moving on to a new section of the cleaning surface, be sure to overlap the previous section to eliminate stop marks and ensure a more even cleaning result.

Without Detergent: Pre-rinse cleaning surface with fresh water and wash with water on high-pressure using same directions as above.

House Siding

With Detergent: Fill detergent bottle with House/Siding Cleaner (39-4576-6). Place detergent suction tube directly into cleaning solution and apply to surface at low pressure (for best results, limit your work area to sections of approximately 6' and always apply detergent from bottom to top). Allow detergent to remain on surface 1–3 minutes. **Do not** allow detergent to dry on surface, if surface appears to be drying, simply wet down surface with fresh water. Rinse at high-pressure from bottom to top, then top to bottom in an even sweeping motion keeping the spray nozzle approximately 6" from the cleaning surface.

Without Detergent: Pre-rinse cleaning surface with fresh water and wash with water on high-pressure using same directions as above.

Cement Patios, Brick & Stone

With Detergent: Fill detergent bottle with Heavy-duty Degreaser (39-4578-2). Place detergent suction tube directly into cleaning solution and apply to surface at low-pressure. For best results, limit your work area to smaller sections of approximately 25 sq.ft. Allow degreaser to remain on surface 1–3 minutes. **Do not** allow detergent to dry on surface. Rinse at high-pressure in a sweeping motion keeping the spray nozzle approximately 3–6" from the cleaning surface. Always clean from top to bottom and from left to right.

Without detergent: Pre-rinse cleaning surface with fresh water and wash with water on high-pressure using same directions as above.

Cars, Boats & Motorcycles

Take care when using high-pressure setting as high-pressure can potentially damage the finish or paint.

With Detergent: Fill detergent bottle with Car/Boat Wash (39-4579-0). Place detergent suction tube directly into cleaning solution and apply to surface at low-pressure. For best results, clean one side of vehicle at a time and always apply detergent from bottom to top, **do not** allow detergent to dry on surface. Rinse at high-pressure in a sweeping motion keeping the spray nozzle approximately 6–8" from the cleaning surface (distance should increase when rinsing pin-striping or other sensitive surfaces). Always clean from top to bottom and from left to right. For best results, wipe surface dry with a chamois or soft dry cloth.

Barbecue Grills, Outdoor Power Equipment & Gardening Tools

With Detergent: Fill detergent bottle with Heavy-duty Degreaser (39-4578-2). Place detergent suction tube directly into cleaning solution and apply detergent at low-pressure. Allow degreaser to remain on surface 1–3 minutes. **Do not** allow detergent to dry on surface. Rinse at high-pressure keeping the spray nozzle approximately 3–6" from the cleaning surface. For removing extremely stubborn dirt, it may be necessary to move the spray nozzle even closer to the surface for greater dirt cutting action.

Without Detergent: Pre-rinse cleaning surface with fresh water and wash with water on high-pressure using same directions as above.

Wood Patio & Lawn Furniture

With detergent: Remove all fabrics (i.e. cushions). Fill detergent bottle with Deck/Fence Cleaner (39-4577-4). Place detergent suction tube directly into cleaning solution and apply to surface at low pressure. Allow Pressure Wash to remain on surface 1–3 minutes. **Do not** allow detergent to dry on surface. Rinse at high pressure in a sweeping motion keeping the spray nozzle approximately 3–6" from the cleaning surface (distance should increase when spraying sensitive surfaces). For best results, clean from top to bottom and from left to right.

Without detergent: Pre-rinse furniture with fresh water and wash with water on high-pressure using same directions as above.

TECHNICAL SPECIFICATIONS

Specifications

Pump Pressure:	1100 PSI (Operation pressure)
Power Source Requirement:	120 V, 15 A, 60 Hz
Electrical cord:	33'
High-pressure hose:	23'
Max. Pressure:	1700 PSI (119 BAR)
Water Flow Rate (at 1000 PSI):	1.5 GPM (Gallon Per Minute)
Current Drawn:	12.2 A
Detergent Injection Rate (adjustable):	0–15%
Inlet water:	Cold tap water
Nozzle spray angle (high-pressure):	0–60°
Nozzle spray angle (low-pressure):	0–90°
Turbo Nozzle:	30°

TROUBLESHOOTING

Disconnect the machine from the power source before making any repair.

Symptom	Cause	Solution
Motor will not start.	On/Off switch is in the "OFF" (O) position.	Turn switch to the "ON" (I) position.
	Power cord is not plugged in.	Plug in power cord.
	Extension cord is too long. Extension cord is not proper gauge. Extension cord is damaged.	Replace extension cord with either a 25' 12/2 gauge cord or a 50' 10/2 gauge cord.
	Electrical outlet does not supply adequate power.	Try a different outlet.
	Tripped pressure washer circuit breaker	Allow to cool and restart unit.
Unit does not reach high-pressure.	Diameter of garden hose is too small.	Replace with a inch or 5/8" garden hose.
	Water supply is restricted.	Check garden hose for kinks, leaks and blockage.
	Not enough inlet water supply.	Open water source full force.
	Water inlet filter is clogged.	Remove filter and rinse out in warm water.
	Power nozzle is in low pressure position.	Turn power nozzle to high-pressure position.
	Pump is sucking air.	Check that hoses and fittings are air tight. Turn "OFF" machine and purge pump by squeezing trigger gun until a steady flow of water emerges through the nozzle.
Output pressure varies high and low.	Not enough inlet water supply.	Turn water on full force. Check garden hose for kinks, leaks or blockage.
	Pump is sucking air.	Check that hoses and fittings are air tight. Turn "OFF" machine and purge pump by squeezing trigger gun until a steady flow of water emerges through the nozzle.
	Water inlet filter is clogged.	Remove filter and rinse out in warm water.
	Discharge nozzle is obstructed.	Blow out or remove debris with a fine needle.
	Calcified gun, hose or power nozzle.	Run distilled vinegar through detergent tank.

Symptom	Cause	Solution
No detergent.	Detergent container is empty.	Add more detergent.
	Detergent bottle or suction tube not properly connected.	Check connections.
	Detergent is too thick.	Dilute detergent.
	Filter on detergent suction tube is clogged.	Run warm water through filter to remove debris.
	Damaged or clogged detergent suction tube.	Remove obstruction or replace detergent suction tube.
	Nozzle is in high-pressure position.	Turn nozzle tip to low-pressure position.
	Discharge nozzle is obstructed.	Blow out or remove debris with a fine needle.
Garden hose connection leaks.	Loose fittings.	Tighten fittings.
	Missing/worn rubber washer.	Insert new washer.
Spray wand, or extension, or nozzle leaks.	Spray nozzle not properly attached.	Insert the spray nozzle into the trigger gun. Carefully press in against the spring tension and twist into the locked position.
	Broken o-ring or plastic insert.	Call Customer Service.
Pump is noisy.	Pump is sucking air.	Check that hoses and fittings are air tight. Turn off machine and purge pump by squeezing trigger gun until a steady flow of water emerges through the nozzle.
Water leaks from pump (up to 10 drops per minute is permissible).	Loose fittings.	Check that all fittings are tight.
	Water seals are damaged or worn.	Call Customer Service.
Oil Drip.	Oil seals are damaged or worn.	Call Customer Service.
Motor buzzes but fails to run.	Supply voltage below minimum.	Verify that only the pressure washer is running on this circuit.
	System has residual pressure.	Turn unit "OFF", squeeze trigger on spray wand to release pressure, then turn unit "ON".
	Voltage loss due to extension cord.	Do not use extension cord with this unit—plug directly into power outlet.
	Pressure washer not used for long periods.	Call Customer Service.

IF YOU ENCOUNTER ANY ADDITIONAL DIFFICULTIES NOT LISTED, PLEASE CALL CUSTOMER SERVICE AT 1-866-4SIMONIZ (1-866-474-6664) FOR HELP.

SIMONIZ [®] _{ME}