

# **SIMONIZ**®

• PLATINUM SERIES •

## 3200 PSI Gas Pressure Washer

039-8056-0

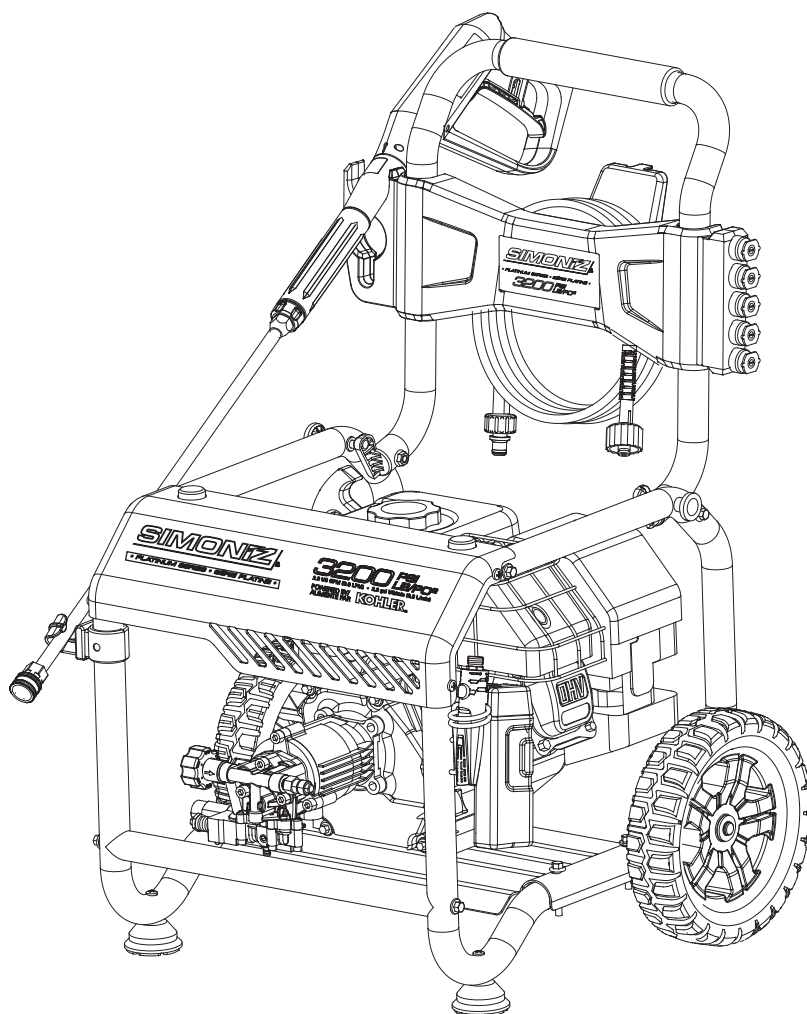

## Use and Care Guide

Congratulations on the purchase of your new pressure washer. In order to ensure you have the best possible experience please read through the following instructions. If you require any help, please contact the customer service department at:

**1-866-4SIMONIZ**  
**(1-866-474-6664)**

*Contact us for assistance; we're here to help.*



Model no. XG01

Version no. 02

# Table of Contents

---

1. SAFETY ADVICE .....	3
1.1 DEFINITIONS .....	3
1.2 SAFETY WARNINGS .....	3
1.3 INTENDED APPLICATION .....	7
2. EXPLODED VIEW .....	8
3. PARTS LIST .....	8
4. ASSEMBLY INSTRUCTIONS .....	9
4.1 SURFACE PREPARATION .....	9
4.2 WATER SUPPLY (COLD WATER ONLY) .....	9
4.3 ASSEMBLY STEPS .....	9
5. ENGINE OPERATION .....	12
5.1 ADDING / CHECKING OIL .....	12
5.2 ADDING FUEL .....	13
5.3 CHECKING AIR FILTER .....	14
5.4 PURGING .....	14
5.5 STARTING ENGINE .....	15
5.6 STOPPING ENGINE .....	16
6. CLEANING WITH DETERGENT INSTRUCTIONS .....	17
6.1 CLEANING WITH DETERGENTS .....	17
6.2 WORKING WITH THE DETERGENT INJECTION TUBE .....	17
6.3 WORKING WITH THE FOAM BLASTER .....	18
7. OPERATING INSTRUCTIONS .....	20
7.1 USING PRESSURE WASHER .....	20
7.2 SHUTTING DOWN AND CLEANING UP .....	20
7.3 USING SPRAY NOZZLE .....	20
8. CLEANING AND MAINTENANCE .....	21
8.1 CLEANING THE SPRAY TIPS .....	21
8.2 CLEANING WATER INLET FILTER .....	21
8.3 ENGINE MAINTENANCE .....	21
8.4 SHORT TERM STORING .....	22
8.5 LONG TERM STORING .....	22
8.6 WINTERIZING PROCEDURES .....	23
9. TECHNICAL SPECIFICATIONS .....	24
10. TROUBLESHOOTING .....	25
10.1 TROUBLESHOOTING ENGINE .....	25
10.2 TROUBLESHOOTING PUMP .....	26
10.3 TROUBLESHOOTING ACCESSORIES & CONNECTIONS .....	26
11. LIMITED WARRANTY .....	28

---

## 1. SAFETY ADVICE

### IMPORTANT, RETAIN FOR FUTURE REFERENCE AND READ CAREFULLY!

Do not attempt to install or operate this device until you have read the safety instructions in this manual. Safety items throughout this manual are labelled with **Danger**, **Warning**, or **Caution** depending on the risk type.

Read and understand the operating manual and labels on the product. Familiarize yourself with the product application and limitations and the specific potential hazards. Know the controls and their proper use. It is important to know how to stop the product and disengage the controls quickly.

#### 1.1 Definitions

 This is the safety alert symbol. It is used to alert you to potential personal injury hazards. Obey all safety messages that follow this symbol to avoid possible injury or death.

#### DANGER

Indicates an imminently hazardous situation which, if not avoided, will result in death or serious injury.

#### WARNING

Indicates a potentially hazardous situation which, if not avoided, could result in death or serious injury.

#### CAUTION

Indicates a potentially hazardous situation which, if not avoided, could result in minor or moderate injury.

#### TOXIC GASES

Alerts against possible toxic gases which can be harmful to your health or deadly if you are exposed to them.

#### FLAMMABLE AND COMBUSTIBLE MATERIALS

Alerts against the presence of materials/gases which can be extremely flammable.

#### POISONOUS

Alerts against materials/gases which are very poisonous and can cause serious bodily harm or even death.

#### IMPORTANT

Installation, operation, or maintenance information which is important but not hazard-related.

#### 1.2 Safety Warnings

#### IMPORTANT

Never operate this product under the following conditions:

- If a noticeable change occurs in the engine speed
- If the engine misfires
- If there are flames or smoke in the area
- If there are excessive vibrations

#### DANGER

Read all safety warnings and all instructions. Failure to follow the warnings and instructions may result in fire and/or serious injury.

# 4 Safety Advice

## 1. SAFETY ADVICE (cont.)

### 1.2 Safety Warnings (cont.)



#### **DANGER — WORK AREA SAFETY AND EXHAUST FUMES**

- Keep work area clean and well lit. Cluttered and dark areas incite accidents.
- Operate the product in a clean, dry and well-ventilated area.
- Do not operate the product in explosive atmospheres, such as in the presence of flammable liquids gases or dust. Power tools create sparks which may ignite the dust or fumes.
- Never operate the product on a steep slope.
- Keep children, pets, and bystanders away from the operating area. Breathing exhaust fumes can cause serious injury or even death.
- Never start or run the engine indoors. The exhaust fumes are dangerous, containing carbon monoxide, an odorless and deadly gas. Operate this product only in a well-ventilated outdoor area.

**GASOLINE ENGINES PRODUCE TOXIC CARBON MONOXIDE EXHAUST FUMES. BREATHING CARBON MONOXIDE CAN CAUSE NAUSEA, FAINTING, OR DEATH.**



#### **WARNING — INADEQUATE VENTILATION**

- Materials placed against or near the product, or operating the product in areas where the ambient temperature exceeds 40°C (104°F) (such as storage rooms or garages) can interfere with its proper ventilation features, causing overheating and possible ignition of the materials or buildings.
- Operate the product in a clean, dry, and well-ventilated area at least 2 meters away from any buildings, objects, or walls.
- **NEVER OPERATE THIS PRODUCT INDOORS OR IN POORLY VENTILATED AREAS.**



#### **CAUTION — HOT ENGINE AND MUFFLER**

**THE ENGINE AND MUFFLER BECOME VERY HOT DURING AND AFTER USE. AVOID TOUCHING THE ENGINE OR THE MUFFLER DURING OR AFTER USE.**



#### **WARNING — PERSONAL SAFETY**

- Stay alert, watch what you are doing, and use common sense when operating a pressure washer. Do not use a pressure washer while you are tired or under the influence of drugs, alcohol, or medication. Moment of inattention while operating a pressure washer may result in serious personal injury.
- Use safety equipment. Always wear eye protection. Protective equipment such as a dust mask, non-skid safety shoes, a hard hat, or hearing protection used for appropriate conditions will reduce personal injuries.
- Do not use the product if the engine's switch does not turn it on or off. Any gasoline powered product that cannot be controlled with the engine switch is dangerous and must be repaired.
- Remove any adjusting key or wrench before starting the pressure washer, a wrench or a key left attached to a rotating part of the pressure washer may result in personal injury.
- Do not overreach. Do not operate the product while barefoot or when wearing sandals or similar lightweight footwear. Wear protective footwear that will protect your feet and improve your footing on slippery surfaces. Do not stand on the product. Keep proper footing and balance at all times. This enables better control of the product in unexpected situations.
- Dress properly. Do not wear loose clothing or jewellery. Keep your hair, clothing, and gloves away from moving parts. Loose clothes, jewellery, or long hair can get caught in moving parts.
- Do not place your hands or feet near moving parts.
- Do not use while on a ladder.

## 1. SAFETY ADVICE (cont.)

### 1.2 Safety Warnings (cont.)



#### FLAMMABLE AND POISONOUS MATERIALS

- Gasoline is highly flammable and its vapours can explode if ignited. Take precautions when using fuel to reduce the chance of serious personal injury.
- When refilling or draining the fuel tank, use an approved fuel storage container while in a clean, well-ventilated outdoor area.
- Do not smoke or allow sparks, open flames, or other sources of ignition near the area while adding fuel or operating the product. Never fill fuel tank indoors.
- Equip the operating area with a fire extinguisher certified to handle gasoline or fuel fires.
- Keep grounded conductive objects, such as tools, away from exposed, live electrical parts and connections to avoid sparking or arcing. These events could ignite fumes or vapours.
- Always stop the engine and allow it to cool before filling the fuel tank. Never remove the cap of the fuel tank or add fuel while the engine is running or when the engine is hot. Do not operate the product with known leaks in the fuel system.
- Loosen the fuel tank cap slowly to relieve any pressure in the tank.
- Replace fuel tank and container caps securely and wipe up spilled fuel. Never operate the product without both caps securely in place.
- Avoid creating a source of ignition for spilled fuel. If fuel is spilled, do not attempt to start the engine near spill. Move the product away from the area of spillage and avoid creating any source of ignition until fuel vapours have dissipated.
- Store fuel in containers specifically designed and approved for this purpose.
- Store fuel in a cool, well-ventilated area, safely away from sparks, open flames, or other sources of ignition.
- Never store fuel or product with fuel in the tank inside a building where fumes may reach a spark, open flame, or any other source of ignition, such as a water heater, furnace, clothes dryer, or the like. Allow the engine to cool before storing indoors.



#### CAUTION—ENGINE SAFETY

- Certain components in this product and its related accessories contain chemicals which are known to cause cancer, birth defects, or other reproductive harm. Wash hands after handling.
- The engine exhaust from this product contains chemicals which are known to cause cancer, birth defects, or other reproductive harm.
- Check fuel lines, tank, cap, and fittings frequently for cracks or leaks. Replace if necessary.
- This engine was shipped without oil. Before you start the engine, make sure you add oil according to the instructions in this manual. If you start the engine without oil, it will be damaged beyond repair and will not be covered under the warranty.
- When starting engine ensure that spark plug, muffler, fuel cap and air filter are in place and secured.
- Do not crank engine with spark plug removed.
- If engine floods, move the throttle control to fast position and crank until engine starts.
- When operating the engine do not tip engine or equipment at an angle which will cause fuel to spill.
- Do not choke the carburetor to stop the engine.
- Never start or run the engine with the air cleaner assembly or the air filter removed.
- Transport or move the product only with empty fuel tank.
- Rapid retraction of starter cord (kickback) will pull hand and arm towards engine faster than you can let go. Risk of injury – broken bones, fractures, bruises, or sprains could result.
- Keep the engine and muffler free of grass, leaves, excessive grease, or carbon build-up to reduce the chance of a fire hazard.
- Do not tamper with any part of the engine to increase its speed.
- If the product makes an unusual noise or vibration, immediately shut off the engine, disconnect the spark plug wire, and check for the cause. Unusual noise or vibration is generally a sign of a problem.
- Use only attachments and accessories approved by the manufacturer. Failure to do so can result in personal injury.

# 6 Safety Advice

## 1. SAFETY ADVICE (cont.)

### 1.2 Safety Warnings (cont.)



#### CAUTION — SPECIFIC SAFETY ADVICE

- Avoid dangerous conditions. Always operate this product on dry, solid and level ground.
- Never operate this product on slippery, wet, muddy, or icy surfaces. The operating area should be free from any obstructions. There should be plenty of room for handling, and the operator should stay alert at all times.
- Do not use this product in wet or damp areas or expose it to rain. Do not use it in areas where fumes from paint, solvents or flammable liquids pose a potential hazard.
- Inspect this product. Check before turning it on. Keep guards in place and in working order. Form a habit of checking to see that keys and adjusting wrenches are removed from tool area before turning it on.
- Replace damaged, missing or failed parts before using it. Make sure all nuts, bolts, screws, hydraulic fittings, hose clamps, etc. are securely tightened. Always check the oil level in the oil tank. Never operate this product when it needs to be repaired or when it is in poor mechanical condition.
- Never move or pull this product while spraying.
- Do not run the engine at a high speed when you are not using the product.
- **Risk of electric shock.** The water spray must never be directed towards any electric wiring, devices, or directly towards the pressure washer itself, or fatal electric shock may occur.
- **Risk of injury.** Do not direct the water flow at people. The high-pressure jet can be dangerous if misused, and therefore must not be directed at people, animals, electrical devices or the unit itself.
- **Risk of explosion.** When a combustible liquid is sprayed, there can be danger of fire or explosion, especially in a closed area. Therefore, do not spray flammable liquids. Do not use acids and solvents with this product either. These products can cause physical injuries to the operator and irreversible damage to the device.
- Learn how to stop the product and release the pressure quickly. Familiarize yourself with the controls.



#### CAUTION — SPECIFIC SAFETY ADVICE

This product is capable of producing high pressure as rated in the **Technical Specifications**. To avoid rupture and injury, do not operate this product with components rated less than the unit itself (including but not limited to spray guns, hose, and hose connections).



#### WARNING — INJECTION HAZARD

Equipment can cause serious injury if the spray penetrates the skin. Do not point the gun at anyone or any part of the body. In case of penetration, seek medical aid immediately.



#### CAUTION — DETERGENTS

This device has been designed for use with detergents that are specifically approved for pressure washer use. The use of other cleaning detergents may affect the operation of the device and void the warranty.



#### CAUTION — SPRAY GUN

The spray gun kicks back, so hold it with both hands. The trigger gun safety lock prevents the trigger from being engaged accidentally. However, the safety feature DOES NOT lock the trigger in the **ON** position.



#### CAUTION — WATER CONNECTIONS

- For use with fresh and clean water only. Do not use this product with other liquids.
- The water supply system must be protected against backflow.
- Never use this product with water contaminated with solvents (e.g. paint thinners, gasoline, oil, etc.).
- Always prevent debris from being drawn into the product by using a clean water source and an additional water filter, if required.
- If this device is connected to a potable water system, the system must be protected against backflow.
- Suitable water temperature: from 5 to 40 °C (41 to 104 °F).



## 1. SAFETY ADVICE (cont.)

### 1.2 Safety Warnings (cont.)

#### CAUTION — SERVICE

- Before cleaning, repairing, inspecting, or adjusting, shut off the engine and make sure that all moving parts have stopped.
- Have your product serviced by certified repair personnel using only identical replacement parts. This ensures the safety of the product is maintained.
- Ensure proper maintenance. Check for misalignment or binding of moving parts, breakage of parts and other condition that may affect the product's operation. If damaged, have the product repaired before use. Many accidents are caused by poorly maintained equipment.

#### IMPORTANT — COLD WEATHER START

Do not operate this pressure washer in temperatures below 5°C. Operating pressure washer below 5°C may cause damage to the pump and other pressure washer parts.

#### IMPORTANT — SAFETY FEATURES

**Thermal Relief Valve:** Protects the pump from overheating in case the nozzle gets clogged. This system should not be abused. Make sure the pump does not overheat.

**Low-Oil Auto Shut-Off:** Protects the engine and prevents operating without proper lubrication. If the engine oil level goes below the recommended level, the pressure washer shuts off automatically.

#### CAUTION — PREVENT PUMP DAMAGE

- Do not run the engine for more than 5 minutes without pressing the wand trigger or damage to the pump might occur.
- Never let the engine run unless the product is connected to a water supply. Ensure water is running through the pressure washer before attempting to start the engine.
- Never run caustic fluids or acid through this product.

#### IMPORTANT — STORAGE

- Store the product in a well-ventilated area, with an empty fuel tank. Fuel should never be stored or placed near the product.
- When storing the product for winter, ensure that it is stored indoors (at room temperature), in a dry location away from any heat or ignition sources.
- If the product is to be stored with fuel in the fuel tank, add a fuel stabilizer (38-0907-6) to keep the gas from breaking down.
- To protect and extend the life of the product when storing it, use an antifreeze agent (039-8602) for the pump, which can be found at your local Canadian Tire store.

### 1.3 Intended Application

This product is designed for specific residential applications. Do not modify or use this product for any application other than the one it was designed for. This equipment was not designed for industrial use. Please refer to the icons below for suggested applications. For questions regarding other uses, please refer to our website at [www.simoniz.ca](http://www.simoniz.ca) or call us at **1-866-4SIMONIZ** (1-866-474-6664).

#### IMPORTANT — APPLICATIONS

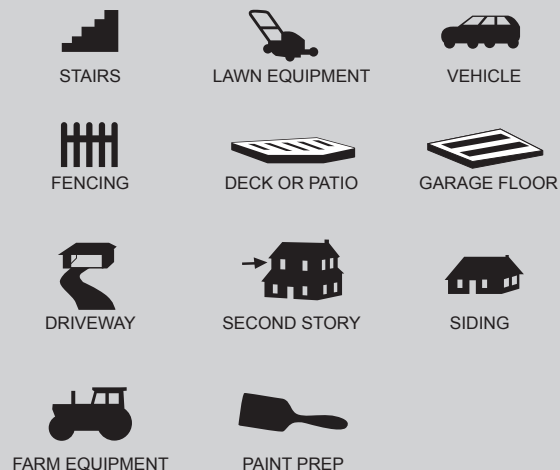

## 8 Exploded View / Parts List

### 2. EXPLODED VIEW

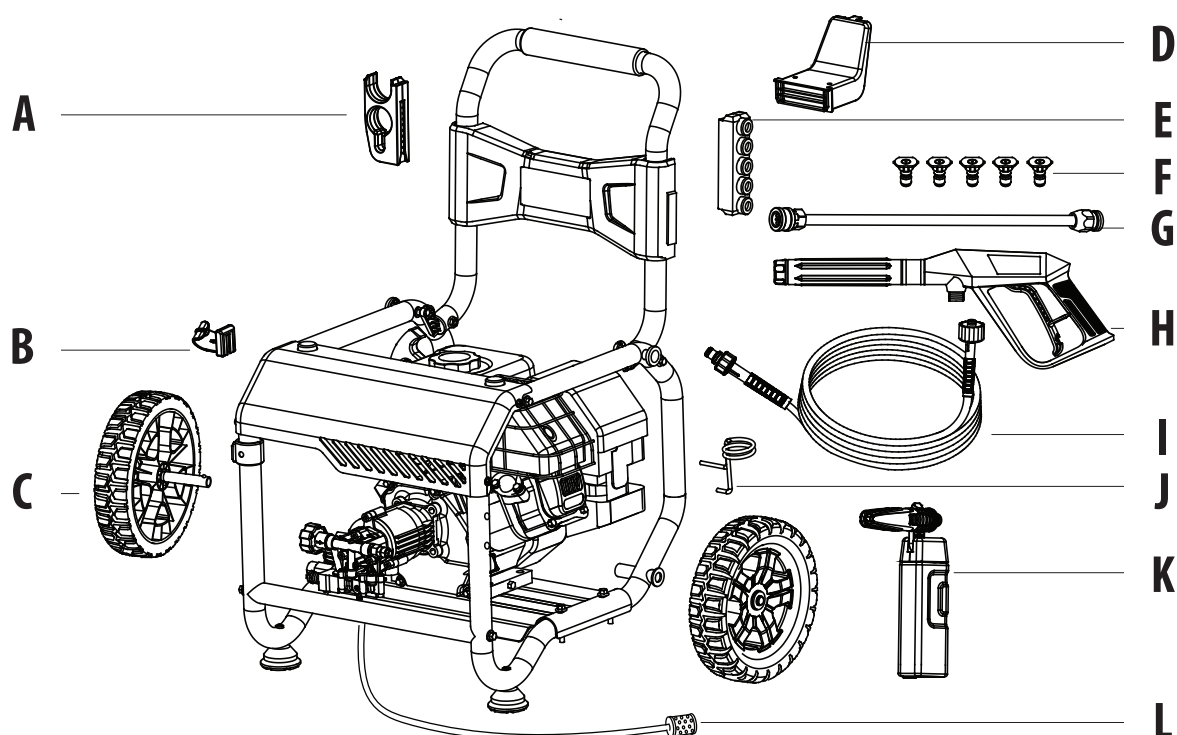

### 3. PARTS LIST

Item #	Part Name	Qty.	Part #
A	Gun Holder	1	XG01-040-0001
B	Gun Support	1	XG01-030-0001
C	Wheel	2	XG01-030-2000
D	Hose Hook	1	XG01-040-0002
E	Tip Holder	1 set	XG01-040-0010
F	Spray Tips Kit	1 set	XG01-050-0003
G	Quick-Connect Wand	1	XG01-050-0002
H	Gun Assembly	1	XG01-050-0001
I	Pressure Hose	1	XG01-050-0004
J	Bottle Holder	1	XG01-030-0002
K	Foam Blaster	1 set	XE18-060-0000
L	Detergent Injection Tube (comes pre-attached on the machine)	1 set	XG01-202-1000
N/A	Water Filter (comes pre-attached on the machine)	1	—

Part Name	Qty.	Diagram
Engine Oil Funnel	1 set	
Spark Plug Wrench	1 set	
Wrench	1 piece	
Cleaning Needle	1 piece	

#### WARNING

Engine oil is not included. Always use oil type **SAE 10W-30**.  
**Add oil to the engine before starting it.**



## 4. ASSEMBLY INSTRUCTIONS

### 4.1 Surface Preparation

Before beginning any cleaning task, it is important to inspect the area for objects that could create a hazard. Remove any objects from the work area that could be tripped over, such as toys or outdoor furniture. Ensure that all doors and windows are closed tightly.

### 4.2 Water Supply (Cold Water Only)

- The unit must be used with cold water supply only. The water hose must be at least 13 mm (1/2") in diameter.
- The water flow rate must not fall below 18 litres per minute LPM (4 gallons per minute GPM), or the pump might be damaged. The flow rate can be determined by running water for one minute into an empty container.
- The water supply temperature must not exceed 40°C (104°F)



### WARNING — INJECTION HAZARD

Pressure washer can cause serious injury if the spray penetrates the skin. Do not point the gun at anyone or any part of the body. In case of penetra-tion, seek medical aid immediately.

### 4.3 Assembly Steps

1

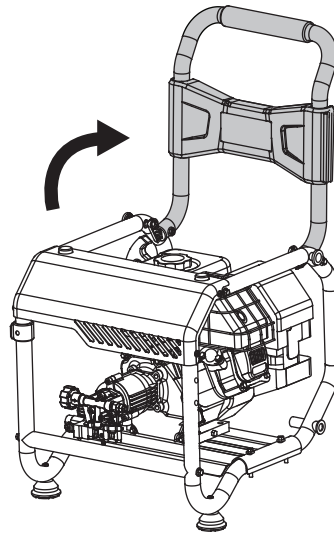

Lift the handle until it is locked at upright position.

2

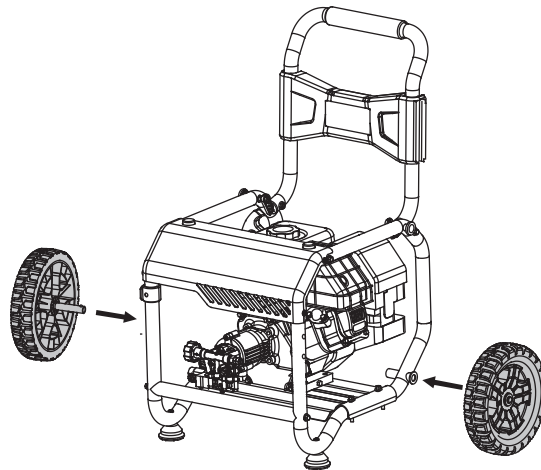

Install the wheel on the wheel receptacle by pressing the pin on the wheel shaft and align the pin to the hole on the receptacle.

# 10 Assembly Instructions

## 4. ASSEMBLY INSTRUCTIONS (cont.)

### 4.3 Assembly Steps (cont.)

3

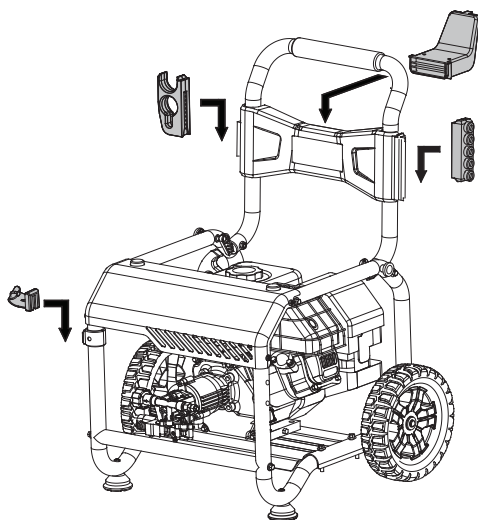

Attach the gun holder, tip holder, gun support and hose hook on the main frame and handle respectively.

4

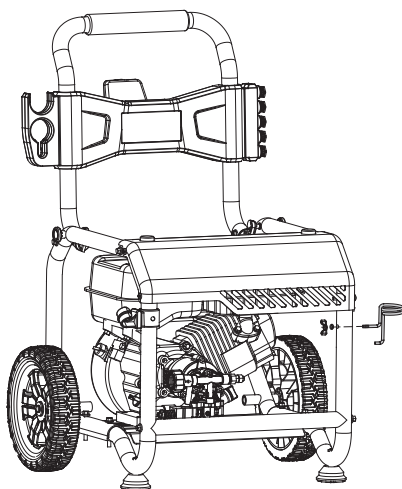

Assemble the bottle holder to the frame by tightening the wing nut.

5

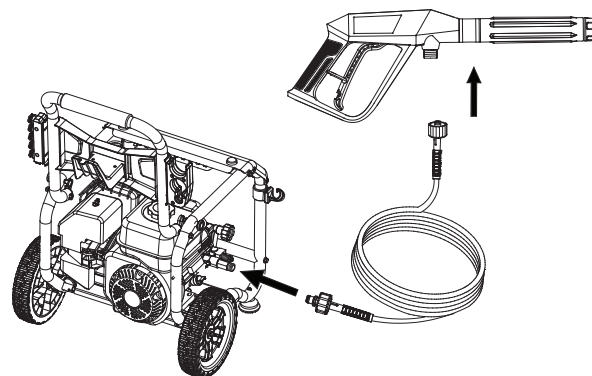

Connect the pressure hose to the pump outlet and the gun connector respectively.

6

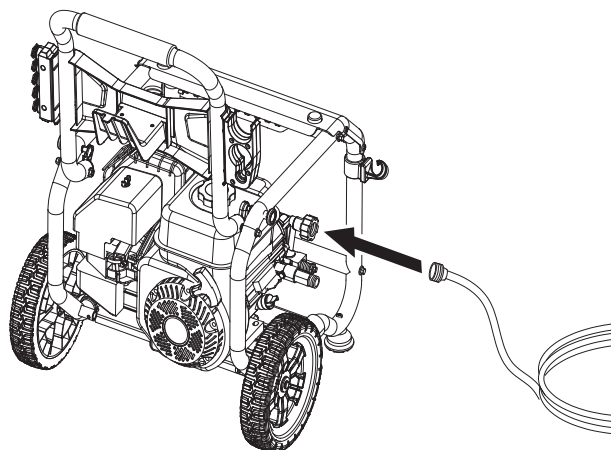

Connect the garden hose to the inlet adapter.

7

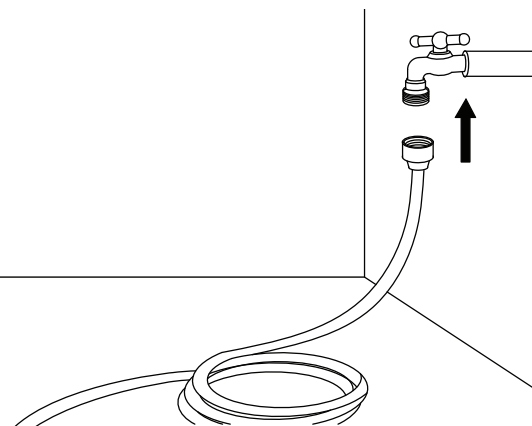

Attach the garden hose to water supply and turn water on.

## 4. ASSEMBLY INSTRUCTIONS (cont.)

### 4.3 Assembly Steps (cont.)

8

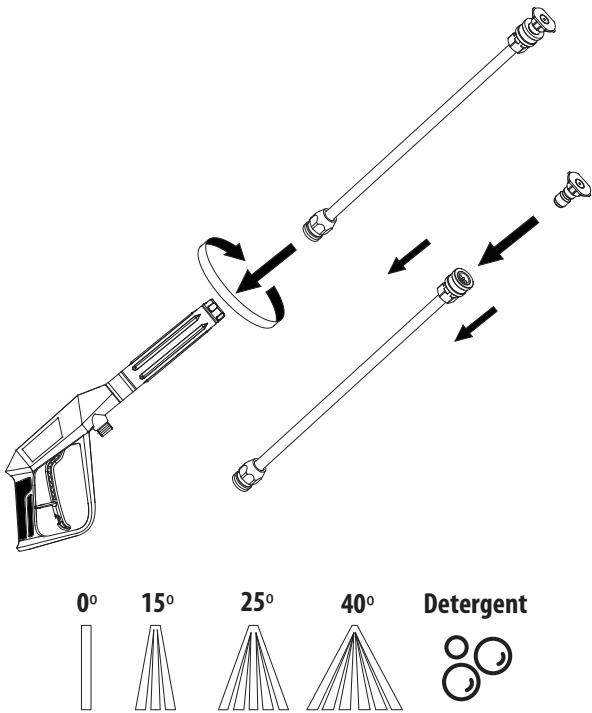

Select the desired tip based on the following purposes:

- 0° (Red): Thin and powerful stream of water for difficult stains and debris removal.
- 15° (Yellow): Thin-angled spray for detailed cleaning.
- 25° (Green): Medium-angled spray for detailed cleaning.
- 40° (White): Large pattern for wider cleaning applications.
- Detergent (Black): This nozzle must be used when applying detergents with the on-board detergent injection system. Applies detergents in low pressure only.

To install tip, gently slide the collar back before inserting it, then release the collar to lock the tip.

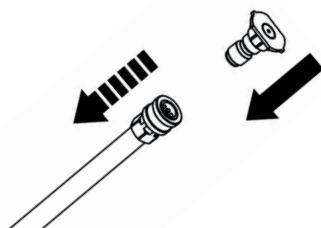

9

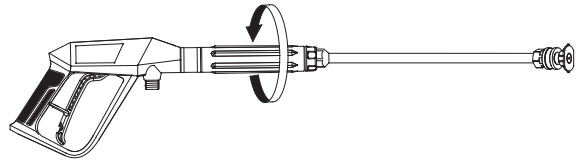

Adjust the pressure by turning the gun collar to the desired setting for the following purposes:

	<b>DETERGENT</b> For applying detergent with the on-board detergent injection system. <b>NOTE:</b> Machine performs siphon function from the on-board detergent injection system only if gun set to detergent setting and using the detergent (black) tip. (Follow the "Working with the Detergent Injection Tube" instructions on page 17.)
	<b>HIGH (2000+ PSI)</b> For cleaning tough spots and grimes. (e.g., stairs, concrete surface, driveway, farm equipment or paint stripping)
	<b>MEDIUM (1600+ PSI)</b> For general cleaning. (e.g., fence, siding, deck and patio or lawn equipment)
	<b>LOW (800+ PSI)</b> For low pressure cleaning. (e.g., vehicle, patio furniture or barbecue)

# 12 Engine Operation

## 5. ENGINE OPERATION

### 5.1 Adding/Checking Oil

#### ➔ IMPORTANT

Oil has been drained for shipping. Failure to fill engine with oil before starting engine will result in permanent damage and will void engine warranty. Add oil according to the instructions.

#### ➔ IMPORTANT

##### Before each use:

- Check the oil and fuel level and fill if necessary.
- Make sure that the spark plug, muffler, fuel cap, and air filter are in place and secured.
- Do not crank engine with spark plug removed.

#### ⚠ WARNING

- Always check the oil level before starting the engine, making sure the pressure washer is on a level surface.
- Always use oil type **SAE 10W-30**, which can be found at your local **Canadian Tire** store (28-9301-6).

**TIP:** When adding oil use provided oil funnel.

1

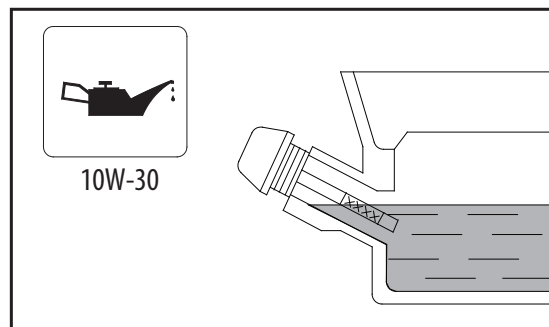
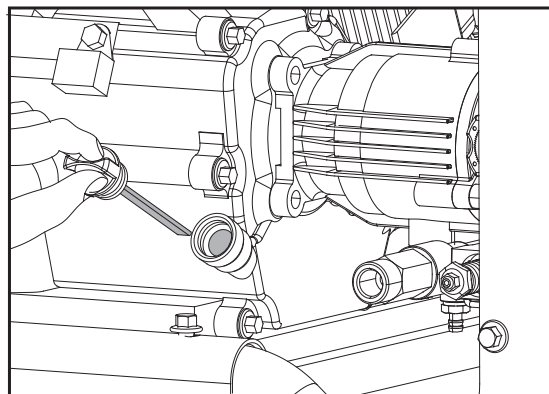

Engine Oil Reservoir Capacity: 0.6 L

1. Remove oil tank dipstick and wipe it with a clean cloth.
2. Replace and retighten the dipstick .
3. Remove the dipstick again and check the oil level. It should be at the top of the full indicator on the dipstick.
4. If low, add oil slowly into the oil tank. Do not overfill. After adding oil, wait one minute and then recheck the oil level.
5. Replace and retighten the dipstick.

## 5. ENGINE OPERATION (CONT.)

### 5.2 Adding Fuel

#### **WARNING**

- Make sure there is enough fuel in the fuel tank before operating the pressure washer.
- Use only clean, fresh, unleaded fuel. Use a minimum of 87 octane/87 AKI (91 RON).
- Do not use old gas, and do not mix oil with gasoline.
- Fuel and its vapours are extremely flammable and explosive. Fire or explosion can cause severe burns or death.

#### **IMPORTANT**

- Keep fuel away from sparks, open flames, pilot lights, heat, and other ignition sources.
- Check fuel hoses, tank, caps, and fittings for cracks or leaks. Replace if necessary.
- If fuel spills, wait until it evaporates before starting engine.
- Fill the fuel tank outdoors or in well-ventilated area.

2

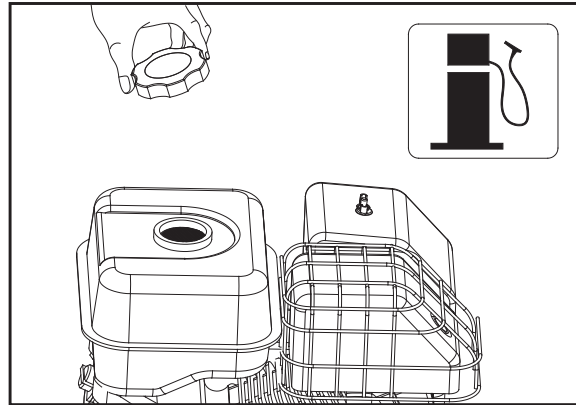

Fuel Tank Capacity: 3.2 L

1. Stop the engine (→ Stopping Engine) and let it cool at least 2 minutes before removing the fuel tank cap.
2. Clean the fuel cap area of dirt and debris. Remove the fuel tank cap and make sure the fuel filter is in place.
3. Fill the fuel tank with fuel. Never overfill the fuel tank. Fill tank to no more than 13 mm below the bottom of the filler neck to provide space for expansion caused by the engine heat. To allow for expansion of the fuel, do not fill above the bottom of the fuel tank neck.
4. Reinstall the fuel tank cap.

# 14 Engine Operation

## 5. ENGINE OPERATION (cont.)

### 5.3 Checking Air Filter

3

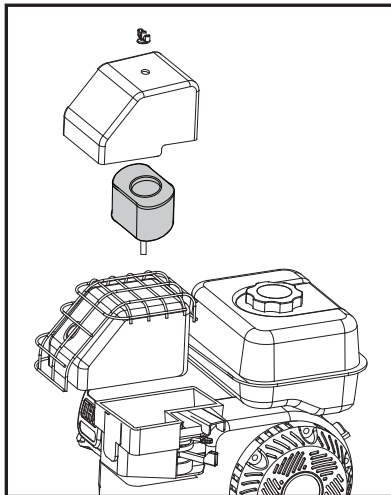

Unscrew the butterfly nut by hand and take off the air filter cover, then repeat with the second nut, and pull out the air filter element carefully. Wash it with clean water. Next, soak the filter in engine oil, and then squeeze the oil out. Place the air filter back and replace the air filter cover.



#### IMPORTANT

Clean air filter element for every 50 hours of use (every 10 hours under dusty conditions). Wash in high flashpoint solvent, squeeze dry, dip in clean engine oil, and squeeze out excess oil.

### 5.4 Purging

4

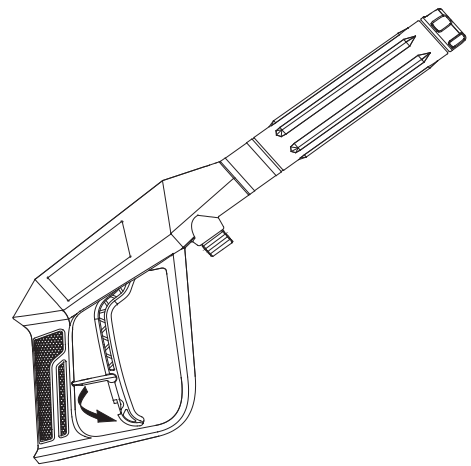

Release the safety trigger if it is locked.

5

#### PURGING

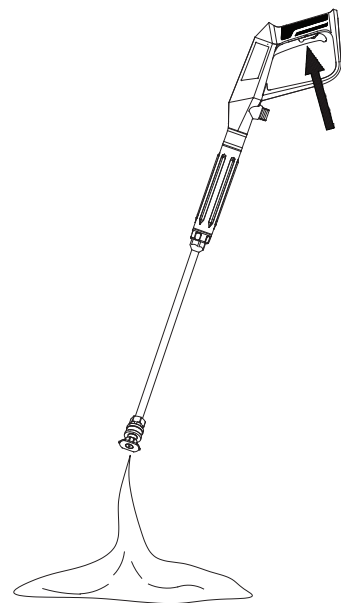

Purge air by squeezing the trigger on the gun until there is a steady stream of water.



#### WARNING — DEPRESSURIZED

After cleaning is completed turn off the water supply and pull the trigger to depressurize the unit. Failure to do so might result in personal injury due to discharge of high-pressure water.



## 5. ENGINE OPERATION (cont.)

### 5.5 Starting Engine

6

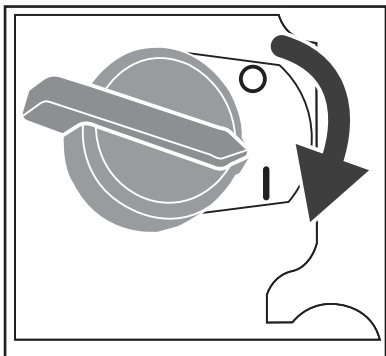

a. Set the engine I/O switch to **ON (I)** position.

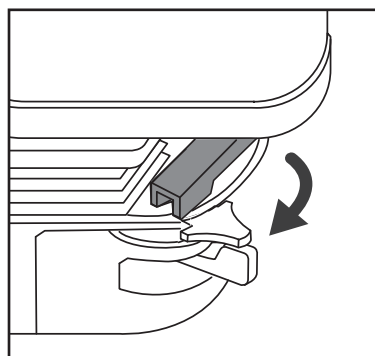

b. Move the throttle control to **HIGH** position.

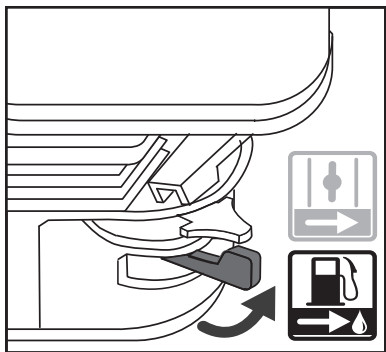

c. Move the fuel valve to **ON** position

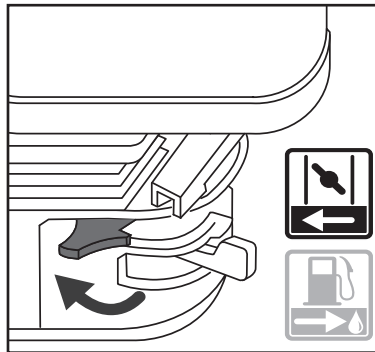

d. Move the choke lever to **CLOSED** position.

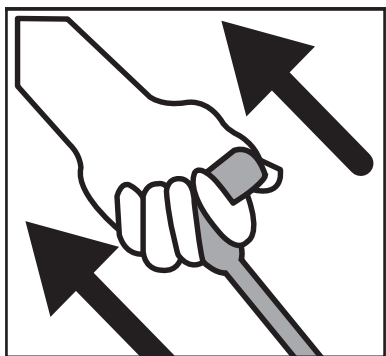

e. Pull the recoil starter grip to start the engine.

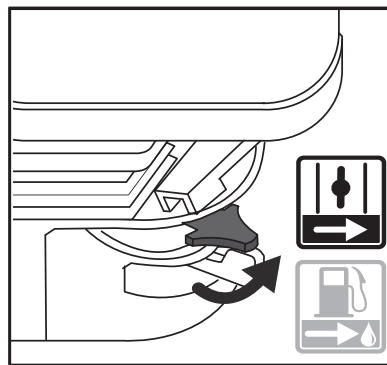

f. Once engine starts up and then move the choke lever to the **OPEN** position.



#### CAUTION

Return the recoil starter grip gently to its starting position to prevent damage to the starter or the housing.

## 5. ENGINE OPERATION (cont.)

### 5.6 Stopping Engine

7

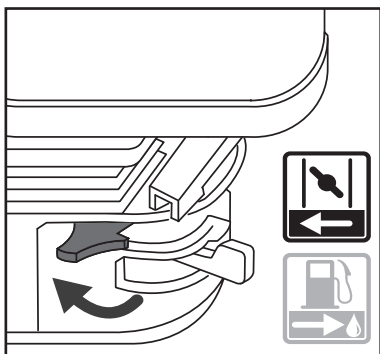

a. To stop the engine move the choke lever to the **CLOSED** position.

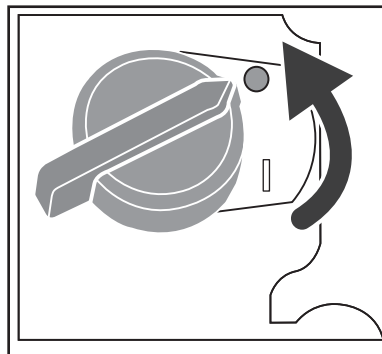

b. Set the engine I/O switch to **OFF (0)** position.

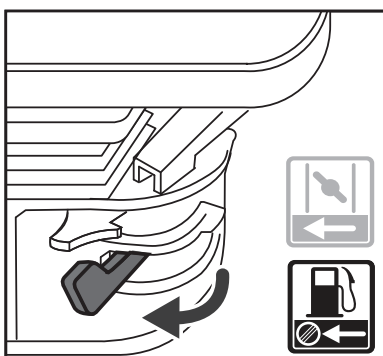

c. Move the fuel valve to **OFF** position.



#### IMPORTANT

Restarting the engine after running it for over 5 minutes, place the choke lever to **OPEN** position to restart the engine.

## 6. CLEANING WITH DETERGENT INSTRUCTIONS (cont.)

### 6.1 Cleaning with Detergents

Working with a detergent ensures quick soaking of the dirt, and allows the high-pressure water to penetrate and remove the dirt more effectively. Always spray detergent on a dry surface, do not pre-soak the area. Wetting the surface first dilutes the detergent and reduces its cleaning ability.

#### → IMPORTANT

This pressure washer is intended for use with special pressure washer detergents only. Do not use powdered soaps, which would clog the injection system. Follow the detergent manufacturer's directions or call the Simoniz toll-free number at **1-866-4SIMONIZ** (1-866-474-6664) if you have any questions or concerns.

#### → IMPORTANT

Working with a detergent ensures quick soaking of the dirt, and allows the high-pressure water to penetrate and remove the dirt more effectively. Always spray detergent on a **dry** surface, do not presoak the area. Soaking the surface dilutes the detergent and reduces its cleaning ability.

#### ⚠ WARNING

Damage may occur to painted surfaces if chemicals (detergents) are allowed to dry on them. Wash and rinse a small section at a time. Avoid working on hot surfaces or under direct sunlight.

### 6.2 Working with the Detergent Injection Tube

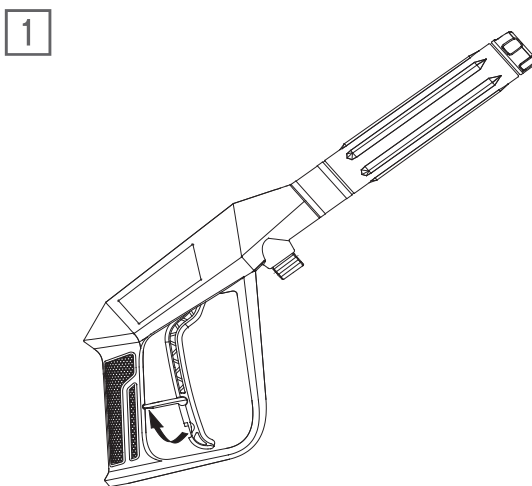

Engage the safety lock on the spray gun.

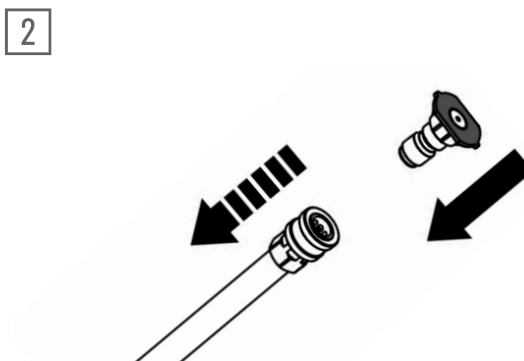

Insert the (detergent) black tip by gently sliding the collar back on the quick-connect wand before inserting it in, then release the collar to lock the tip.

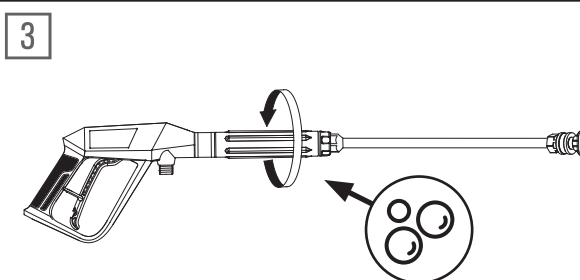

Adjust the pressure by turning the gun collar to the detergent setting.

**NOTE:** Machine performs siphon function only if gun is set to detergent setting and using the detergent (black) tip.

# 18 Cleaning with Detergent Instructions

## 6. CLEANING WITH DETERGENT INSTRUCTIONS (cont.)

### 6.2 Working with the Detergent Injection Tube (cont.)

4

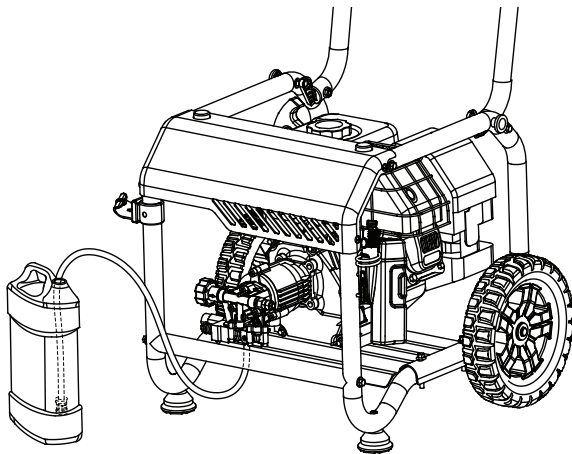

1. Insert the detergent injection tube into any pressure washer detergent container of your choice. The pump will draw the detergent and mix it with the water automatically, being discharged through the detergent nozzle at a low pressure.
2. Apply the detergent to a dry work surface from bottom to top.
3. Allow detergent to remain on the surface for a short time before rinsing. Do not allow detergent to dry on the surface.
4. Rinse with clean water under high pressure.
5. When you are finish working with detergent, place the siphon tube into a bottle with clean water and spray water for one minute to rinse the detergent injection tube and remove any soap residues that may clog it.



#### CAUTION

Damage may occur to painted surfaces if chemicals are allowed to dry on them. Wash and rinse a small section at a time.

### 6.3 Working with the Foam Blaster

1

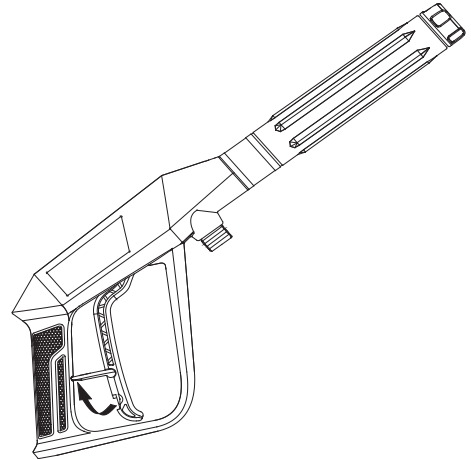

Engage the safety lock on the spray gun.

2

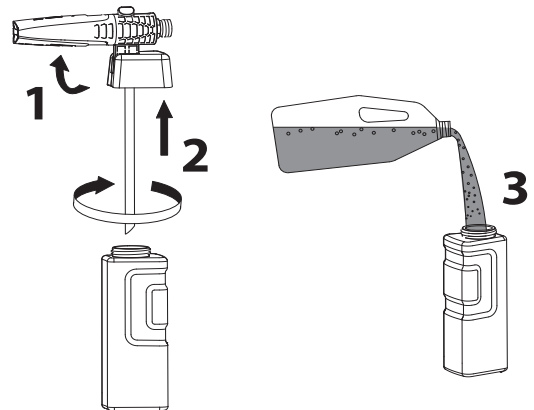

1. Rotate the foam blaster's spray head from vertical position to horizontal position.
2. Detach spray head by turning detergent bottle 1/4 turn counter-clockwise.
3. Fill the bottle with the detergent.
4. Reattach the spray head on to the bottle by turning 1/4 turn clockwise.

## 6. CLEANING WITH DETERGENT INSTRUCTIONS (cont.)

### 6.3 Working with the Foam Blaster (cont.)

3

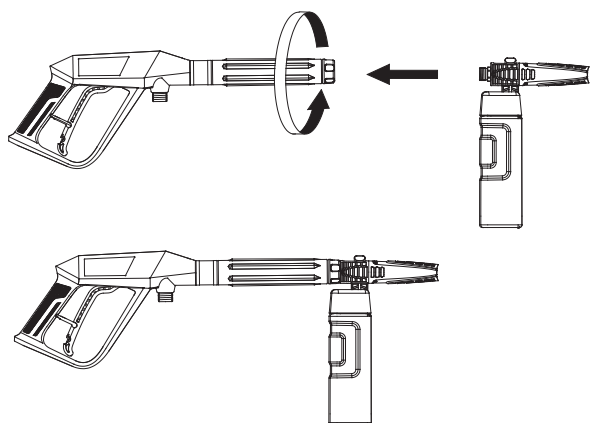

1. Attach the foam blaster onto the spray gun.
2. Apply the detergent to a dry work surface from bottom to top.
3. Allow detergent to remain on the surface for a short time before rinsing. Do not allow detergent to dry on the surface.
4. When you are finish working with detergent, fill with clean water in bottle and spray water for one minute in **ON** position to rinse the foam blaster and remove any soap residues that may clog it.

#### CAUTION

Damage may occur to painted surfaces if chemicals are allowed to dry on them. Wash and rinse a small section at a time.

4

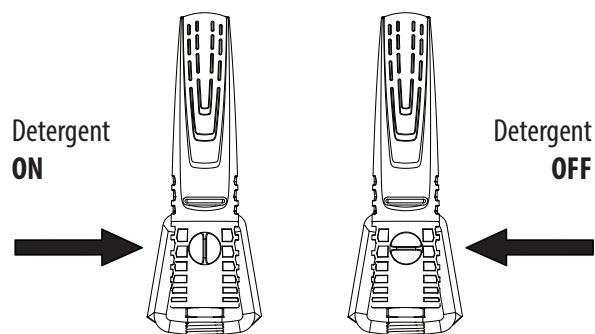

1. Set detergent **ON/OFF** knob to **ON** position to work with detergent.
2. Set detergent **ON/OFF** knob to **OFF** position for cleaning surface without detergent.

#### CAUTION

Failure to clean the foam blaster properly will cause the detergent injection system to become clogged and inoperable.

5

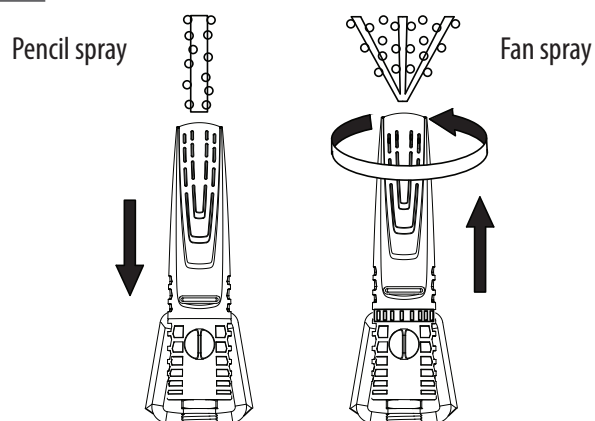

1. Pencil spray (slide collar backwards) to reach 2nd floor.
2. Fan spray (slide collar forwards) to apply detergent more efficiently. Fan spray can be adjusted 90 degrees to spray either horizontally or vertically.

# 20 Operating Instructions

## 7. OPERATION INSTRUCTIONS

### 7.1 Using Pressure Washer

1. Start the engine.
2. Install appropriate spray nozzle.
3. Adjust gun collar to desired setting for application.
4. Release the trigger safety lock if it is locked.
5. Purge the air by squeezing the trigger on the gun until there is a steady stream of water.
6. Position the tip of the wand 15-20 cm (6-8") away from the surface to be cleaned, at an angle appropriate to the spray nozzle used (0°, 15°, 25° or 40°).

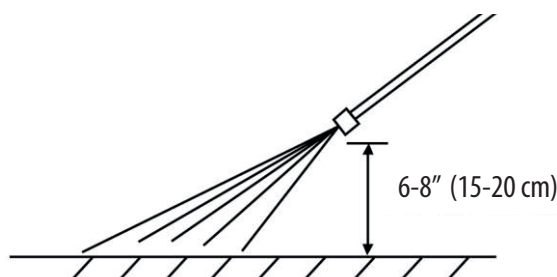

### 7.2 Shutting Down and Cleaning Up

1	(Skip this step if you are not using detergent.) After cleaning with detergent, fill the detergent tank with clean water. Spray water at a low pressure for one minute, so that all detergent is flushed out of the system.
2	Stop the engine.
3	Turn off the water supply and disconnect the water supply from the water inlet.
4	Pull the gun trigger to release any remaining water pressure.
5	Engage the trigger safety lock on the spray gun and rest the gun on lower and upper supports.



#### WARNING

Turn off the water supply and pull the trigger to depressurize the unit. Failure to do so might result in personal injury due to discharge of pressurized water.

### 7.3 Using Spray Nozzle

This pressure washer comes with 5 different nozzles that can be installed on the stainless steel wand. The spray pattern is adjusted by installing the appropriate spray nozzle.

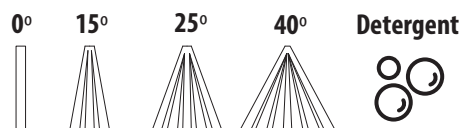

- 0° (Red): Thin and powerful stream of water for difficult stains and debris removal.
- 15° (Yellow): Thin-angled spray for detailed cleaning.
- 25° (Green): Medium-angled spray for detailed cleaning.
- 40° (White): Large pattern for wider cleaning applications.
- Detergent (Black): This nozzle must be used when applying detergents with the on-board detergent injection system. Applies detergents in low pressure only.

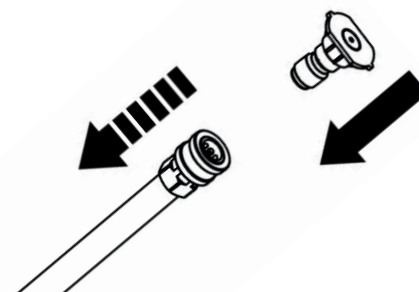

#### Installing spray nozzle to the quick-connect coupler:

1. Pull the coupler ring back and insert the desired nozzle.
2. Release the coupler ring to lock it back in place.



## 8. CLEANING AND MAINTENANCE

### 8.1 Cleaning the Spray Tips

#### WARNING

Clogging of the spray tip increases the water pressure and might damage the pump unit.

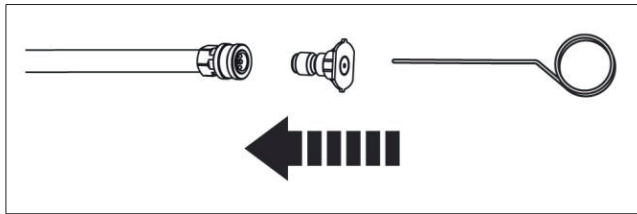

Clean the spray tip by carefully inserting the provided spray tip cleaner, or a thin, sharp object (e.g., paper clips) into the tip to remove deposits.

### 8.2 Cleaning Water Inlet Filter

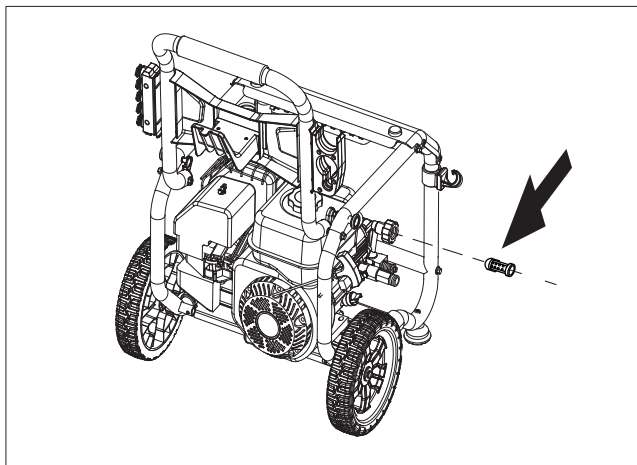

- This pressure washer is equipped with a water inlet filter.
- The water inlet filter must be kept clean at all times, otherwise it can restrict the water flow to the pump unit and damage it.
- Remove and clean the water inlet filter.

#### WARNING

**DO NOT** operate this pressure washer without the water inlet filter in place, as deposits could build up internally and affect the functioning of the unit.

### 8.3 Engine Maintenance

#### Draining Engine Oil

The engine oil should be replaced after the first 20 hours of operation, or after the first month of use. After that, it should be replaced every 100 hours or every 6 months.

#### To drain the engine oil:

1. Loosen the oil tank dipstick.
2. Place an oil container underneath the opening on the main frame.
3. Remove the oil plug and drain the oil.
4. Once the oil has been completely drained, retighten the hex screw and oil tank dipstick.

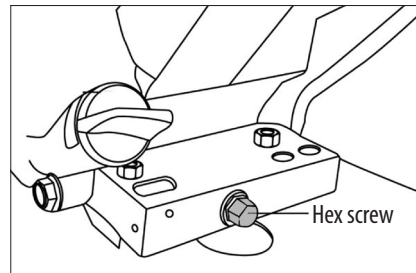

#### Recommended Engine Oil

Add oil as described in chapter → Adding/Checking Oil.

#### IMPORTANT

Used oil is a hazardous waste product and must be disposed of properly. Do not discard with household waste. Check with your local authorities, service centre, or **Canadian Tire** for safe disposal / recycling facilities.

#### Inspecting, Replacing or Cleaning the Spark Plug

The spark plug should be checked every 100 hours of operation or every 6 months.

#### To replace or clean the spark plug:

1. Disconnect the spark plug wire by pulling it off the spark plug.

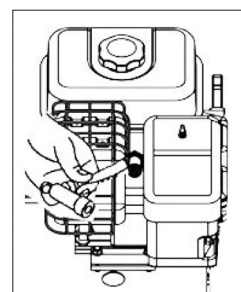

## 22 Cleaning and Maintenance

### 8. CLEANING AND MAINTENANCE (cont.)

#### 8.3 Engine Maintenance (cont.)

- Using provided spark plug wrench, remove the spark plug by turning it counter-clock wise. If there is a carbon sediment build-up, remove it. If there is too much carbon sediment, replace the spark plug.

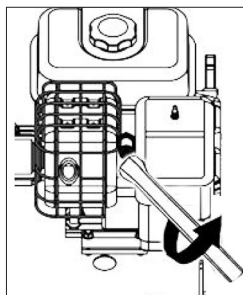

- Check the gap with a wire gauge. If necessary, reset the gap to 0.7-0.8 mm. Install and tighten the spark plug to the recommended torque—180 lb-in (20 Nm).
- Reinstall the spark plug wire and protection cage in reverse order.

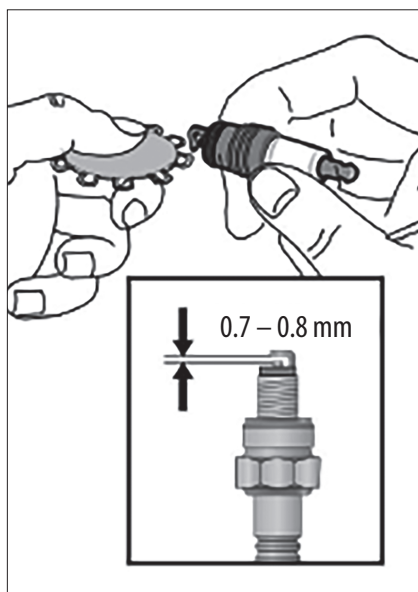

**NOTE:** In some areas, local law requires using a resistor spark plug to suppress ignition signals. If this engine was originally equipped with a resistor spark plug, use the same type for replacement.

#### 8.4 Short Term Storing

Store idle product out of the reach of children and do not allow persons unfamiliar with the product or these instructions to operate it. This product is dangerous in the hands of untrained users. Cover and store indoors, in a dry, well-ventilated area, such as a tool-shed.

#### 8.5 Long Term Storing

Long term storage of the pressure washer requires additional preventive measures to protect it against deterioration.

##### 1. Drain Fuel

Move the fuel valve to **OFF** position and remove the hex screw from the carburetor. Then, move the fuel valve to **ON** position to drain the fuel from the tank, carburetor, and hose. Screw the carburetor drain hex screw back once the fuel has been completely drained.

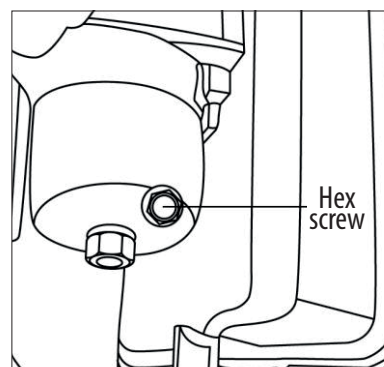

##### 2. Add Fuel Stabilizer

If you do not wish to drain the fuel tank, add a fuel stabilizer (38-0907-6) into the fuel tank. Run the engine at least five minutes after adding the stabilizer to distribute it inside the fuel system.

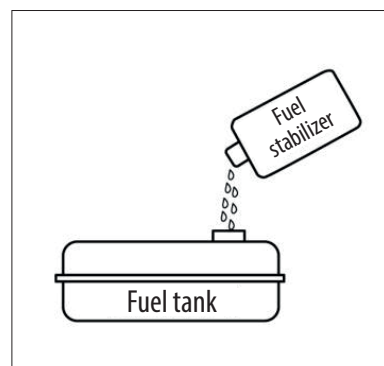

## 8. CLEANING AND MAINTENANCE (cont.)

### 8.5 Long Term Storing (cont.)

#### 3. Drain Oil

- Drain the oil Follow the "To Drain the Engine Oil" instructions on page 21).
- Remove the spark plug.
- Pour one tablespoon of oil through the spark plug hole—type 10W30.
- Make sure the engine **I/O** switch is set to **0** position. Slowly pull the starter cord handle until you feel tension, which indicates the piston is on its compression stroke and leave it in this position.
- Replace the spark plug.

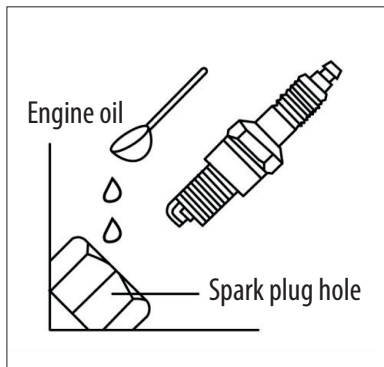

#### ➔ IMPORTANT

- If the pressure washer is to be stored with gasoline in the fuel tank and carburetor, it is important to reduce the hazard of gasoline vapor ignition.
- Select a well-ventilated storage area away from any appliance that operates with a flame, such as a furnace, water heater, or clothes dryer. Also avoid any area with a spark-producing electric motor, or where power tools are operated.
- If possible, avoid storage areas with high humidity, because that promotes rust and corrosion.
- Place the pressure washer on a level surface. Tilting can cause fuel or oil leakage.
- Do not use plastic sheets as a dust cover. A non-porous cover will trap moisture around the pressure washer, promoting rust and corrosion.

### 8.6 Winterizing Procedures

Winterizing your pressure washer will help protect and prolong its life. We strongly recommend you to follow the below steps by using Pressure Washer Antifreeze (039-8602-0). This will keep the internal parts lubricated, protected from rust, and prevents the pump from freezing.

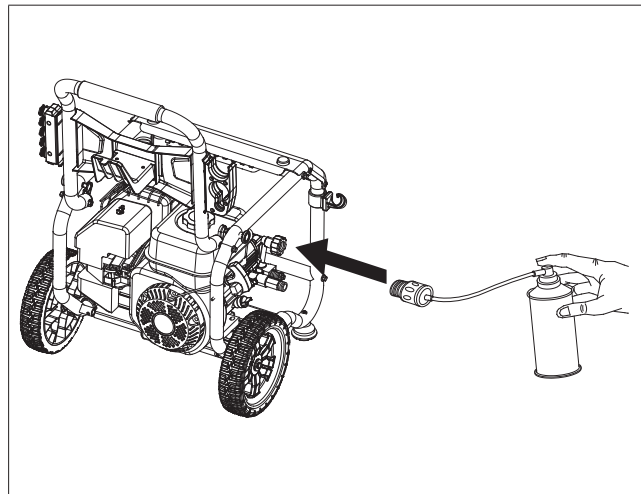

- Connect the pump saver to the inlet adaptor.
- Depress button on top of the pump saver container.
- Continue until fluid exits the pressure hose.
- Remove the hose from pump inlet.

9. TECHNICAL SPECIFICATIONS

Maximum Pressure:	3200 PSI
Rated Water Pressure:	2500 PSI
Rated Water Flow:	9.8 litres per minute LPM (2.6 gallons per minute GPM)
Minimum Inlet Pressure:	30 PSI
Maximum Inlet Pressure:	100 PSI
Pump Type:	Heavy-duty maintenance free axial cam
Thermal Relief Valve:	Included
Detergent Tube with Filter:	3' Siphon tube
Maximum Temperature of Pumped Water:	40°C (104°F)
Engine Power (OHV):	6.5 HP
No Load Speed:	3600 RPM
High Pressure Hose Length:	50' (15 m)
Inlet & Discharge Ports:	13 mm (3/4") standard garden hose connector
Displacement:	196 cc
Net Weight:	35 kg
Oil Type:	SAE 10W-30
Oil Capacity:	0.6 L
Fuel Type:	Unleaded Gasoline
Fuel Tank:	3.2 L

## 10. TROUBLESHOOTING

**NOTE:** If your unit still is not functioning properly once you have used this guide please call the SIMONIZ toll-free service number at 1-866-4SIMONIZ (1-866-474-6664). Please do NOT bring the unit back to the store until you have called this number.

### 10.1 Troubleshooting Engine

Problem	Cause	Solution
Engine doesn't start or difficult to start.	The engine power switch is in the OFF (0) position.	Ensure the switch is in the ON (I) position.
	No fuel.	Fill the fuel tank with regular gasoline.
	Low oil shut down sensor tripped to protect engine.	Add oil until it reaches minimum level on dip stick.
	Excess water pressure in pump or hose.	Release water pressure by squeezing trigger on gun.
	Choke lever not in right position.	When cold starting the engine, set the choke to <b>CLOSE</b> or <b>OFF</b> . When warm starting, set the choke to <b>OPEN</b> or <b>ON</b> or try the middle position.
	Clogged carburetor.	Clean the carburetor. Refer to the instruction manual.
	Carbon build-up on spark plug.	Clean the spark plug. Refer to the instruction manual.
	Incorrect starting method.	Use correct starting method. Refer to the instruction manual.

Problem	Cause	Solution
Engine stops after starting.	Low oil or no fuel.	Check oil and fuel levels.
	Choke lever in the <b>Close</b> position.	Move the choke lever to the <b>Open</b> position immediately after starting the engine.
Engine lacks of power.	Clogged air filter.	Clean or replace the air filter. Refer to the instruction manual.
	Clogged carburetor.	Clean the carburetor. Refer to the instruction manual.
Engine stops while moving or being tiled.	Low oil shut down sensor tripped to protect engine.	Do not tilt the machine past 15° when operating. Check oil level and ensure it is above the minimum level on the dip stick.
Carburetor leaks.	Carburetor is clogged.	Clean the carburetor. Refer to the instruction manual.
Starter rope doesn't recoil.	Recoil mechanism is broken.	Call the Toll-Free Hotline.
Engine sounds abnormal or overloaded.	RPM too low.	Adjust throttle lever to <b>HIGH</b> position.
	Clogged nozzle.	Clean nozzle with tip cleaner.
	Pressure is too high.	Call the Toll-Free Hotline.

## 10. TROUBLESHOOTING (cont.)

### 10.2 Troubleshooting Pump

Problem	Cause	Solution
No pressure, low pressure.	Nozzle tip not attached.	Attach required nozzle tip.
	Water supply faucet closed.	Turn on faucet. Ensure there are no kinks or blockage in hose.
	Water supply pressure is low.	Ensure faucet is fully opened. Check to make sure water supply is a minimum 30 PSI, 4 GPM.
	Inlet water filter is clogged.	Clean the water filter. Refer to the instruction manual.
	Air in pump.	Squeeze trigger to release the air in pump when the machine is running.
	The loaded RPM is not set to <b>FAST</b> .	Set RPM (Throttle lever) to <b>FAST</b> position.
	Clogged check valve.	Call the Toll-Free Hotline.
	Damaged pump.	Call the Toll-Free Hotline.
Pressure too high.	Clogged nozzle.	Clean nozzle with tip cleaner.
Water or oil leaks out of Pump.	Damaged seal ring.	Call the Toll-Free Hotline.
Cold water keeps draining out of thermal relief valve.	Defective thermal relief valve.	Call the Toll-Free Hotline.

### 10.3 Troubleshooting Accessories & Connections

Problem	Cause	Solution
No intake of detergent. <b>(For use of on-board detergent injection system)</b>	The detergent siphon tube is not connected.	Connect detergent siphon tube properly. Refer to the instruction manual.
	Damaged detergent siphon tube.	Replace the detergent siphon tube.
	Wrong nozzle.	Use black nozzle when applying detergent. Refer to the instruction manual.
	Clogged nozzle.	Clean nozzle.
	Clogged pump detergent siphon fitting.	Detach the detergent siphon tube and clean the fitting with tip cleaner.
	Detergent is too thick. Clogged detergent filter.	Use only detergent approved for use with pressure washer.



## 10. TROUBLESHOOTING (cont.)

### 10.3 Troubleshooting Accessories & Connections (cont.)

Problem	Cause	Solution
Detergent is not working. <b>(For use of Foam Blaster)</b>	Detergent container is empty.	Add more detergent.
	Detergent bottle or suction tube not properly connected.	Check connections.
	Detergent is too thick.	Dilute detergent.
	Damaged or clogged detergent suction tube.	Remove obstruction or replace the detergent suction tube.
	The discharge nozzle is obstructed.	Blow out or remove debris with a fine needle.
	Detergent <b>ON/OFF</b> knob at <b>OFF</b> position	Set to <b>ON</b> position.
The trigger can't be squeezed.	Safety lock is not open.	Open the safety lock. Refer to the instruction manual.
High Pressure Hose can't be connected to pump or gun.	The o-ring are not lubricated.	Put lubricating oil or water on the o-ring.

IF YOU ENCOUNTER ANY ADDITIONAL DIFFICULTIES NOT LISTED, VISIT OUR WEBSITE AT

**WWW.SIMONIZ.CA**

OR CALL CUSTOMER SERVICE FOR HELP AT

1-866-4SIMONIZ (1-866-474-6664).

## 11. LIMITED WARRANTY

---

Always keep your receipt as proof of purchase.

We're here to help! If you have any questions or comments, call our toll-free hotline 1-866-4SIMONIZ (1-866-474-6664). Have your serial number ready. The serial number can be found on the back plate, located on the side of the unit.

This product has a Parts Replacement, Product Exchange and/or Repair Warranty only. **NO REFUNDS** will be provided. Please see stores for Product Exchange details.

### **Two (2) Year Warranty — Engine**

Kohler Co. warrants to the original retail consumer that each new engine sold by Kohler Co. will be free from manufacturing defects in materials or workmanship for a coverage period as stated below from the date of purchase, provided it is operated and maintained in accordance with Kohler Co.'s instructions and manuals.

#### To Obtain Warranty Service:

Original retail consumer must bring the engine to an authorized Kohler dealer found by visiting [www.KohlerEngines.com](http://www.KohlerEngines.com) or call 1-800-544-2444 (U.S.A. and Canada). For details, read engine Owners/Operators Manual.

### **Ninety (90) Day Warranty — Accessories**

Trigger gun, hose, spray wands and other accessories are guaranteed for ninety (90) days from the date of purchase. You may purchase accessories directly through place of purchase, or by calling our toll-free hotline 1-866-4SIMONIZ (1-866-474-6664).

This warranty does not cover accidental damage, unreasonable use, normal wear and tear, use of improper detergents, freezing, neglect, or non-compliance with the Operating Instructions. The warranty does not cover loss of use or other consequential damages arising from any of the above, nor does it cover repairs made or attempted by unauthorized persons.

The warranty is void if the equipment is used for commercial, rental or industrial purposes.

If you have further questions, please visit our website ([www.simoniz.ca](http://www.simoniz.ca)) or call 1-866-4SIMONIZ (1-866-474-6664).

### **Imported for**

**Trileaf Distribution Trifeuil, Toronto, Canada M4S 2B8**

# KOHLER® SH Series

## SH265

### Owner's Manual

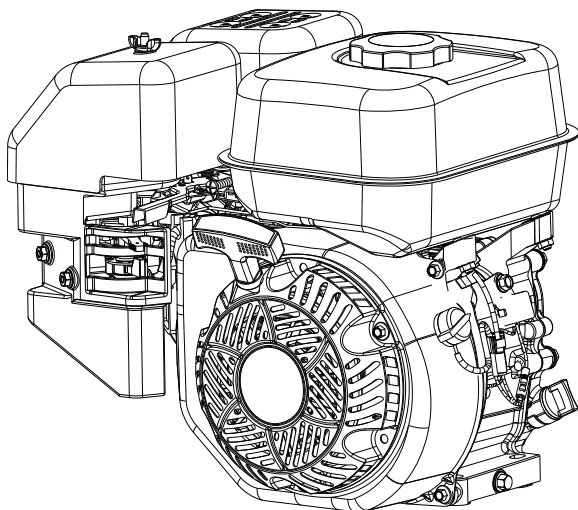

---

**IMPORTANT:** Read all safety precautions and instructions carefully before operating equipment. Refer to operating instruction of equipment that this engine powers.

Ensure engine is stopped and level before performing any maintenance or service.

Warranty coverage as outlined in the warranty card and on KohlerEngines.com. Please review carefully as it provides you specific rights and obligations.

To maintain compliance with applicable emission regulations, exhaust system backpressure may not exceed limits which can be found on KohlerEngines.com. Search by Model No., select Read More, then select Specs tab.

---

Record engine information to reference when ordering parts or obtaining warranty coverage.

Engine Model \_\_\_\_\_

Specification \_\_\_\_\_

Serial Number \_\_\_\_\_

Purchase Date \_\_\_\_\_

## Safety Precautions

**⚠ WARNING:** A hazard that could result in death, serious injury, or substantial property damage.

**⚠ CAUTION:** A hazard that could result in minor personal injury or property damage.

NOTE: is used to notify people of important installation, operation, or maintenance information.

	<b>⚠ WARNING</b> Explosive Fuel can cause fires and severe burns.  Do not fill fuel tank while engine is hot or running.
--	---

Gasoline is extremely flammable and its vapors can explode if ignited. Store gasoline only in approved containers, in well ventilated, unoccupied buildings, away from sparks or flames. Spilled fuel could ignite if it comes in contact with hot parts or sparks from ignition. Never use gasoline as a cleaning agent.

	<b>⚠ WARNING</b> Carbon Monoxide can cause severe nausea, fainting or death.  Avoid inhaling exhaust fumes.
Engine exhaust gases contain poisonous carbon monoxide. Carbon monoxide is odorless, colorless, and can cause death if inhaled.	

	<b>⚠ WARNING</b> Accidental Starts can cause severe injury or death.  Disconnect and ground spark plug lead(s) before servicing.
Before working on engine or equipment, disable engine as follows: 1) Disconnect spark plug lead(s). 2) Disconnect negative (-) battery cable from battery.	

	<b>⚠ WARNING</b> Rotating Parts can cause severe injury.  Stay away while engine is in operation.
--	--

Keep hands, feet, hair, and clothing away from all moving parts to prevent injury. Never operate engine with covers, shrouds, or guards removed.

	<b>⚠ CAUTION</b> Electrical Shock can cause injury.  Do not touch wires while engine is running.
---	---

	<b>⚠ WARNING</b> Hot Parts can cause severe burns.  Do not touch engine while operating or just after stopping.
Never operate engine with heat shields or guards removed.	

### California Proposition 65 Warning

Engine exhaust from this product contains chemicals known to State of California to cause cancer, birth defects, or other reproductive harm.

### California Proposition 65 Warning

This product contains chemicals known to State of California to cause cancer, birth defects, or other reproductive harm.

## Symbols

					
Fuel	Off	On	Choke	Fast	Slow

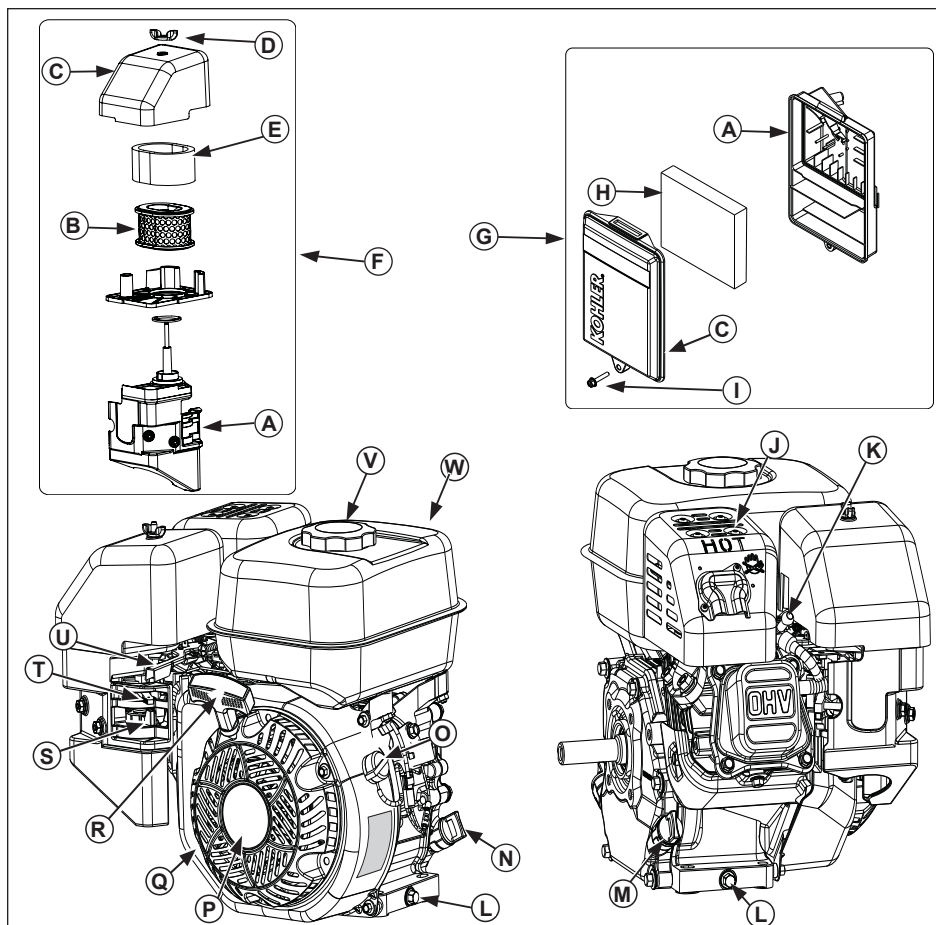



<b>A</b>	Air Cleaner Base	<b>B</b>	Paper Element	<b>C</b>	Air Cleaner Cover	<b>D</b>	Wing Nut
<b>E</b>	Precleaner	<b>F</b>	Dual-Element Air Cleaner	<b>G</b>	Low-Profile Air Cleaner	<b>H</b>	Foam Element
<b>I</b>	Screw	<b>J</b>	Muffler Shield	<b>K</b>	Spark Plug	<b>L</b>	Oil Drain Plug
<b>M</b>	Oil Fill Plug	<b>N</b>	Dipstick	<b>O</b>	On/Off Switch (if equipped)	<b>P</b>	Retractable Starter
<b>Q</b>	Debris Screen	<b>R</b>	Starter Handle	<b>S</b>	Fuel Shut-Off	<b>T</b>	Choke Control
<b>U</b>	Throttle Control	<b>V</b>	Fuel Cap	<b>W</b>	Fuel Tank		

### Pre-Start Checklist

1. Check oil level. Add oil if low. Do not overfill.
2. Check fuel level. Add fuel if low. Check fuel system components and lines for leaks.
3. Check and clean cooling areas, air intake areas and external surfaces of engine (particularly after storage).
4. Check that air cleaner components and all shrouds, equipment covers, and guards are in place and securely fastened.
5. Check spark arrestor (if equipped).

## Starting

	<p><b>⚠ WARNING</b></p> <p>Carbon Monoxide can cause severe nausea, fainting or death. Avoid inhaling exhaust fumes.</p>
<p>Engine exhaust gases contain poisonous carbon monoxide. Carbon monoxide is odorless, colorless, and can cause death if inhaled.</p>	

	<p><b>⚠ WARNING</b></p> <p>Rotating Parts can cause severe injury.</p> <p>Stay away while engine is in operation.</p>
<p>Keep hands, feet, hair, and clothing away from all moving parts to prevent injury. Never operate engine with covers, shrouds, or guards removed.</p>	

**NOTE:** Choke position for starting may vary depending upon temperature and other factors. Once engine is running and warm, turn choke to OFF position.

**NOTE:** Extend starter cord periodically to check its condition. If cord is frayed have it replaced immediately by a Kohler authorized dealer.

**NOTE:** Do not crank engine continuously for more than 10 seconds. Allow a 60 second cool down period between starting attempts. Failure to follow these guidelines can burn out starter motor.

**NOTE:** If engine develops sufficient speed to disengage starter but does not keep running (a false start), engine rotation must be allowed to come to a complete stop before attempting to restart engine. If starter is engaged while flywheel is rotating, starter pinion and flywheel ring gear may clash, resulting in damage to starter.

1. Turn fuel shut-off valve to ON position (if equipped).
2. Turn engine on/off switch to ON position (if equipped).
3. Start engine as follows:

Cold engine: Place throttle control midway between SLOW and FAST positions. Place choke control into ON position.

Warm engine: Place throttle control midway between SLOW and FAST positions. Return choke to OFF position as soon as engine starts. A warm engine usually does not require choke on.

4. Retractable Start: Slowly pull starter handle until just past compression-STOP! Return starter handle; firmly pull straight out to avoid excessive rope wear from starter rope guide.

Electric Start: Activate starter switch. Release switch as soon as engine starts. If starter does not turn engine over, shut off starter immediately. Do not make further attempts to start engine until condition is corrected. Do not jump start. See your Kohler authorized dealer for trouble analysis.

5. Gradually return choke control to OFF position after engine starts and warms up. Engine/equipment may be operated during warm up period, but it may be necessary to leave choke partially on until engine warms up.

## Cold Weather Starting Hints

1. Use proper oil for temperature expected.
2. Disengage all possible external loads.
3. Use fresh winter grade fuel. Winter grade fuel has higher volatility to improve starting.

## Stopping

1. If possible, remove load by disengaging all PTO driven attachments.
2. If equipped, move throttle control to slow or idle position; stop engine.
3. If equipped, close fuel shut-off valve.

## Angle of Operation

Refer to operating instructions of equipment this engine powers. Do not operate this engine exceeding maximum angle of operation; see specification table. Engine damage could result from insufficient lubrication.

## Engine Speed

**NOTE:** Do not tamper with governor setting to increase maximum engine speed. Overspeed is hazardous and will void warranty.

## High Altitude Operation



If this engine is operated at an altitude of 4000 ft. (1219 meters) or above, a high altitude carburetor kit is required. To obtain high altitude carburetor kit information or to find a Kohler authorized dealer, visit [KohlerEngines.com](http://KohlerEngines.com) or call 1-800-544-2444 (U.S. and Canada).

This engine should be operated in its original configuration below 4000 ft. (1219 meters).

Operating this engine with the wrong engine configuration at a given altitude may increase its emissions, decrease fuel efficiency and performance, and result in damage to the engine.



## Maintenance Instructions

	 <b>WARNING</b>	Before working on engine or equipment, disable engine as follows: 1) Disconnect spark plug lead(s). 2) Disconnect negative (–) battery cable from battery.
	Accidental Starts can cause severe injury or death.  Disconnect and ground spark plug lead(s) before servicing.	

Normal maintenance, replacement or repair of emission control devices and systems may be performed by any repair establishment or individual; however, warranty repairs must be performed by a Kohler authorized dealer found at KohlerEngines.com or 1-800-544-2444 (U.S. and Canada).

### Maintenance Schedule

#### After first 5 Hours

- Change oil.

#### Every 50 Hours or Annually

- Service/replace dual-element precleaner.

#### Every 100 Hours or Annually<sup>1</sup>

- Clean low-profile air cleaner element.
- Replace dual-element air cleaner element.
- Change oil.
- Clean cooling areas.
- Clean spark arrestor (if equipped).
- Replace fuel filter (if equipped).

#### Every 100 Hours<sup>2</sup>

- Check and adjust valve clearance when engine is cold.
- Have combustion chamber decarbonized.

#### Every 125 Hours or Annually<sup>1</sup>

- Replace spark plug and set gap.

#### Every 200 Hours<sup>2</sup>

- Replace fuel line.

#### Every 300 Hours

- Replace low-profile air cleaner element.

<sup>1</sup> Perform these procedures more frequently under severe, dusty, dirty conditions.

<sup>2</sup> Have a Kohler authorized dealer perform this service.

### Oil Recommendations

We recommend use of Kohler oils for best performance. Other high-quality detergent oils (including synthetic) of API (American Petroleum Institute) service class SJ or higher are acceptable. Select viscosity based on air temperature at time of operation as shown in table below.

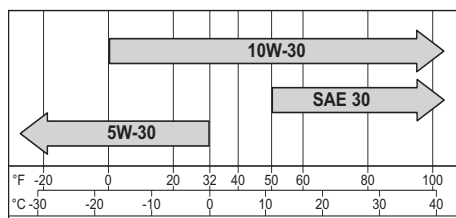

### Check Oil Level

**NOTE:** To prevent extensive engine wear or damage, never run engine with oil level below or above operating range indicator on dipstick.

Ensure engine is cool. Clean oil fill/dipstick areas of any debris.

1. Remove dipstick; wipe oil off.
2. Reinsert dipstick into tube; rest on oil fill neck; turn counterclockwise until cap drops down to lowest point of thread leads; do not thread cap onto tube.
  - a. Remove dipstick; check oil level. Level should be at top of indicator on dipstick.
  - or
  - b. Remove oil fill plug. Level should be up to point of overflowing filler neck.

3. If oil is low, add oil up to point of overflowing filler neck.
4. Reinstall dipstick or oil fill plug and tighten securely.

### Change Oil

Change oil while engine is warm.

1. Clean area around oil fill cap/dipstick and drain plug.
2. Remove drain plug and oil fill cap/dipstick. Drain oil completely.
3. Reinstall drain plug. Torque to 13 ft. lb. (17.6 N-m).
4. Fill crankcase with new oil, up to point of overflowing filler neck.
5. Reinstall oil fill cap/dipstick and tighten securely.
6. Dispose of used oil in accordance with local ordinances.

### Oil Sentry™ (if equipped)

This switch is designed to prevent engine from starting in a low oil or no oil condition. Oil Sentry™ may not shut down a running engine before damage occurs. In some applications this switch may activate a warning signal. Read your equipment manuals for more information.

### Fuel Recommendations

	<p><b>! WARNING</b></p> <p>Explosive Fuel can cause fires and severe burns.</p> <p>Do not fill fuel tank while engine is hot or running.</p>
<p>Gasoline is extremely flammable and its vapors can explode if ignited. Store gasoline only in approved containers, in well ventilated, unoccupied buildings, away from sparks or flames. Spilled fuel could ignite if it comes in contact with hot parts or sparks from ignition. Never use gasoline as a cleaning agent.</p>	

NOTE: E15, E20 and E85 are NOT approved and should NOT be used; effects of old, stale or contaminated fuel are not warrantable.

Fuel must meet these requirements:

- Clean, fresh, unleaded gasoline.
- Octane rating of 87 (R+M)/2 or higher.
- Research Octane Number (RON) 90 octane minimum.
- Gasoline up to 10% ethyl alcohol, 90% unleaded is acceptable.
- Methyl Tertiary Butyl Ether (MTBE) and unleaded gasoline blend (max 15% MTBE by volume) are approved.
- Do not add oil to gasoline.
- Do not overfill fuel tank.
- Do not use gasoline older than 30 days.

### Add Fuel

	<p><b>! WARNING</b></p> <p>Explosive Fuel can cause fires and severe burns.</p> <p>Do not fill fuel tank while engine is hot or running.</p>
<p>Gasoline is extremely flammable and its vapors can explode if ignited. Store gasoline only in approved containers, in well ventilated, unoccupied buildings, away from sparks or flames. Spilled fuel could ignite if it comes in contact with hot parts or sparks from ignition. Never use gasoline as a cleaning agent.</p>	

Ensure engine is cool.

1. Clean area around fuel cap.
2. Remove fuel cap. Fill to base of filler neck. Do not overfill fuel tank. Leave room for fuel to expand.
3. Reinstall fuel cap and tighten securely.

## Fuel Line

Low permeation fuel line must be installed on carbureted Kohler Co. engines to maintain EPA and CARB regulatory compliance.

## Spark Plugs



### CAUTION

Electrical Shock can cause injury.  
Do not touch wires while engine is running.

Clean out spark plug recess. Remove plug and replace.

1. Check gap using wire feeler gauge. Adjust gap, see specification table for adjustment.
2. Install plug into cylinder head.
3. Torque plug to 20 ft. lb. (27 N·m).

## Air Cleaner

**NOTE:** Operating engine with loose or damaged air cleaner components could cause premature wear and failure. Replace all bent or damaged components.

**NOTE:** Paper element cannot be blown out with compressed air.

### Dual-Element

Remove wing nut and air cleaner cover.

Precleaner:

1. Remove precleaner from paper element.
2. Replace or wash precleaner in warm water with detergent. Rinse and allow to air dry.
3. Reinstall precleaner over paper element.

Paper Element:

1. Remove paper element with precleaner.
2. Separate precleaner from element; service precleaner and replace element.
3. Reinstall precleaner over paper element.

Reinstall air cleaner cover and secure with wing nut.

### Low-Profile

1. Remove screw and air cleaner cover.
2. Remove foam element from base.
3. Wash foam element in warm water with detergent. Rinse and allow to air dry.
4. Lightly oil foam element with new engine oil; squeeze out excess oil.
5. Reinstall foam element into base.
6. Reinstall cover and secure with screw.

## Breather Tube

Ensure both ends of breather tube are properly connected.

## Air Cooling



### WARNING

Hot Parts can cause severe burns.

Do not touch engine while operating or just after stopping.

Never operate engine with heat shields or guards removed.

Proper cooling is essential. To prevent over heating, clean screens, cooling fins, and other external surfaces of engine. Avoid spraying water at wiring harness or any electrical components. See Maintenance Schedule.

## Repairs/Service Parts

We recommend that you use a Kohler authorized dealer for all maintenance, service, and replacement parts for engine. To find a Kohler authorized dealer visit [KohlerEngines.com](http://KohlerEngines.com) or call 1-800-544-2444 (U.S. and Canada).

## Storage

If engine will be out of service for 2 months or more follow procedure below.

1. Add Kohler PRO Series fuel treatment or equivalent to fuel tank. Run engine 2-3 minutes to get stabilized fuel into fuel system (failures due to untreated fuel are not warrantable).
2. Change oil while engine is still warm from operation. Remove spark plug(s) and pour about 1 oz. of engine oil into cylinder(s). Replace spark plug(s) and crank engine slowly to distribute oil.
3. Disconnect negative (-) battery cable.
4. Store engine in a clean, dry place.

## Troubleshooting

Do not attempt to service or replace major engine components, or any items that require special timing or adjustment procedures. This work should be performed by a Kohler authorized dealer.

Problem	Possible Cause							
	No Fuel	Improper Fuel	Dirt In Fuel Line	Dirty Debris Screen	Incorrect Oil Level	Engine Overloaded	Dirty Air Cleaner	Faulty Spark Plug
Will Not Start	•	•	•		•	•	•	•
Hard Starting		•	•		•	•	•	•
Stops Suddenly	•		•	•	•	•	•	•
Lacks Power		•	•	•	•	•	•	•
Operates Erratically		•	•	•		•	•	•
Knocks or Pings		•		•		•		•
Skips or Misfires		•	•	•			•	•
Backfires		•	•			•	•	•
Overheats		•	•	•	•	•	•	
High Fuel Consumption						•	•	•

## Engine Specifications

Model	Bore	Stroke	Displacement	Oil Capacity (Refill)	Spark Plug Gap	Maximum Angle of Operation (@ full oil level)*
SH255	2.7 in.	2.1 in.	12 cu. in.	0.63 qt.	0.03 in.	25°
SH265	(68 mm)	(54 mm)	(196 cc)	(0.60 L)	(0.76 mm)	

\*Exceeding maximum angle of operation may cause engine damage from insufficient lubrication.

Additional specification information can be found in service manual at [KohlerEngines.com](http://KohlerEngines.com).

Exhaust Emission Control System for models SH255, SH265 is EM for U.S. EPA, California, and Europe.

Any and all horsepower (hp) references by Kohler are Certified Power Ratings and per SAE J1940 & J1995 hp standards. Details on Certified Power Ratings can be found at [KohlerEngines.com](http://KohlerEngines.com).