

SIMONIZ®

3000 PSI / 2.4 GPM PRESSURE WASHER

MODEL: XG06 / 039-8088-4

Use and Care Guide

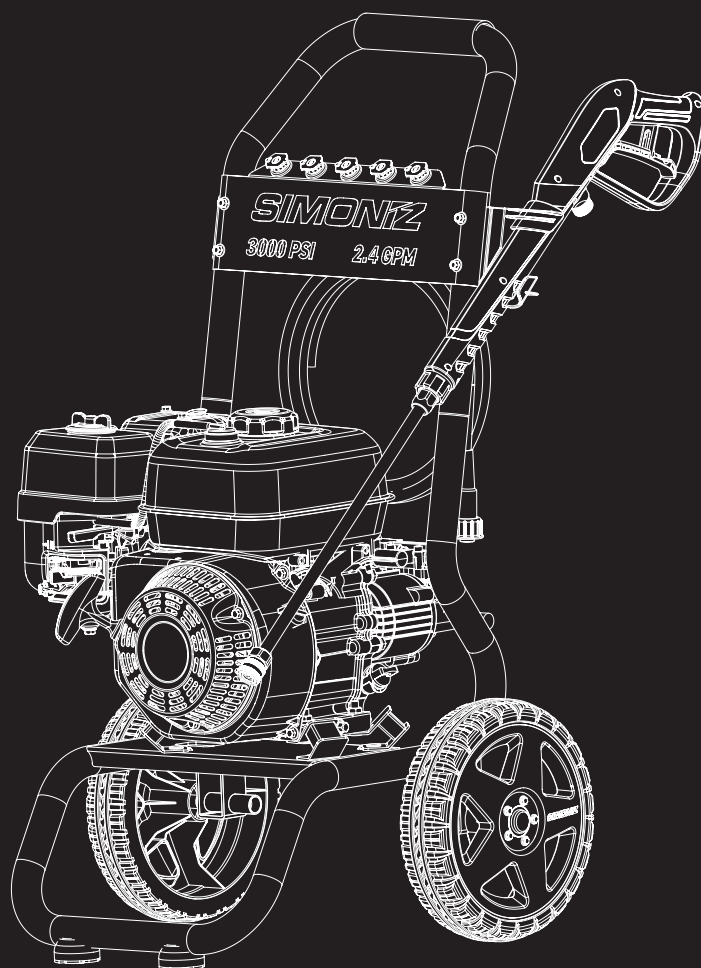

Congratulations on the purchase of your new pressure washer. In order to ensure you have the best possible experience, please read through the following instructions. If you require any help, please contact the customer service department at:

 **1-866-474-6664**

Contact us for assistance; we're here to help.

 **IMPORTANT SAFETY
INSTRUCTIONS: SAVE THESE
INSTRUCTIONS**

Version. 02

Table of Contents

1. Important Precautions	3
1.1 Definitions.....	3
1.2 Safety Warnings	3
2. Intended Applications.....	7
3. Exploded View	8
4. Parts List.....	8
5. Assembly Instructions.....	9
5.1 Surface Preparation.....	9
5.2 Water Supply (Cold Water Only)	9
5.3 Safety Advice	9
5.4 Assembly Steps	9
6. Engine Operation	12
6.1 Adding/Checking Oil	12
6.2 Adding Fuel	13
6.3 Checking Air Filter	13
6.4 Starting Engine.....	14
6.5 Stopping Engine	15
6.6 Working with Detergent	16
6.7 Shutting Down and Cleaning Up	17
7. Cleaning and Maintenance	18
7.1 Cleaning the Spray Tips.....	18
7.2 Cleaning Water Inlet Filter.....	18
7.3 Engine Maintenance	18
7.4 Short Term Storing.....	19
7.5 Long Term Storing.....	19
8. Winterizing and Long-Term Storage	20
8.1 Optimum Winterizing Procedure	20
9. Technical Specifications.....	21
10. Troubleshooting	22
11. Warranty	24
12. Icon Definitions	25

Important Precautions

1. Important Precautions

IMPORTANT, RETAIN FOR FUTURE REFERENCE AND READ CAREFULLY!

Do not attempt to install or operate this device until you have read the safety instructions in this manual. Safety items throughout this manual are labelled with **Danger, Warning, or Caution** depending on the risk type.

Failure to follow or comply with the instruction manual in product set-up, usage or storage will void the warranty.

1.1 Definitions

 This is the safety alert symbol. It is used to alert you to potential personal injury hazards. Obey all safety messages that follow this symbol to avoid possible injury or death.

DANGER

Indicates an imminently hazardous situation which, if not avoided, will result in death or serious injury.

WARNING

Indicates a potentially hazardous situation which, if not avoided, could result in death or serious injury.

CAUTION

Indicates a potentially hazardous situation which, if not avoided, could result in minor or moderate injury.

IMPORTANT

Installation, operation, or maintenance information which is important but not hazard-related.

TOXIC GASES

Alerts against possible toxic gases which can be harmful to your health or deadly if you are exposed to them.

POISONOUS

Alerts against materials/gases which are very poisonous and can cause serious bodily harm or even death.



FLAMMABLE AND COMBUSTIBLE MATERIALS

Alerts against the presence of materials/gases which can be extremely flammable.

1.2 Safety Warnings

DANGER

To reduce the risk of fire, electric shock, explosion or injury to people, read the following:

- This product is intended for domestic, outdoor use only.
- The water spray must never be directed towards any electric wiring, devices, or directly towards the pressure washer itself, or fatal electric shock may occur. 
- The pressure washer should not be used in areas where gas vapours may be present. An electric spark could cause an explosion or fire.
- Risk of explosion. When a combustible liquid is sprayed, there can be danger of fire or explosion, especially in a closed area. Therefore, do not spray flammable liquids. Do not use acids and solvents with this product either. These products can cause physical injuries to the operator and irreversible damage to the device.
- Risk of electric shock. Inspect the cord before using the device — do not use it if the cord is damaged.
- Risk of injury. Do not direct the water flow at people. The high-pressure jet can be dangerous if misused, and therefore must not be directed at people, animals, electrical devices or the unit itself. 
- This device is capable of producing high pressure as rated in the Technical Specifications. To avoid rupture and injury, do not operate this machine with components rated less than the unit itself (including but not limited to spray guns, hose, and hose connections).
- To reduce the risk of injury, close supervision is necessary when the product is used near children.
- Stay alert and watch what you are doing.
- Do not overreach or stand on unstable support. Keep good footing and balance at all times.

1. Important Precautions

1.2 Safety Warnings

DANGER — WORK AREA SAFETY AND EXHAUST FUMES

- Keep work area clean and well lit. Cluttered and dark areas invite accidents.
- Operate the product in a clean, dry and well-ventilated area.
- Do not operate the product in explosive atmospheres, such as in the presence of flammable liquids gases or dust. Power tools create sparks which may ignite the dust or fumes.
- Never operate the product on a steep slope.
- Keep children, pets, and bystanders away from the operating area. Breathing exhaust fumes can cause serious injury or even death.
- Never start or run the engine indoors. The exhaust fumes are dangerous, containing carbon monoxide, an odorless and deadly gas. Operate this product only in a well-ventilated outdoor area.

 **GASOLINE ENGINES PRODUCE TOXIC CARBON MONOXIDE EXHAUST FUMES. BREATHING CARBON MONOXIDE CAN CAUSE NAUSEA, FAINTING, OR DEATH.**

WARNING — INADEQUATE VENTILATION

- Materials placed against or near the product, or operating the product in areas where the ambient temperature exceeds 40°C (104°F) (such as storage rooms or garages) can interfere with its proper ventilation features, causing overheating and possible ignition of the materials or buildings.
- Operate the product in a clean, dry, and well-ventilated area at least 2 m (6') away from any buildings, objects, or walls.
- **NEVER OPERATE THIS PRODUCT INDOORS OR IN POORLY VENTILATED AREAS.**

CAUTION — HOT ENGINE AND MUFFLER

THE ENGINE AND MUFFLER BECOME VERY HOT DURING AND AFTER USE. AVOID TOUCHING THE ENGINE OR THE MUFFLER DURING OR AFTER USE.



WARNING — PERSONAL SAFETY

- Stay alert, watch what you are doing, and use common sense when operating a pressure washer. Do not use a pressure washer while you are tired or under the influence of drugs, alcohol, or medication. A moment of inattention while operating a pressure washer may result in serious personal injury.
- Use safety equipment. Always wear eye protection. Protective equipment such as a dust mask, non-skid safety shoes, a hard hat, or hearing protection used for appropriate conditions will reduce personal injuries.
- Do not use the product if the engine's switch does not turn it on or off. Any gasoline-powered product that cannot be controlled with the engine switch is dangerous and must be repaired.
- Remove any adjusting key or wrench before starting the pressure washer, a wrench or a key left attached to a moving part of the pressure washer may result in personal injury.
- Do not overreach. Do not operate the product while barefoot or when wearing sandals or similar lightweight footwear. Wear protective footwear that will protect your feet and improve your footing on slippery surfaces. Do not stand on the product. Keep proper footing and balance at all times. This enables better control of the product in unexpected situations.
- Dress properly. Do not wear loose clothing or jewellery. Keep your hair, clothing, and gloves away from moving parts. Loose clothes, jewellery, or long hair can get caught in moving parts.
- Do not place your hands or feet near moving parts.
- Do not use while on a ladder.

1. Important Precautions

1.2 Safety Warnings

FLAMMABLE AND POISONOUS MATERIALS

- Gasoline is highly flammable and its vapours can explode if ignited. Take precautions when using fuel to reduce the chance of serious personal injury.
- When refilling or draining the fuel tank, use an approved fuel storage container while in a clean, well-ventilated outdoor area.
- Do not smoke or allow sparks, open flames, or other sources of ignition near the area while adding fuel or operating the product. Never fill fuel tank indoors.
- Equip the operating area with a fire extinguisher certified to handle gasoline or fuel fires.
- Keep grounded conductive objects, such as tools, away from exposed, live electrical parts and connections to avoid sparking or arcing. These events could ignite fumes or vapours.
- Always stop the engine and allow it to cool before filling the fuel tank. Never remove the cap of the fuel tank or add fuel while the engine is running or when the engine is hot. Do not operate the product with known leaks in the fuel system.
- Loosen the fuel tank cap slowly to relieve any pressure in the tank.
- Replace fuel tank and container caps securely and wipe up spilled fuel. Never operate the product without both caps securely in place.
- Avoid creating a source of ignition for spilled fuel. If fuel is spilled, do not attempt to start the engine near spill. Move the product away from the area of spillage and avoid creating any source of ignition until fuel vapours have dissipated.
- Store fuel in containers specifically designed and approved for this purpose.
- Store fuel in a cool, well-ventilated area, safely away from sparks, open flames, or other sources of ignition.
- Never store fuel or product with fuel in the tank inside a building where fumes may reach a spark, open flame, or any other source of ignition, such as a water heater, furnace, clothes dryer, or the like. Allow the engine to cool before storing indoors.

CAUTION-ENGINE SAFETY

- Certain components in this product and its related accessories contain chemicals which are known to cause cancer, birth defects, or other reproductive harm. Wash hands after handling.
- The engine exhaust from this product contains chemicals which are known to cause cancer, birth defects, or other reproductive harm.
- Check fuel lines, tank, cap, and fittings frequently for cracks or leaks. Replace if necessary.
- This engine was shipped without oil. Before you start the engine, make sure you add oil according to the instructions in this manual. If you start the engine without oil, it will be damaged beyond repair and will not be covered under the warranty.
- When starting engine ensure that spark plug, muffler, fuel cap and air filter are in place and secured.
- Do not crank engine with spark plug removed.
- If engine floods, move the throttle control to fast position and crank until engine starts.
- When operating the engine do not tip engine or equipment at an angle which will cause fuel to spill.
- Do not choke the carburetor to stop the engine.
- Never start or run the engine with the air cleaner assembly or the air filter removed.
- Transport or move the product only with empty fuel tank.
- Rapid retraction of starter cord (kickback) will pull hand and arm towards engine faster than you can let go. Risk of injury – broken bones, fractures, bruises, or sprains could result.
- Keep the engine and muffler free of grass, leaves, excessive grease, or carbon build-up to reduce the chance of a fire hazard.
- Do not tamper with any part of the engine to increase its speed.
- If the product makes an unusual noise or vibration, immediately shut off the engine, disconnect the spark plug wire, and check for the cause. Unusual noise or vibration is generally a sign of a problem.
- Use only attachments and accessories approved by the manufacturer. Failure to do so can result in personal injury.

Important Precautions

1. Important Precautions

1.2 Safety Warnings

CAUTION – SPECIFIC SAFETY ADVICE

This product is capable of producing high pressure as rated in the Technical Specifications. To avoid rupture and injury, do not operate this product with components rated less than the unit itself (including but not limited to spray guns, hose, and hose connections).

WARNING – INJECTION HAZARD

- Equipment can cause serious injury if the spray penetrates the skin. Do not point the gun at anyone or any part of the body. In case of penetration, seek medical aid immediately.

CAUTION – DETERGENTS

- This device has been designed for use with detergents that are specifically approved for pressure washer use. The use of other cleaning detergents may affect the operation of the device and void the warranty.

CAUTION – SPRAY GUN

- The spray gun kicks back, so hold it with both hands. The trigger gun safety lock prevents the trigger from being engaged accidentally. However, the safety feature **DOES NOT** lock the trigger in the **ON** position.

IMPORTANT – GROUNDING

- This product must be grounded. If it has a malfunction or breakdown, grounding provides a path of least resistance for electric current to reduce the risk of electric shock. This product is equipped with a cord having an equipment-grounding conductor and a grounding plug. The plug must be plugged into an appropriate outlet that is properly installed and grounded in accordance with all local codes and ordinances.

CAUTION – WATER CONNECTIONS

- For use with fresh and clean water only. Do not use this product with other liquids.
- The water supply system must be protected against backflow.
- Never use this product with water contaminated with solvents (e.g., paint thinners, gasoline, oil, etc.).
- Always prevent debris from being drawn into the product by using a clean water source and an additional water filter, if required.
- If this device is connected to a potable water system, the system must be protected against backflow.
- Suitable water temperature: from 5 to 40°C (41 to 104°F).

CAUTION – USE

- Learn how to stop the device and release the pressure quickly. Familiarize yourself with the controls.
- Keep all connections dry and off the ground.
- Avoid accidental starts. Shut power OFF before connecting or disconnecting the power cord.
- Never carry the pressure washer by the cord.
- Do not pull on the cord to disconnect from the outlet.
- To allow for free air circulation, the pressure washer should not be covered during operation.
- Do not operate the product when tired or under the influence of alcohol or drugs.
- Do not stand on unstable surfaces. Stand with both feet balanced at all times.
- Keep the operating area clear of people and pets.

IMPORTANT – COLD WEATHER START

- Do not operate this pressure washer in temperatures below 5°C (41°F). Operating pressure washer below 5°C (41°F) may cause damage to the pump and other pressure washer parts.

Important Precautions

1. Important Precautions

1.2 Safety Warnings

IMPORTANT — MAINTENANCE

- Any assembly, use or maintenance of the product must be carried out by adults only.
- Follow the maintenance instructions specified in the manual.
- If replacement of the power plug or cord is needed, use only identical replacement parts.
- Repairing and replacing parts should be done by a certified technician.
- Before servicing, cleaning or removal of any parts, shut the power OFF and release the pressure.

CAUTION — SERVICE

- Before cleaning, repairing, inspecting, or adjusting, shut off the engine and make sure that all moving parts have stopped.
- Have your product serviced by certified repair personnel using only identical replacement parts. This ensures the safety of the product is maintained.
- Ensure proper maintenance. Check for misalignment or binding of moving parts, breakage of parts and other conditions that may affect the product's operation. If damaged, have the product repaired before use. Many accidents are caused by poorly maintained equipment.

IMPORTANT — SAFETY FEATURES

Thermal Relief Valve: Protects the pump from overheating in case the nozzle gets clogged. This system should not be abused. Make sure the pump does not overheat.

Low-Oil Auto Shut-Off: Protects the engine and prevents operating without proper lubrication. If the engine oil level goes below the recommended level, the pressure washer shuts off automatically.

CAUTION — PREVENT PUMP DAMAGE

- Do not run the engine for more than 5 minutes without pressing the wand trigger or damage to the pump might occur.
- Never let the engine run unless the product is connected to a water supply. Ensure water is running through the pressure washer before attempting to start the engine.
- Never run caustic fluids or acid through this product.

IMPORTANT — STORAGE

- Store the product in a well-ventilated area, with an empty fuel tank. Fuel should never be stored or placed near the product.
- When storing the product for winter, ensure that it is stored indoors (at room temperature), in a dry location away from any heat or ignition sources.
- If the product is to be stored with fuel in the fuel tank, add a fuel stabilizer (038-0907-6) to keep the gas from breaking down.
- To protect and extend the life of the product when storing it, use an antifreeze agent (039-8602-0) for the pump, which can be found at your local Canadian Tire store.

2. Intended Applications

This product is designed for specific residential applications. Do not modify or use this product for any application other than the one it was designed for. This equipment was not designed for industrial use. Please refer to the icons below for suggested applications. For questions regarding other uses, please refer to our website at www.simoniz.ca or call us at 1-866-474-6664.

IMPORTANT — APPLICATIONS



STAIRS



LAWN EQUIPMENT



VEHICLE



FENCING



DECK OR PATIO



GARAGE FLOOR



DRIVEWAY



SECOND
STOREY



SIDING



FARM
EQUIPMENT



PAINT
PREP

IMPORTANT SAFETY INSTRUCTIONS: SAVE THESE INSTRUCTIONSS

Exploded View / Parts List

3. Exploded View

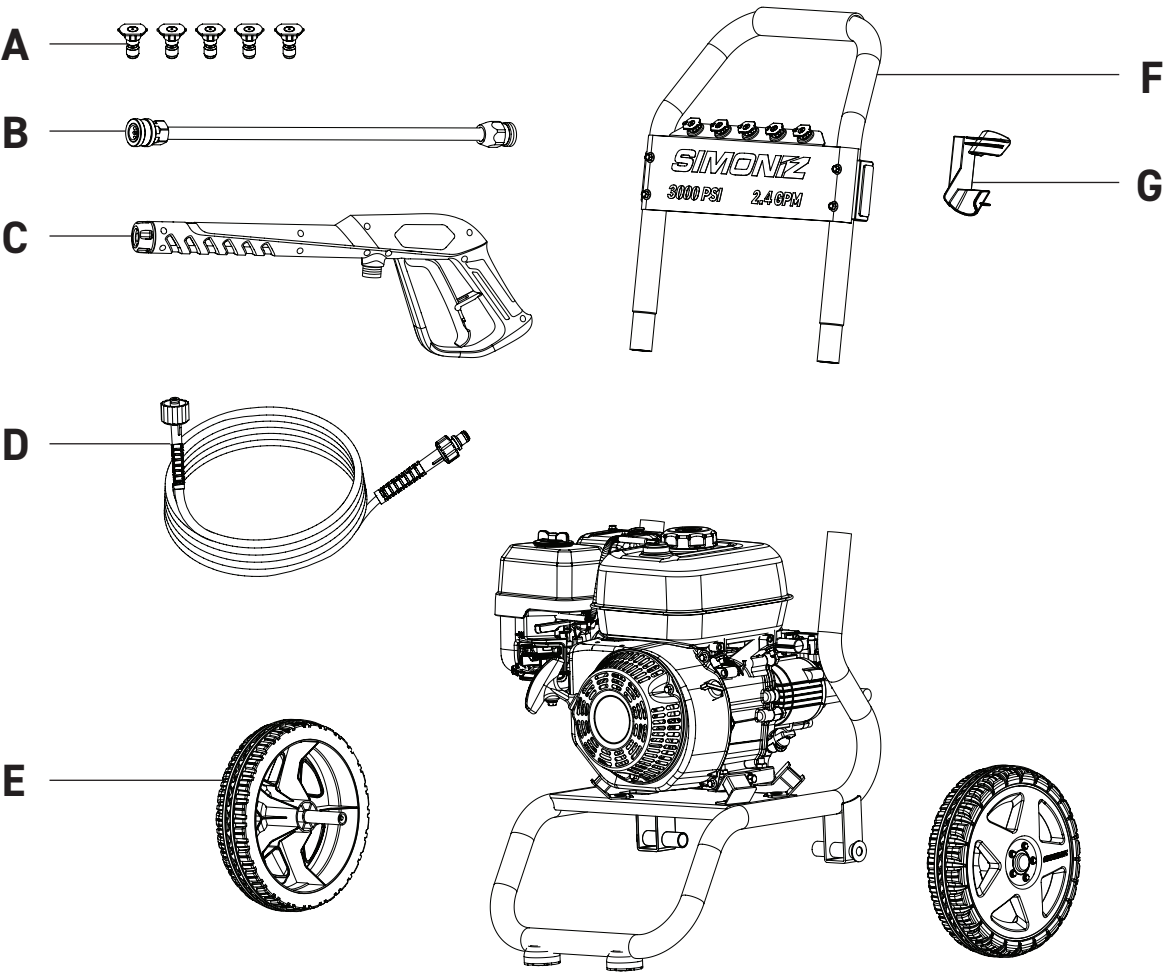

4. Parts List

Item #	Part Name	Qty.	Part #
A	Project Tips (x5)	1 set	XG06-050-0003
B	Quick-connect Wand	1	XG03-020-0002
C	Gun Assembly	1	UG01-020-0003
D	Pressure Hose	1	XG02-050-0004
E	Wheel Set	2	VE30-050-0000
F	Handle Set	1	XG06-030-0000
G	Gun Holder	1	XG06-030-0002
N/A	Water Filter	1	Pre-attached on the machine
N/A	Cleaning Needle	1	Pre-attached on the manual

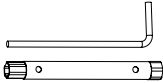
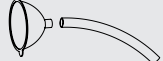
Part Name	Diagram	Qty.
Spark Plug Wrench		1
Engine Oil Funnel		1

* Water filter comes pre-attached on the machine.

Assembly Instructions

5. Assembly Instructions

5.1 Surface Preparation

Before beginning any cleaning task, it is important to inspect the area for objects that could create a hazard. Remove any objects from the work area that could be tripped over, such as toys or outdoor furniture. Ensure that all doors and windows are closed tightly.

5.2 Water Supply (Cold Water Only)

Only draw water through the unit. The device must be used with cold water supply only. The water hose must be at least 13 mm (1/2") in diameter. The water flow rate must not fall below 4.8 GPM (18 LPM). The flow rate can be determined by running water for one minute into an empty container. The water supply temperature must not exceed 40°C (104°F).

5.3 Safety Advice

CAUTION

- Never use the pressure washer to draw in water contaminated with solvents (e.g., paint thinners, gasoline, oil, etc.).
- Dirt in the water inlet will damage the unit. To avoid this risk, we recommend checking the water filter (located inside the water inlet. To clean it out, refer to the Cleaning and Maintenance section).
- Always prevent debris from being drawn into the unit by using a clean water source and an additional accessory water filter, if required.
- To prolong the life of the unit, let it rest for 5 minutes after every 30 minutes of use.
- Check to make sure you have all the parts.

5.4 Assembly

1

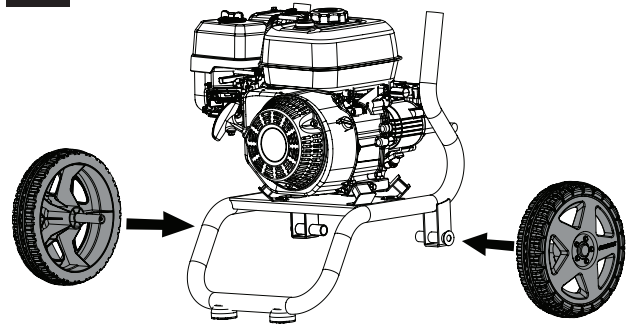

Install the wheel onto the wheel receptacle by pressing shaft pin and align the pin to the hole on the receptacle.

2

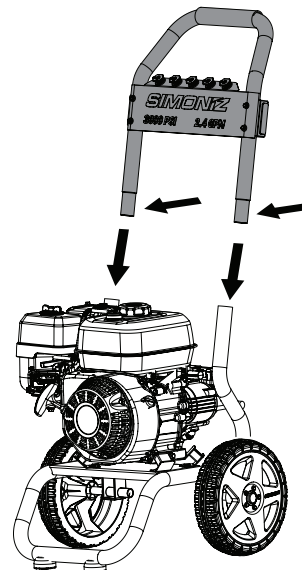

Install the handle assembly to the cart by pressing the pin on the tube and align the pin to the hole in the cart tube.

Assembly Instructions

5. Assembly Instructions

3

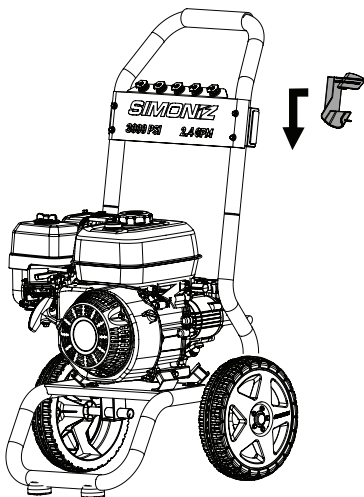

Attach the gun holder.

4

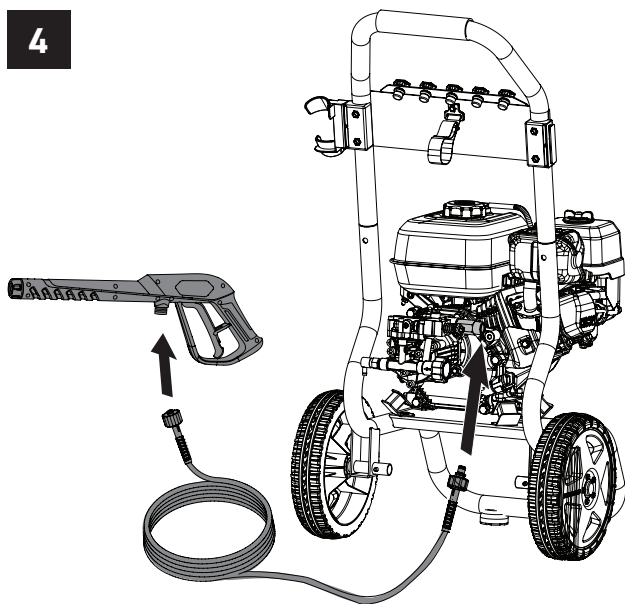

Connect the pressure hose to the pump outlet and the gun connector respectively.

5

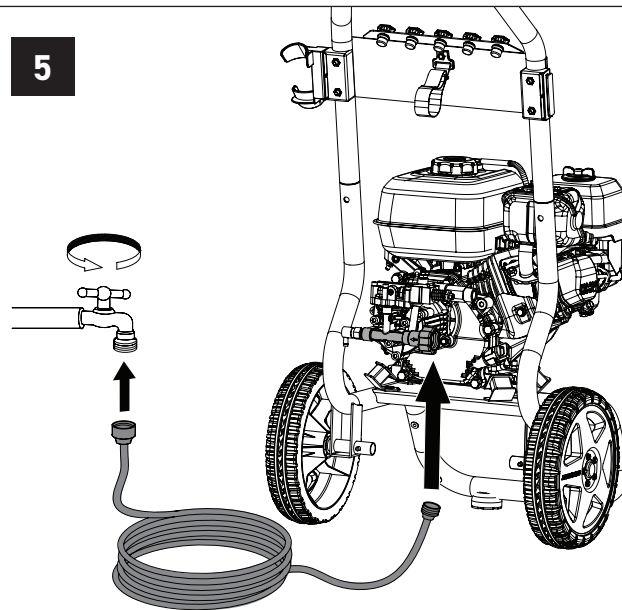

Connect the garden hose to the pump inlet and the water supply respectively, then turn the water on.

Assembly Instructions

5. Assembly Instructions

6

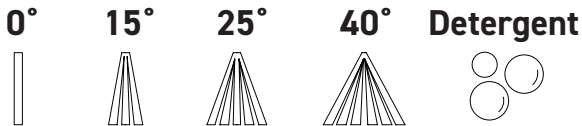
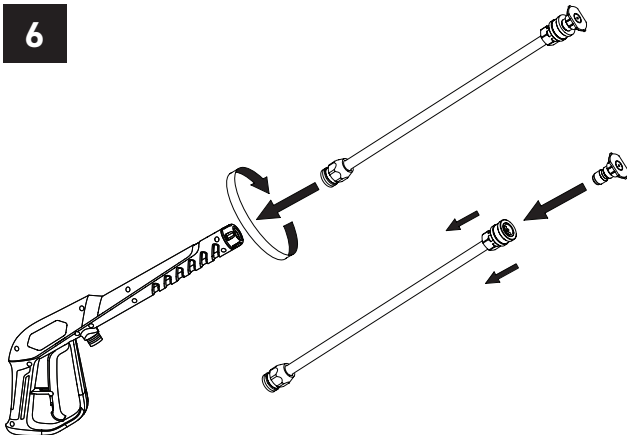

To install tip, gently slide the collar back before inserting it, then release the collar to lock the tip.

Attach the desired spray tip to the wand. The spray tips are for the following purposes:

0° (Red): For tough spots and grimes (e.g., concrete surfaces).

15° (Yellow): For medium- and heavy-duty cleaning tasks (e.g., driveway).

25° (Green): For general cleaning around the house (e.g., patio furniture, decks siding).

40° (White): For light-duty jobs (e.g., stucco walls, glossy surfaces).

Detergent (Black): For detergent cleaning only.

7

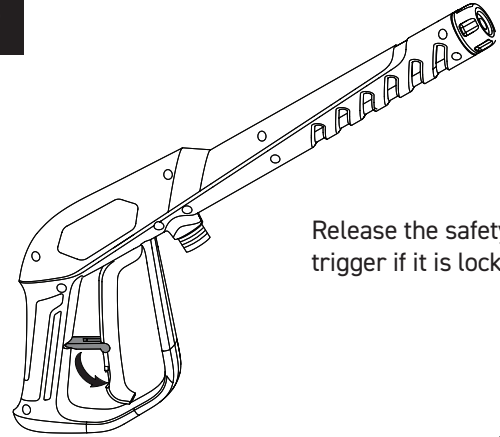

PURGING

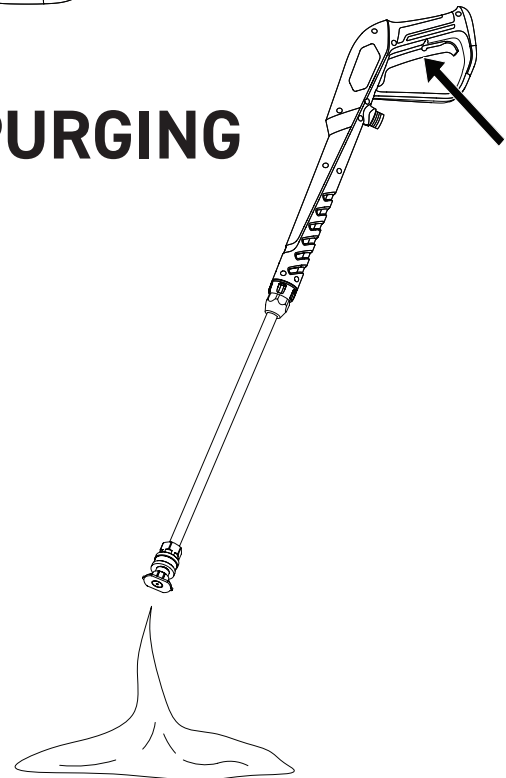

Purge air by squeezing the trigger on the gun until there is a steady stream of water

CAUTION

Drain unit after each use (for storage): remove water connection, turn ON the machine for a few seconds and press gun trigger to drain remaining water in the pump. Turn OFF immediately.

Engine Operation

6. Engine Operation

6.1 Adding/Checking Oil

➡ IMPORTANT

Oil has been drained for shipping. Failure to fill engine with oil before starting engine will result in permanent damage and will void engine warranty. Add oil according to the instructions.

➡ IMPORTANT — Before each use

- Check the oil and fuel level and fill if necessary.
- Make sure that the spark plug, muffler, fuel cap, and air filter are in place and secured.
- Do not crank engine with spark plug removed.

⚠ WARNING

- Always check the oil level before starting the engine, making sure the pressure washer is on a level surface.
- Always use oil type SAE 10W-30, which can be found at your local Canadian Tire store (028-9301-6).

TIP: When adding oil use provided oil funnel.

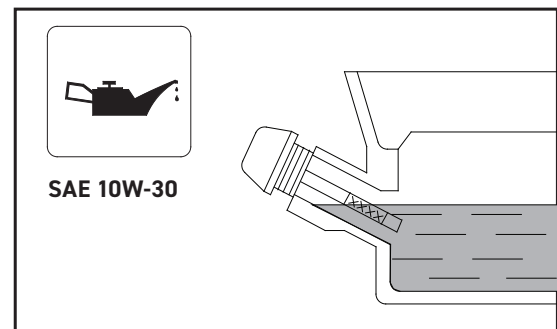
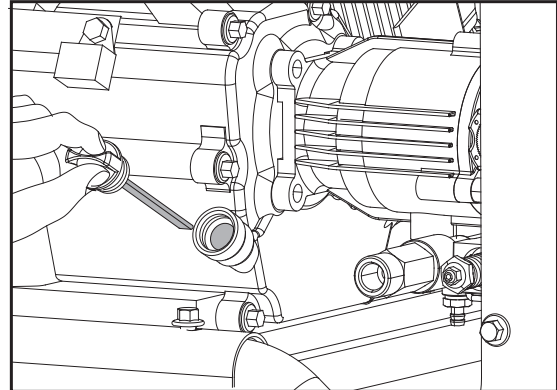

Engine Oil Reservoir Capacity: 600 mL

1. Remove oil tank dipstick and wipe it with a clean cloth.
2. Replace and retighten the dipstick .
3. Remove the dipstick again and check the oil level. It should be at the top of the full indicator on the dipstick.
4. If low, add oil slowly into the oil tank. Do not overfill. After adding oil, wait one minute and then recheck the oil level.
5. Replace and retighten the dipstick.

Always check engine oil level before starting.

Engine oil level should be up to point of overflowing filler neck (600 mL).

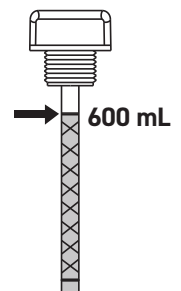

Engine Operation

6. Engine Operation

6.2 Adding Fuel

WARNING

- Make sure there is enough fuel in the fuel tank before operating the pressure washer.
- Use only clean, fresh, unleaded fuel. Use a minimum of 87 octane/87 AKI (91 RON).
- Do not use old gas, and do not mix oil with gasoline.
- Fuel and its vapours are extremely flammable and explosive. Fire or explosion can cause severe burns or death.

IMPORTANT — Before each use

- Keep fuel away from sparks, open flames, pilot lights, heat, and other ignition sources.
- Check fuel hoses, tank, caps, and fittings for cracks or leaks. Replace if necessary.
- If fuel spills, wait until it evaporates before starting engine.
- Fill the fuel tank outdoors or in well-ventilated area.

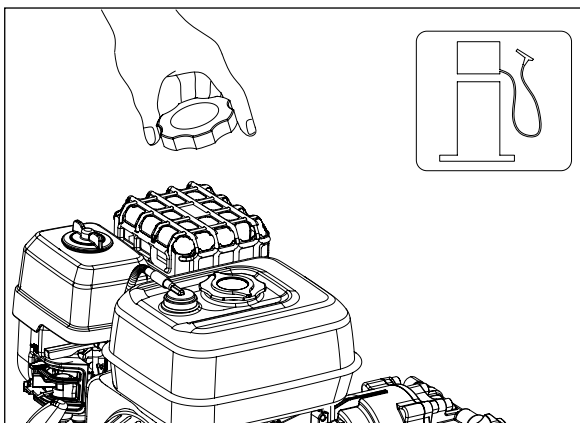

1. Stop the engine (see page 15: Stopping) and let it cool at least 2 minutes before removing the fuel tank cap.
2. Clean the fuel cap area of dirt and debris. Remove the fuel tank cap and make sure the fuel filter is in place.
3. Fill the fuel tank with fuel. Never overfill the fuel tank. Fill tank to no more than 13 mm (1/2") below the bottom of the filler neck to provide space for expansion caused by the engine heat. To allow for expansion of the fuel, do not fill above the bottom of the fuel tank neck.
4. Reinstall the fuel tank cap.

6.3 Checking Air Filter

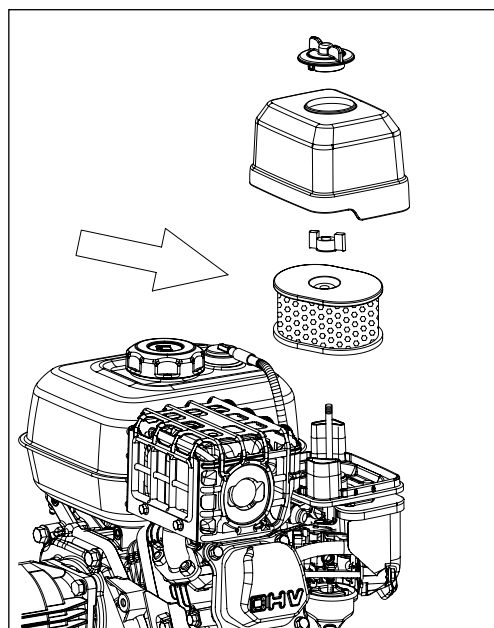

Detach air cleaner cover, unscrew the wingnuts, then pull out the foam element carefully. Wash it with clean water. Next, soak the foam element in the engine oil, then squeeze the oil out by hand. Place the foam element back and lock air cleaner cover.

IMPORTANT

- Clean air filter element for every 50 hours of use (every 10 hours under dusty conditions). Wash in high flashpoint solvent, squeeze dry, dip in clean engine oil, and squeeze out excess oil.

Engine Operation

6. Engine Operation

6.4 Starting Engine

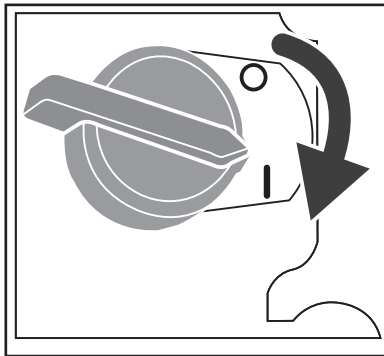

1. Set the engine I/O switch to **ON (I)** position.

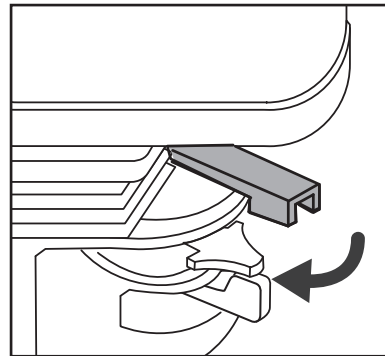

2. Move the throttle control to **LEFT** position.

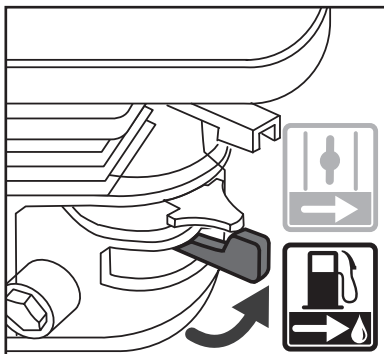

3. Move the fuel valve to **RIGHT** position

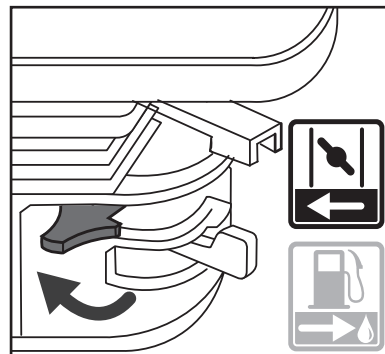

4. Move the choke lever to **LEFT** position.

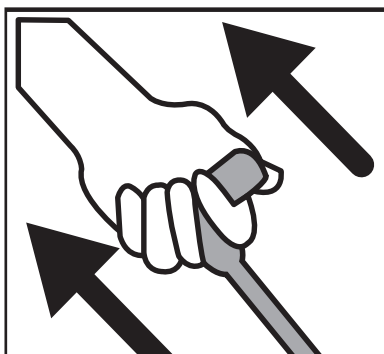

5. Pull the recoil starter grip to start the engine.

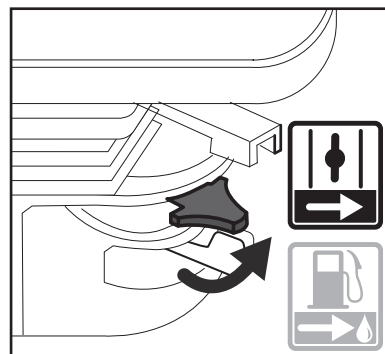

6. Once engine starts up, move the choke lever to the **RIGHT** position.

CAUTION

Return the recoil starter grip gently to its starting position to prevent damage to the starter or the housing.

Engine Operation

6. Engine Operation

6.5 Stopping Engine

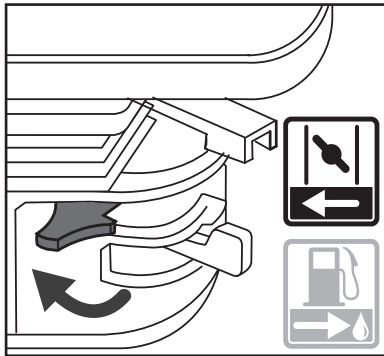

1. To stop the engine move the choke lever to the **LEFT** position.

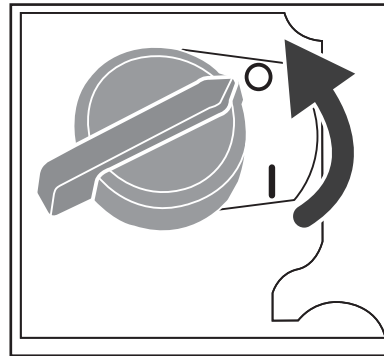

3. Set the engine I/O switch to **OFF (O)** position.

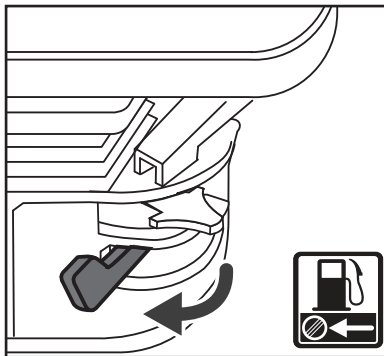

2. Move the fuel valve to **LEFT** position.

IMPORTANT

Restarting the engine after running it for over 5 minutes, place the choke lever to **RIGHT** position to restart the engine.

Engine Operation

6. Operating Instructions

6.6 Working with Detergent

Working with a detergent ensures quick soaking of the dirt, and allows the high-pressure water to penetrate and remove the dirt more effectively. Always spray detergent on a dry surface; do not pre-soak the area. Wetting the surface first dilutes the detergent and reduces its cleaning ability.

→ IMPORTANT

This pressure washer is intended for use with special pressure washer detergents only. Do not use powdered soaps, which would clog the injection system. Follow the detergent manufacturer's directions or call the Simoniz® toll-free number at 1-866-4SIMONIZ (1-866-474-6664) if you have any questions or concerns.

→ IMPORTANT

Working with a detergent ensures quick soaking of the dirt, and allows the high-pressure water to penetrate and remove the dirt more effectively. Always spray detergent on a dry surface, do not presoak the area. Soaking the surface dilutes the detergent and reduces its cleaning ability.

⚠ CAUTION

Damage may occur to painted surfaces if chemicals (detergents) are allowed to dry on them. Wash and rinse a small section at a time. Avoid working on hot surfaces or under direct sunlight.

1

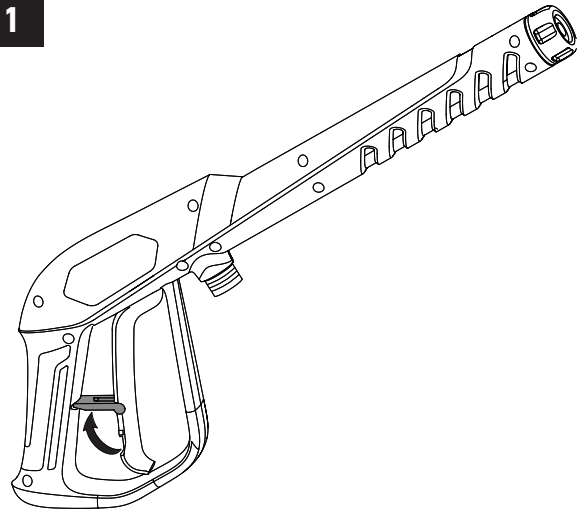

Engage the safety lock on the spray gun.

2

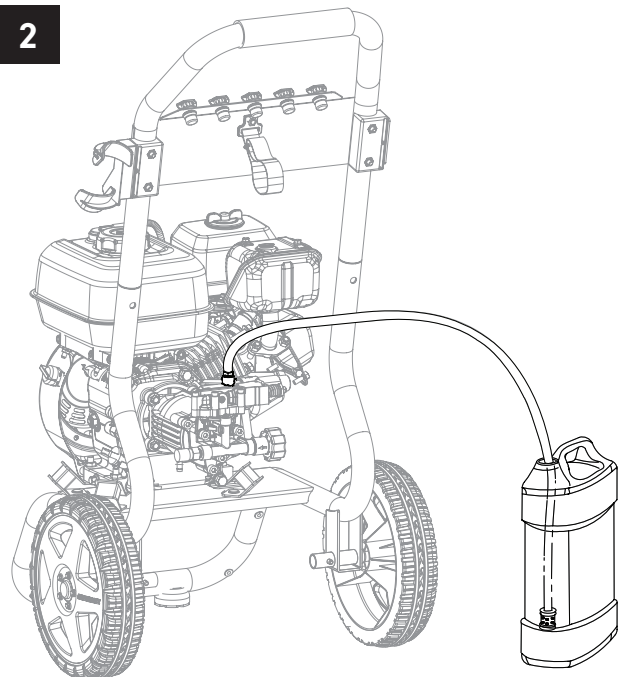

Insert the detergent injection tube into any pressure washer detergent container of your choice. The pump will draw the detergent and mix it with the water automatically, before discharging through the detergent nozzle at a low pressure.

Engine Operation

6. Operating Instructions

6.7 Shutting Down and Cleaning Up

1	Turn off water supply and disconnect the garden hose from the water inlet on the pressure washer.
2	Pull the trigger to release any remaining water pressure.
3	Set the ON/OFF switch to the OFF position.
4	Engage the safety lock on the spray gun.

WARNING

Turn off the water supply and pull the trigger to depressurize the device. Failure to do so might result in personal injury due to discharge of high-pressure water.

Taking Breaks

If taking a five minute or longer break while using the pressure washer:

1	Engage the safety lock on the spray gun.
2	Set the ON/OFF switch to the OFF position.

CAUTION

Failure to clean this product properly will cause the detergent injection system to become clogged and inoperable.

WARNING

Never use:

- Bleach, chlorine products or other corrosive chemicals
- Liquids containing solvents (i.e., paint thinners, gasoline, oils, etc.)
- Tri-sodium phosphate products
- Ammonia products
- Acid-based products

These chemicals will harm the unit and will damage the surface being cleaned.

Cleaning and Maintenance

7. Cleaning and Maintenance

7.1 Cleaning the Spray Tips

⚠ CAUTION

Clogging of the spray tip increases the water pressure and might damage the pump unit.

Clean the spray tip by carefully inserting the provided spray tip cleaner, or a thin, sharp object (e.g., paper clip) into the tip to remove deposits.

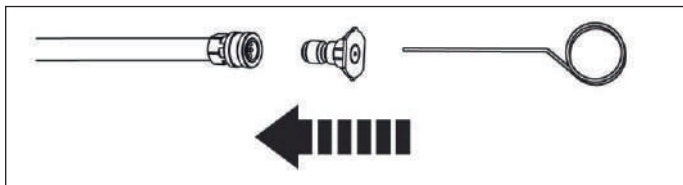

7.2 Cleaning Water Inlet Filter

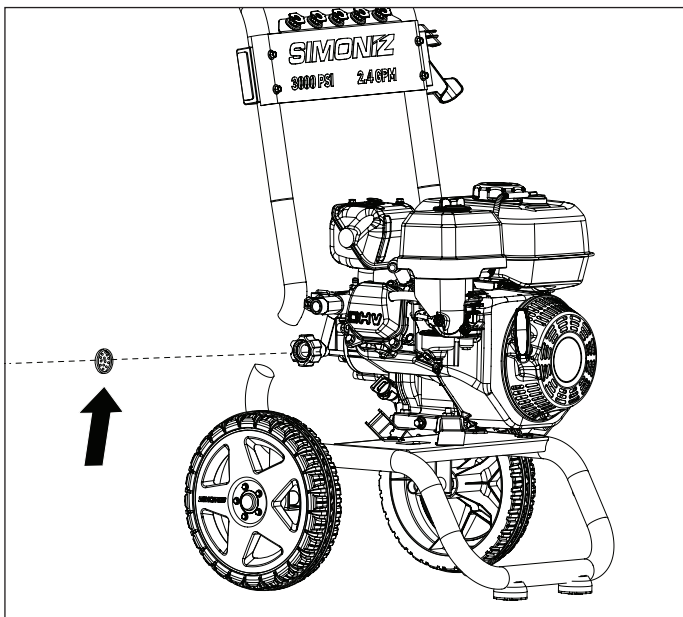

- This pressure washer is equipped with a water inlet filter.
- The water inlet filter must be kept clean at all times; otherwise, it can restrict the water flow to the pump unit and damage it.
- Remove and clean the water inlet filter.

7.3 Engine Maintenance

Draining Engine Oil

The engine oil should be replaced after the first 20 hours of operation, or after the first month of use. After that, it should be replaced every 100 hours or every 6 months.

To drain the engine oil:

1. Loosen the oil tank dipstick.
2. Place an oil container underneath the opening on the main frame.
3. Remove the oil plug and drain the oil.
4. Once the oil has been completely drained, retighten the hex screw and oil tank dipstick.

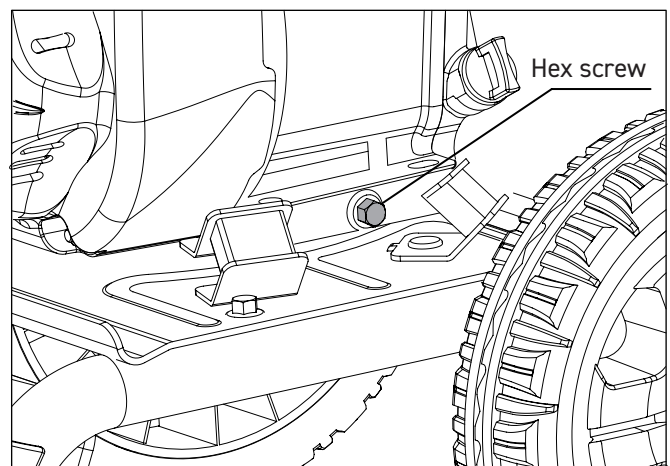

Recommended Engine Oil

Add oil as described on page 11: Adding/Checking Oil.

➡ IMPORTANT

Used oil is a hazardous waste product and must be disposed of properly. Do not discard with household waste. Check with your local authorities, service centre, or Canadian Tire for safe disposal / recycling facilities.

Inspecting, Replacing or Cleaning the Spark Plug

The spark plug should be checked every 100 hours of operation or every 6 months.

To replace or clean the spark plug:

1. Disconnect the spark plug wire by pulling it off the spark plug.

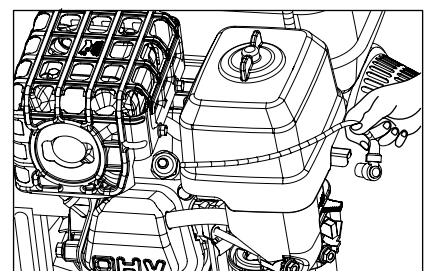

Cleaning and Maintenance

7. Cleaning and Maintenance

7.3 Engine Maintenance (cont.)

2. Using provided spark plug wrench, remove the spark plug by turning it counter-clockwise. If there is a carbon sediment build-up, remove it. If there is too much carbon sediment, replace the spark plug.

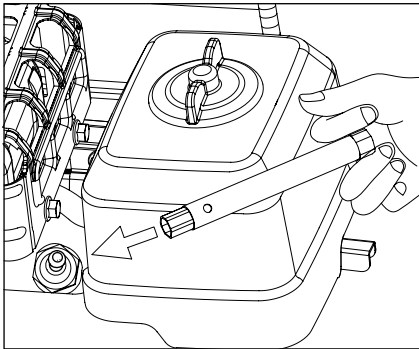

3. Check the gap with a wire gauge. If necessary, reset the gap to 0.7 – 0.8 mm. Install and tighten the spark plug to the recommended torque: 180 in-lb (20 Nm).

4. Reinstall the spark plug wire and protection cage in reverse order.

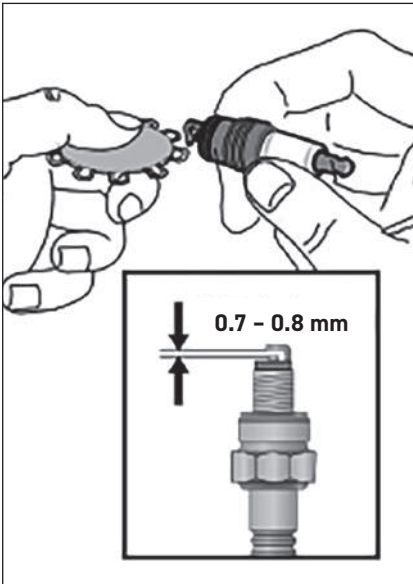

NOTE: In some areas, local law requires using a resistor spark plug to suppress ignition signals. If this engine was originally equipped with a resistor spark plug, use the same type for replacement.

7.4 Short Term Storing

Store idle product out of the reach of children and do not allow persons unfamiliar with the product or these instructions to operate it. This product is dangerous in the hands of untrained users. Cover and store indoors, in a dry, well-ventilated area, such as a tool-shed.

7.5 Long Term Storing

Long term storage of the pressure washer requires additional preventive measures to protect it against deterioration.

1. Drain Fuel

Move the fuel valve to OFF position and remove the hex screw from the carburetor. Then, move the fuel valve to ON position to drain the fuel from the tank, carburetor, and hose. Screw the carburetor drain hex screw back once the fuel has been completely drained.

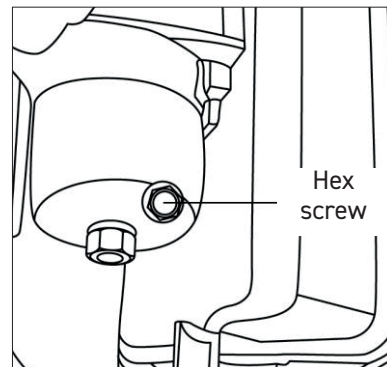

2. Add Fuel Stabilizer

If you do not wish to drain the fuel tank, add a fuel stabilizer (038-0907-6) into the fuel tank. Run the engine at least five minutes after adding the stabilizer to distribute it inside the fuel system.

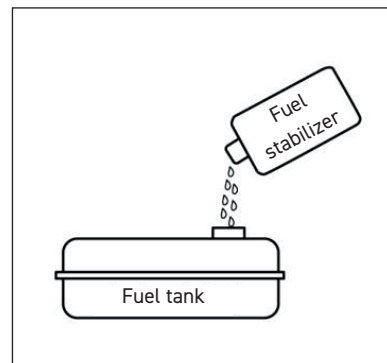

Winterizing

7. Cleaning and Maintenance

7.5 Long Term Storing (cont.)

3. Drain Oil

- Drain the oil following the "To Drain the Engine Oil" instructions on page 18.
- Remove the spark plug.
- Pour one tablespoon of oil through the spark plug hole—type 10W30.
- Make sure the engine I/O switch is set to 0 position. Slowly pull the starter cord handle until you feel tension, which indicates the piston is on its compression stroke and leave it in this position.
- Replace the spark plug.

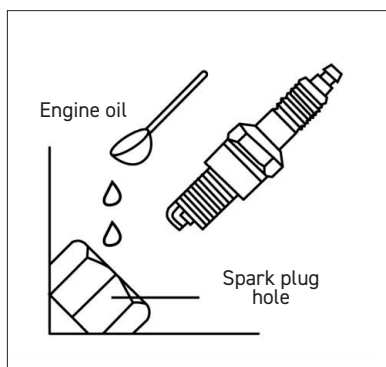

➔ IMPORTANT

- If the pressure washer is to be stored with gasoline in the fuel tank and carburetor, it is important to reduce the hazard of gasoline vapour ignition.
- Select a well-ventilated storage area away from any appliance that operates with a flame, such as a furnace, water heater, or clothes dryer. Also avoid any area with a spark-producing electric motor, or where power tools are operated.
- If possible, avoid storage areas with high humidity, because that promotes rust and corrosion.
- Place the pressure washer on a level surface. Tilting can cause fuel or oil leakage.
- Do not use plastic sheets as a dust cover. A non-porous cover will trap moisture around the pressure washer, promoting rust and corrosion.

8. Winterizing and Long-Term Storage

8.1 Optimum Winterizing Procedure

Winterizing your pressure washer will help protect and prolong its life. We strongly recommend you follow the below steps using a pressure washer antifreeze before storing for the winter. This will keep the internal parts lubricated, protected from rust, and prevents the pump from freezing.

- Connect the pressure washer antifreeze to the inlet adaptor.
- Depress button on top of the pump saver container.
- Continue until fluid exits the pressure hose.
- Remove the hose from pump inlet.

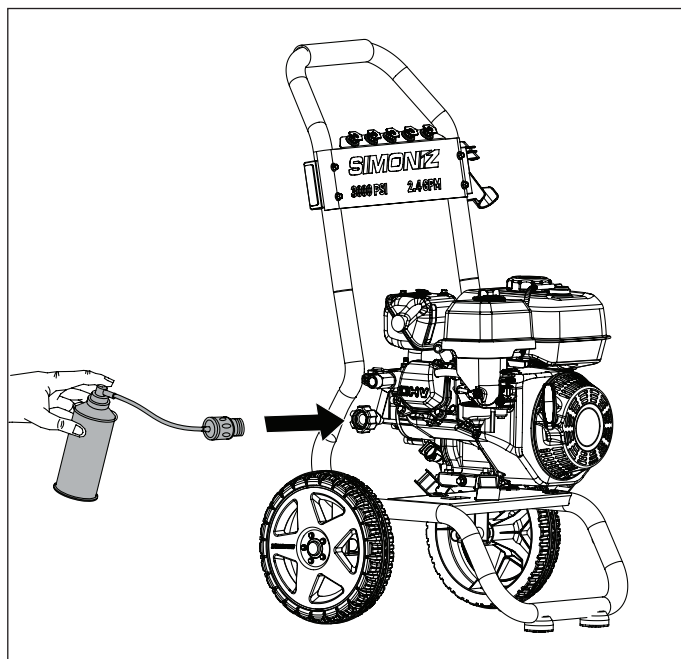

⚠ WARNING

Flush the pressure washer unit out with clear water before reusing. Antifreeze can damage the paintwork and product, so you must ensure there is no antifreeze left in product system before using it again.

Technical Specifications

9. Technical Specifications

Peak Pressure:	3000 PSI
Rated Max. Pressure:	2700 PSI
Rated Water Flow:	2.4 GPM (9.0 LPM)
Minimum Inlet Pressure:	30 PSI
Maximum Inlet Pressure:	100 PSI
Pump Type:	Heavy-duty maintenance-free axial
Thermal Relief Valve:	Included
Maximum Temperature of Pumped Water:	40°C (104°F)
Engine Power (OHV):	6.5 HP
No Load Speed:	3800 RPM
High Pressure Hose Length:	30' (9.1 m)
Inlet and Discharge Ports:	3/4" (11.5 TPI) standard garden hose connector
Displacement:	196 cc
Engine Oil Type:	SAE 10W-30
Oil Capacity:	0.6 L
Fuel Type:	Unleaded gasoline
Fuel Tank:	2.6 L

Troubleshooting

10. Troubleshooting

Disconnect the device from the power source before making any repairs.

Problem	Cause	Solution
Engine doesn't start or difficult to start.	The engine power switch is in the OFF (0) position.	Ensure the switch is in the ON (I) position.
	No fuel.	Fill the fuel tank with regular gasoline.
	Low oil shut down sensor tripped to protect engine.	Minimum of 600 mL in order for the engine to start.
	Excess water pressure in pump or hose.	Release water pressure by squeezing trigger on gun.
	Choke lever not in right position.	When cold starting the engine, set the choke to LEFT or OFF. When warm starting, set the choke to RIGHT or ON, or try the middle position.
	Clogged carburetor.	Clean the carburetor. Refer to the instruction manual.
	Carbon build-up on spark plug.	Clean the spark plug. Refer to the instruction manual.
	Incorrect starting method.	Use correct starting method. Refer to the instruction manual.
Engine stops after starting.	Low oil or no fuel.	Check oil and fuel levels.
	Choke lever in the LEFT position.	Move the choke lever to the RIGHT position immediately after starting the engine.
Engine lacks of power.	Clogged air filter.	Clean or replace the air filter. Refer to the instruction manual.
	Clogged carburetor.	Clean the carburetor. Refer to the instruction manual.
Engine stops while moving or being tiled.	Low oil shut down sensor tripped to protect engine.	Do not tilt the machine past 15° when operating. Check oil level and ensure it is above the minimum level on the dip stick.
Carburetor leaks.	Carburetor is clogged.	Clean the carburetor. Refer to the instruction manual.
Starter rope doesn't recoil.	Recoil mechanism is broken.	Call the toll-free hotline: 1-866-474-6664
Engine sounds abnormal or overloaded.	RPM too low.	Adjust throttle lever to LEFT position.
	Clogged nozzle.	Clean nozzle with tip cleaner.
	Pressure is too high.	Call the toll-free hotline: 1-866-474-6664
No pressure; low pressure.	Nozzle tip not attached.	Attach required nozzle tip.
	Water supply faucet closed.	Turn on faucet. Ensure there are no kinks or blockage in hose.
	Water supply pressure is low.	Ensure faucet is fully opened. Check to make sure water supply is a minimum 30 PSI, 4 GPM.
	Inlet water filter is clogged.	Clean the water filter. Refer to the instruction manual.
	Air in pump.	Squeeze trigger to release the air in pump when the machine is running.
	The loaded RPM is not set to FAST.	Set RPM (Throttle lever) to LEFT position.
	Clogged check valve.	Call the toll-free hotline: 1-866-474-6664
	Damaged pump.	Call the toll-free hotline: 1-866-474-6664
Pressure too high.	Clogged nozzle.	Clean nozzle with tip cleaner.
Water or oil leaks out of pump.	Damaged seal ring.	Call the toll-free hotline: 1-866-474-6664
Cold water keeps draining out of thermal relief valve.	Defective thermal relief valve.	Call the toll-free hotline: 1-866-474-6664

Troubleshooting

10. Troubleshooting

Disconnect the device from the power source before making any repairs.

Problem	Cause	Solution
No intake of detergent. (For use of on-board detergent injection system.)	The detergent siphon tube is not connected.	Connect detergent siphon tube properly. Refer to the instruction manual.
	Damaged detergent siphon tube.	Replace the detergent siphon tube.
	Wrong nozzle.	Use black nozzle when applying detergent. Refer to the instruction manual.
	Clogged nozzle.	Clean nozzle.
	Clogged pump detergent siphon fitting.	Detach the detergent siphon tube and clean the fitting with tip cleaner.
	Detergent is too thick. Clogged detergent filter.	Use only detergent approved for use with pressure washer.
Detergent is not working. (For use of Foam Blaster.)	Detergent container is empty.	Add more detergent.
	Detergent bottle or suction tube not properly connected.	Check connections.
	Detergent is too thick.	Dilute detergent.
	Damaged or clogged detergent suction tube.	Remove obstruction or replace the detergent suction tube.
	The discharge nozzle is obstructed.	Blow out or remove debris with a fine needle.
	Detergent ON/OFF knob at OFF position	Set to ON position.
The trigger can't be squeezed.	Safety lock is not open.	Open the safety lock. Refer to the instruction manual.
High pressure hose can't be connected to pump or gun.	The O-rings are not lubricated.	Put lubricating oil or water on the O-rings.

IF YOU ENCOUNTER ANY ADDITIONAL DIFFICULTIES NOT LISTED, VISIT OUR WEBSITE AT

www.simoniz.ca

OR CALL CUSTOMER SERVICE FOR HELP AT

1-866-474-6664

Warranty

11. Warranty

Always keep your receipt as proof of purchase.

We're here to help! If you have any questions or comments, call our toll-free hotline 1-866-474-6664. Have your serial number ready. The serial number can be found on the back plate, located on the side of the unit.

This product has a Parts Replacement, Product Exchange and/or Repair Warranty only. **NO REFUNDS** will be provided. Please see stores for Product Exchange details.

Two (2) Year Warranty — Motor

This product is guaranteed to be free from defects in material and workmanship for two (2) years from the date of its original purchase. If such a defect appears during the warranty period, upon presentation of proof of purchase, Trileaf Distribution will repair or replace the product (at its discretion). Shipping charges may apply.

Ninety (90) Day Warranty — Accessories

Trigger gun, hose, spray wands and other accessories are guaranteed for ninety (90) days from the date of purchase. You may purchase accessories directly through place of purchase, or by calling our toll-free hotline 1-866-474-6664.

This warranty does not cover accidental damage, unreasonable use, normal wear and tear, use of improper detergents, freezing, neglect, or non-compliance with the Operating Instructions. The warranty does not cover loss of use or other consequential damages arising from any of the above, nor does it cover repairs made or attempted by unauthorized persons.

The warranty is void if the equipment is used for commercial, rental or industrial purposes.

If you have further questions, please visit our website (www.simoniz.ca) or call 1-866-474-6664.

Made in China

**Imported by
Trileaf Distribution Trifeuil, Toronto, Canada M4S 2B8**

Icons Definitions

12. Icon Definitions



Hearing Protection

To protect hearing from the device noise, wear hearing protection while operating the device.



This Way Up

When handling product, arrows must always point up.



Store Indoors

To avoid damage from freezing, store indoors in a place that does not reach freezing temperature.



Stacking Limitation

Shows maximum stacking height, in units.



Risk of Electric Shock

Do not direct the water flow at the device itself.



Keep Dry

Protect from excessive humidity when handling and storing.



Risk of Injury

Do not use the device in rain to avoid fatal electric shock.



Risk of Injury

Do not direct the water flow at people to avoid serious injury.



Risk of Electric Shock

Never spray water towards any electric devices.

Notes

Notes

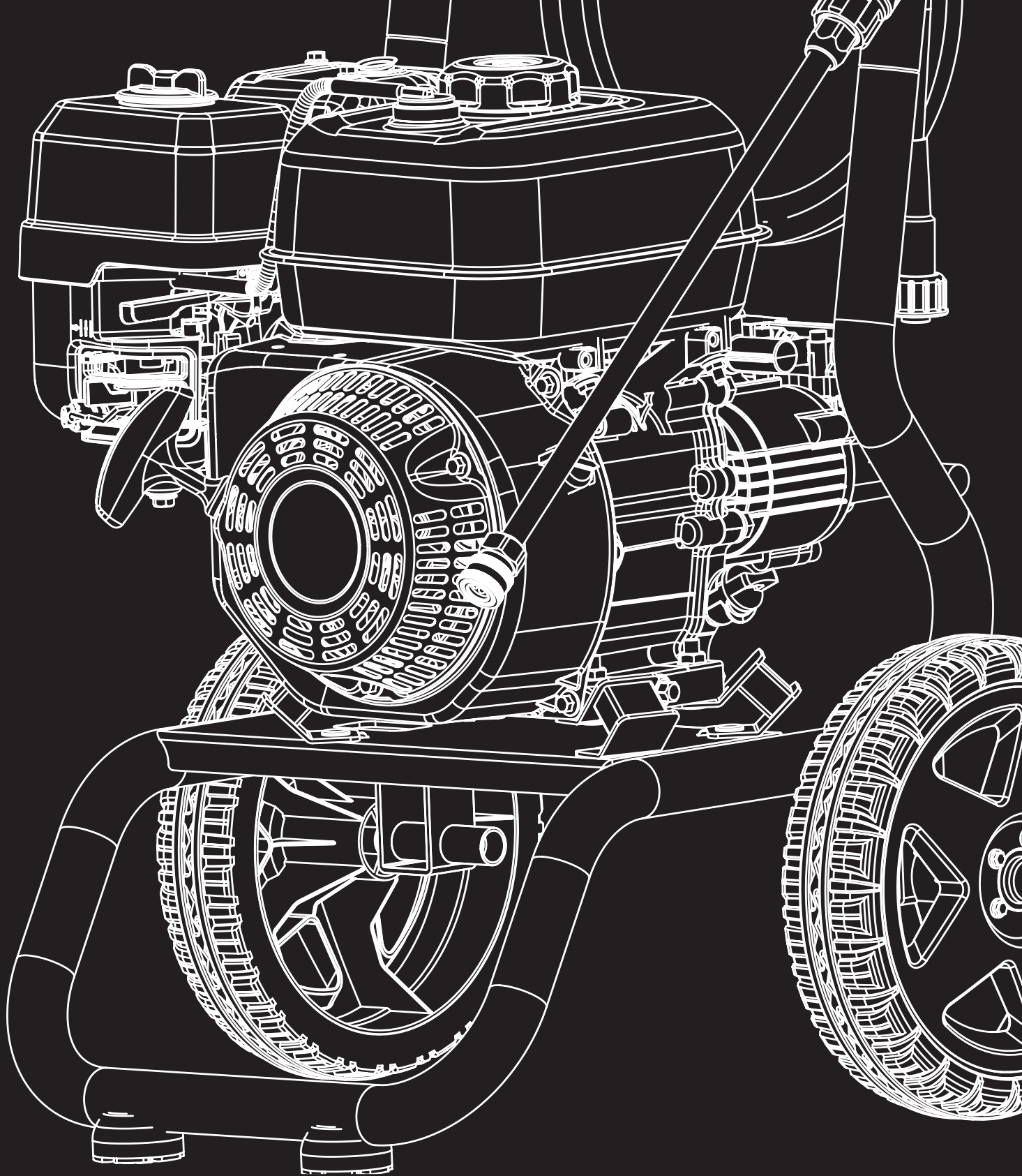

SIMONIZ®

3000 PSI / 2.4 GPM
PRESSURE WASHER

MODEL: XG06 / 039-8088-4

 **IMPORTANT SAFETY INSTRUCTIONS:
SAVE THESE INSTRUCTIONS**

Imported by
Trileaf Distribution Trifeuil, Toronto, Canada M4S 2B8